



HOLLAND PARK, W11

£995,000

Spacious reception room
Large double bedroom
Communal garden
Large kitchen
Second floor
Prime location

@marshandparsons
marshandparsons.co.uk

MARSH &
PARSONS



ABOUT THE PROPERTY

A beautifully presented one-bedroom apartment located on the highly desirable Holland Park. Set on the second floor of an elegant period building.

Holland Park is one of West London's most prestigious neighbourhoods, celebrated for its leafy streets, elegant architecture, and village-like charm. Residents enjoy a tranquil atmosphere within easy reach of Kensington High Street's boutiques, cafés, and restaurants, as well as the vibrant character of nearby Notting Hill. Excellent transport links via Holland Park Underground Station provide swift access across the city.



STEP INSIDE HOLLAND PARK

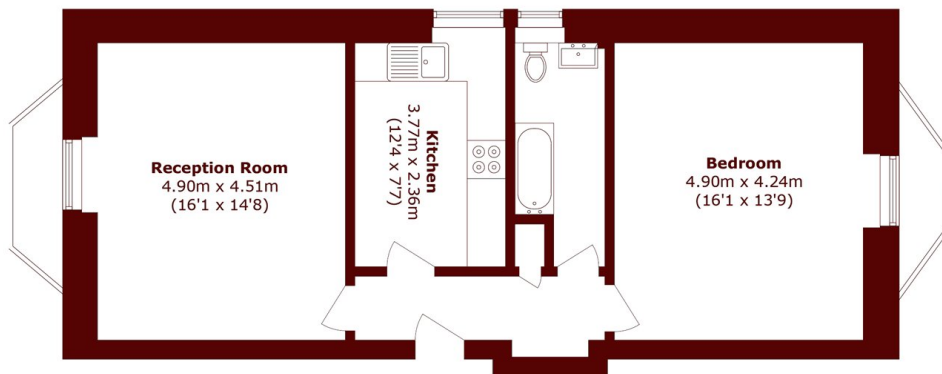

Total area (approx.): 61.3 sq. m (659.8 sq. ft)

Holland Park
020 7605 6890

Energy Rating: D We aim to make our particulars both accurate and reliable. However, they are not guaranteed; nor do they form part of an offer or contract. If you require clarification on any points then please contact us, especially if you're traveling some distance to view. Please note that appliances and heating systems have not been tested and therefore no warranties can be given as to their good working order

**MARSH &
PARSONS**