



Prideaux Road, SW9

£650,000

A beautifully refurbished, well presented two double bedroom garden flat. The property benefits from a private garden, utility room and period features throughout.

Prideaux Road offers easy access to the many shops, restaurants and bars of Clapham High Street and Clapham Old Town, both Clapham North & Stockwell Stations are just around the corner.

Features

- Fully Refurbished
- Two Double Bedrooms
- Utility Room
- Private Garden
- Chain Free

Prideaux Road, London, SW9

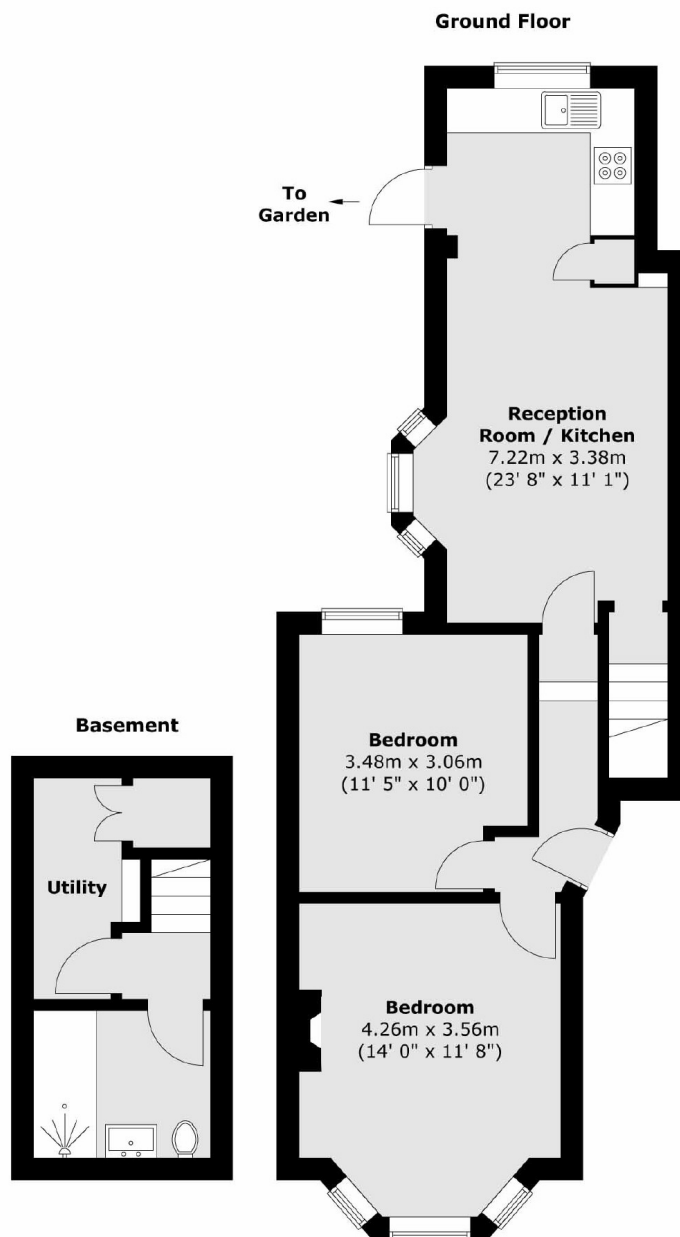

Total area (approx.) : 64.5 sq. m (694 sq. ft)