

Mulburries



Chelsing Rise , Hemel Hempstead, HP2 4PU

Guide price £725,000



## Chelsing Rise, Hemel Hempstead, HP2 4PU

- Substantial family home offering approx. 2,081 sq. ft.
- Highly desirable residential setting in HP2
- Impressive open-plan kitchen/breakfast/dining room
- Stylish fitted kitchen with central island and garden access
- Separate utility room and ground floor WC
- Two elegant reception rooms offering flexible living space
- Principal bedroom with walk-in wardrobe
- Three further well-presented bedrooms
- Contemporary family bathroom, an additional en suite, plus excellent storage
- Attractive rear garden with patio/decking, lawn and garden room/outbuilding



Mulburries present this outstanding family home of real scale and style, positioned in a sought-after residential setting and offering approximately 2,081 sq. ft. of beautifully presented accommodation arranged over two floors.

From the moment you enter, the sense of space is immediate. The ground floor has been designed for family life and entertaining, with an impressive open-plan kitchen/breakfast/dining room forming the heart of the home. This bright, contemporary space features sleek fitted cabinetry, a central island, generous dining area and direct access to the garden, creating a natural flow for modern living. A separate utility room adds excellent practicality.

Two elegant reception rooms provide further flexibility, ideal for formal entertaining, relaxed evenings, a playroom or a home office, while a



well-appointed ground floor WC completes the layout.

The first floor continues the premium feel, with a superb principal bedroom enjoying its own walk-in wardrobe. A spacious second bedroom with an ensuite shower room, plus two further bedrooms are well presented and served by a stylish family bathroom, creating an excellent arrangement for growing families, guests or those needing dedicated workspace.

Outside, the rear garden is a particular highlight, offering a generous lawn, seating areas for al fresco dining and a useful garden room/outbuilding. To the front, the property benefits from off-street parking and an attractive, well-kept frontage.

This is a substantial, turn-key home combining space, style and practicality in one of Hemel Hempstead's established residential locations.

Area Guide: Chelsing Rise is conveniently placed for local shops, schools, green spaces and everyday amenities, with Hemel Hempstead town centre offering a wide choice of restaurants, leisure facilities and retail. Hemel Hempstead station provides rail links into London, while the M1 and M25 are easily accessible, making the location ideal for commuters and families alike.

## Floor Plan

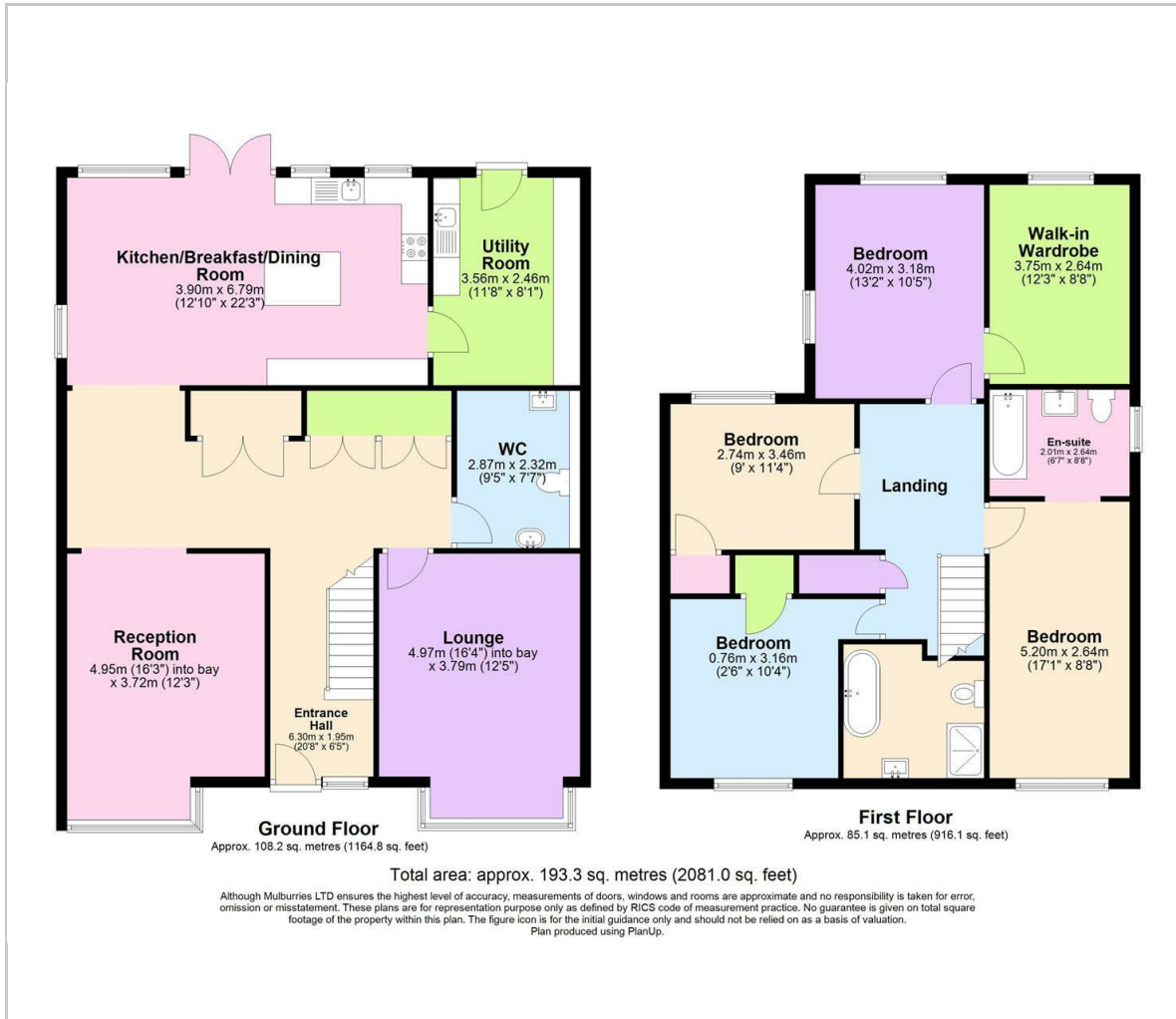

## Viewing

Please contact our Mulburries Office on 01442 732362 if you wish to arrange a viewing appointment for this property or require further information.

These particulars, whilst believed to be accurate are set out as a general outline only for guidance and do not constitute any part of an offer or contract. Intending purchasers should not rely on them as statements of representation of fact, but must satisfy themselves by inspection or otherwise as to their accuracy. No person in this firm's employment has the authority to make or give any representation or warranty in respect of the property.

31 Lawn Lane, Hemel Hempstead, Hertfordshire, HP3 9HH  
Tel: 01442 732362 Email: contact@mulburries.co.uk ryan.green@mulburries.co.uk

## Area Map

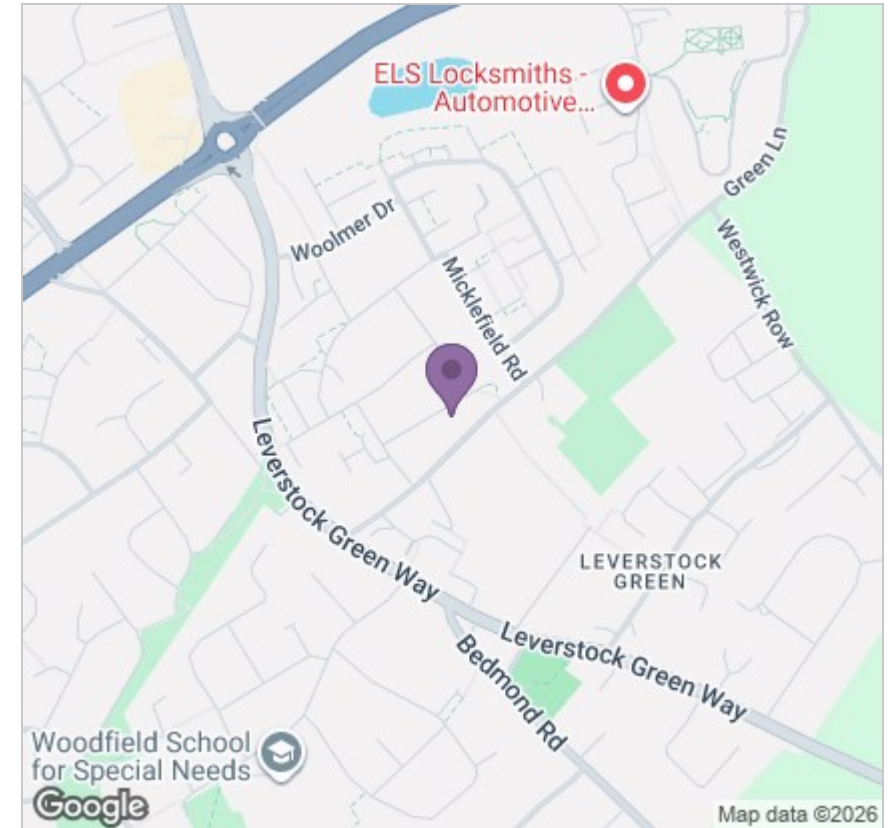

## Energy Efficiency Graph

