



**Connells**

Acacia Drive  
Hersden Canterbury





### Property Description

Offered to the market with no onward chain, this two bedroom mid terrace house is set in a no through road in a popular residential location.

The home comprises a spacious living room, kitchen and downstairs cloakroom. There are double doors from the living room overlooking the rear garden with a raised decking area, lawn and gated rear access.

To the first floor, there are two double bedrooms, both with built in wardrobe space in each room. There is a family bathroom with a matching suite including bath with shower over WC and wash hand basin.

The home also benefits two allocated parking spaces to the front of the property and is within close distance of local amenities and road networks leading to Canterbury and Thanet.



## Entrance Hall

Front door, laminate flooring

## Cloakroom

WC and wash hand basin

## Lounge

16' 1" x 11' 11" ( 4.90m x 3.63m )

Laminate flooring, double doors, two radiators, stairs to first floor

## Kitchen

8' 6" Max x 8' 1" Max ( 2.59m Max x 2.46m Max )

Fitted kitchen, matching wall and base units, work surface over, one and half sink and drainer, central heating boiler. Space and plumbing for washing machine and space for fridge freezer. Window

## Landing

Carpet, loft hatch

## Bedroom One

11' 1" Max x 9' 10" Max ( 3.38m Max x 3.00m Max )

Carpet, window, radiator, built in wardrobe space

## Bedroom Two

11' 3" x 8' 10" ( 3.43m x 2.69m )

Window, carpet, radiator, built in wardrobe

## Bathroom

Bath with shower over, WC, wash hand basin, part tiled, window.













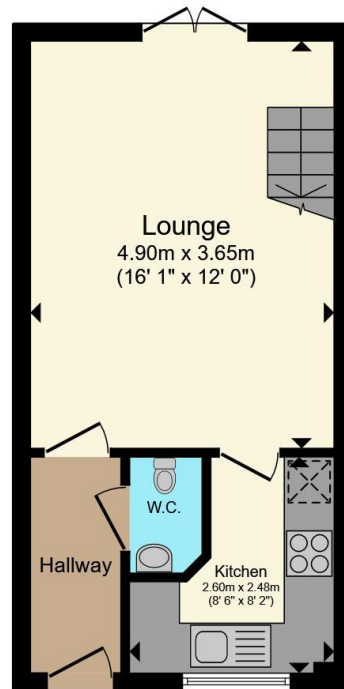

**Ground Floor**

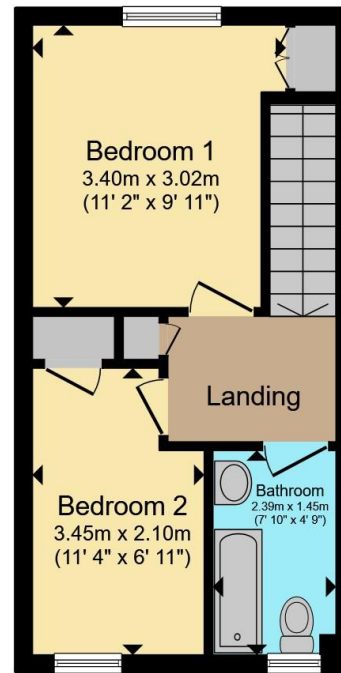

**First Floor**

Total floor area 55.4 m<sup>2</sup> (596 sq.ft.) approx

This floor plan is for illustrative purposes only. It is not drawn to scale. Any measurements, floor areas (including any total floor area), openings and orientation are approximate. No details are guaranteed, they cannot be relied upon for any purpose and they do not form part of any agreement. No liability is taken for any error, omission or misstatement. A party must rely upon its own inspection(s). Powered by [www.propertybox.io](http://www.propertybox.io)



To view this property please contact Connells on

**T 01227 764 720**  
**E [canterbury@connells.co.uk](mailto:canterbury@connells.co.uk)**

29-30 Watling Street  
 CANTERBURY CT1 2UD

EPC Rating: C Council Tax  
 Band: B

Tenure: Freehold

**view this property online [connells.co.uk/Property/CBY406867](http://connells.co.uk/Property/CBY406867)**



1. MONEY LAUNDERING REGULATIONS Intending purchasers will be asked to produce identification documentation at a later stage and we would ask for your co-operation in order that there will be no delay in agreeing the sale. 2. These particulars do not constitute part or all of an offer or contract. 3. The measurements indicated are supplied for guidance only and as such must be considered incorrect. Potential buyers are advised to recheck measurements before committing to any expense. 4. We have not tested any apparatus, equipment, fixtures, fittings or services and it is in the buyers interest to check the working condition of any appliances.

Connells Residential is registered in England and Wales under company number 1489613, Registered Office is Cumbria House, 16-20 Hockliffe Street, Leighton Buzzard, Bedfordshire, LU7 1GN. VAT Registration Number is 500 2481 05.

**See all our properties at [www.connells.co.uk](http://www.connells.co.uk) | [www.rightmove.co.uk](http://www.rightmove.co.uk) | [www.zoopla.co.uk](http://www.zoopla.co.uk)**

Property Ref: CBY406867 - 0003