



Chapman Avenue, Maidstone, , ME15 8EJ

Price £300,000



**NO FORWARD CHAIN** - Located in a quiet cul-de-sac close to the stunning surroundings of Mote Park and the highly sought-after village of Bearsted, this beautifully presented three-bedroom home is an ideal purchase for first-time buyers, growing families, or those looking to simply move straight in and enjoy.

The property is approached via a pathway set back from the road, creating a pleasant sense of privacy. Upon entering, you are welcomed by an entrance porch which leads through into the main hallway, offering access to the ground floor accommodation. To the front of the home is a bright and airy, well-appointed kitchen, while to the rear you will find a spacious sitting room with feature fireplace and a conservatory, providing additional versatile living space.

Upstairs offers three well-proportioned bedrooms, each offering comfortable accommodation and flexibility for a variety of needs, whether as bedrooms, a home office, or nursery space, all served by a family bathroom.

Externally, the property benefits from both front and rear gardens and is pleasantly tucked away from passing traffic. The rear garden features a sunny decked seating area, ideal for relaxing or entertaining. The home also comes with a convenient garage en bloc. Council Tax Band: C. EPC rating: C.

\*Some photographs have been virtually staged



## LOCATION

The property is conveniently located within walking distance of local shops, schools and bus service to Maidstone town centre, which is approximately 3-miles away. The nearby village of Bearsted boasts a fabulous Village Green with a selection of excellent pubs and restaurants and offers convenient transport links via a mainline train station, whilst access to the M2 & M20 motorways are within a short drive. Close by leisure facilities include Bearsted golf, bowls and tennis clubs, as well as Mote Park Leisure Centre.

## ACCOMMODATION

### GROUND FLOOR:

Porch

Hall

Kitchen

Sitting room

Conservatory

### FIRST FLOOR:

Principal bedroom

Bedroom 2

Bedroom 3

**Bathroom**

### EXTERNALLY:

**Garage-en-bloc**

**Rear garden**

### VIEWINGS

Strictly by arrangement with the Agent's Bearsted Office, 132 Ashford Road, Bearsted, Maidstone, Kent ME14 4LX. Tel: 01622 739574.

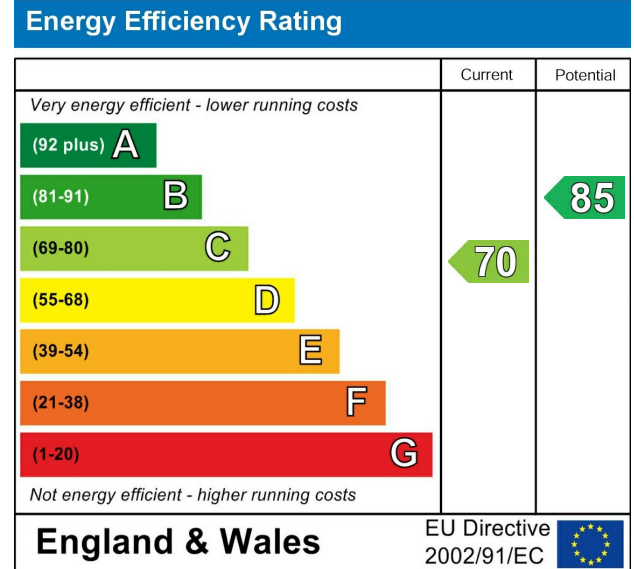

Page & Wells limited for themselves and for the vendors of this property whose agents they are give notice that: 1. These particulars do not constitute any part of, an offer or a contract. 2. All statements contained in these particulars as to this property are made without responsibility on the part of Page & Wells Limited or the Vendor. 3. None of the statements contained in these particulars as to the property is to be relied on as statements or representations of fact. 4. Any intending purchaser must satisfy himself by inspection or otherwise as to the correctness of each of the statements contained in these particulars. 5. The vendor does not make or give, and neither Page & Wells Limited nor any person in their employment has any authority to make or give any representation whatsoever in relation to this property. These particulars are supplied on the understanding that all negotiations are carried out throughout Page & Wells Limited. Properties with a reference prefixes EAA are those which Page & Wells Limited disclose an interest in accordance with the provisions of the Estates Agents Act 1979

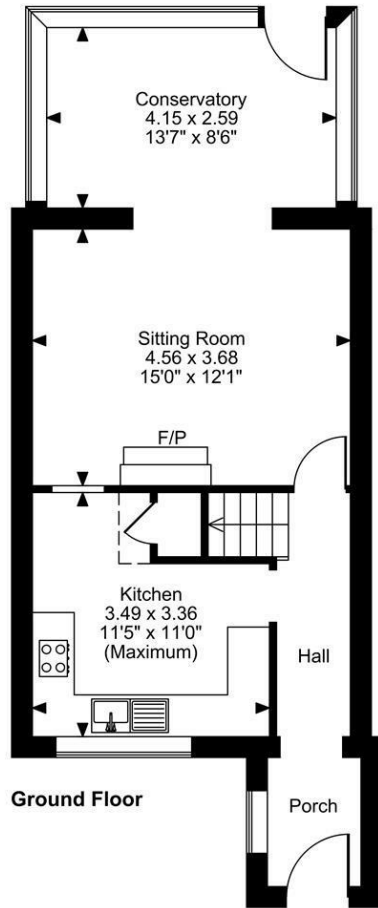

**Chapman Avenue, Maidstone**  
**Approximate Gross Internal Area**  
**Main House = 862 Sq Ft/80 Sq M**  
**Garage = 131 Sq Ft/12 Sq M**  
**Total = 993 Sq Ft/92 Sq M**

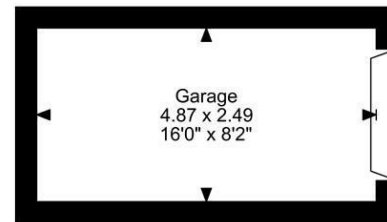
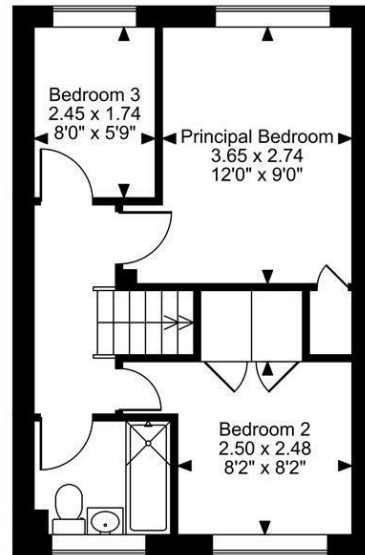
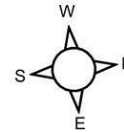

**FOR ILLUSTRATIVE PURPOSES ONLY - NOT TO SCALE**

The position & size of doors, windows, appliances and other features are approximate only.

© ehouse. Unauthorised reproduction prohibited. Drawing ref. dig/8690735/SAP

