



## St. Johns Road, TW7

£259,950

A one double bedroom apartment, presented in fantastic condition and with no onward chain. Benefits include communal gardens, long lease and low service charges, communal gardens and secure bike storage.

Wotton House is superbly positioned in the heart of Isleworth close to Isleworth Train Station, local parks and amenities. St Margarets and Richmond are a pleasant walk away or short bus journey.

### Features

- Chain Free
- Bicycle Storage
- Great Condition
- No Onward Chain
- Communal Gardens
- Gated Development

St. Johns Road,  
Isleworth, TW7

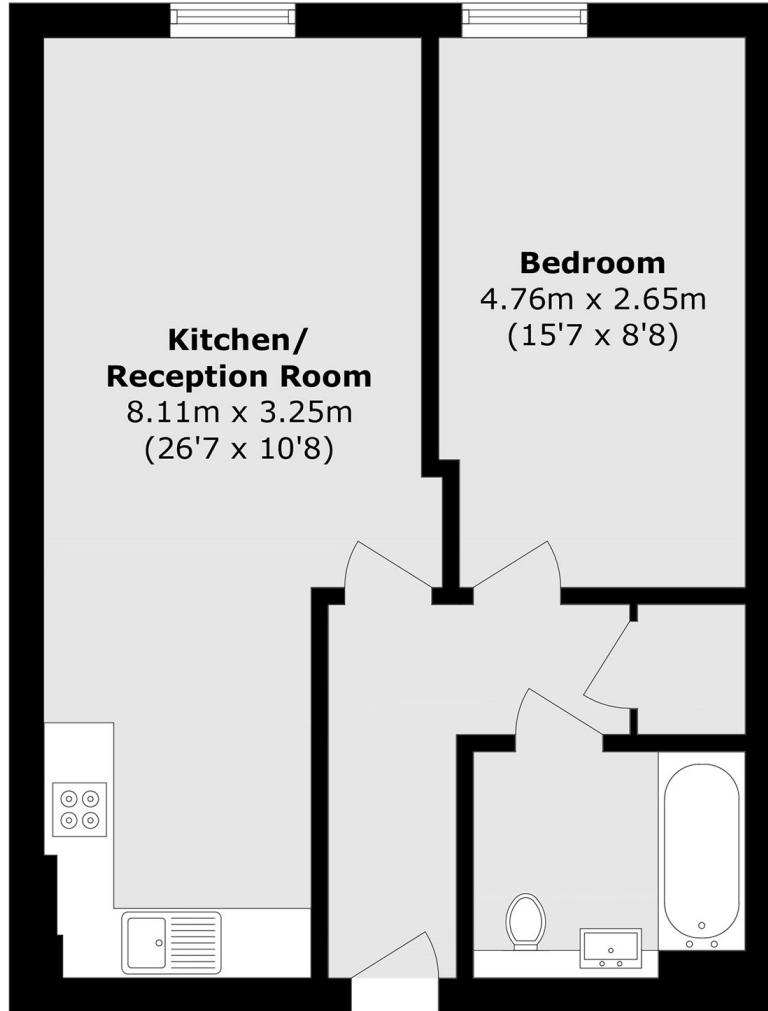

Total area (approx.): 48.9 sq. m (526.3 sq. ft)