



7 Routley Court

Higher Lux Street, Liskeard, Cornwall, PL14 3FA

KIVELLS

7 Routley Court

Higher Lux Street, Liskeard, Cornwall, PL14 3FA

Guide Price £120,000—£130,000

Well presented first floor two bedroom apartment

Communal gardens and an allocated parking spot

Situated within walking distance to the town centre, local amenities & transport links

For sale with the benefit of no onward chain



Description

A fantastic opportunity to acquire this well-presented two-bedroom first-floor flat, conveniently located within walking distance of Liskeard town centre. Perfect as a first-time buy or investment property, the flat offers spacious accommodation throughout and is ready to move in.

The property comprises a welcoming entrance hall, a generous living room, and a modern kitchen. Both bedrooms are comfortable doubles, and there is a practical bathroom.

Additional benefits include communal gardens, providing a peaceful outdoor space, and a dedicated parking space.

This property is ideally situated for access to all local amenities, shops, and transport links, offering the perfect combination of convenience and comfort.



Accommodation

Entrance via uPVC door with obscure glazed panelling leading in to:-

Hallway

Doors off to all rooms, radiator.

Kitchen

uPVC double glazed window to the front elevation, a range of fitted wall and base units with roll top work surfaces over incorporating a one and a half bowl stainless steel sink and drainer with mixer tap, under counter space and plumbing for washing machine, built-in oven with four ring electric hob and extractor fan over, space for freestanding fridge freezer, radiator, LED downlights.

Living Room

uPVC double glazed window to the side elevation, radiator, television point.

Bedroom

uPVC double glazed window to the side elevation, radiator.

Bathroom

Obscure uPVC double glazed window to the side elevation, bath with panelled surround and mixer tap having mixer shower over and glazed shower screen being tiled floor to ceiling, low-level W.C, chrome heated towel radiator, wash hand basin with mixer tap and vanity storage below.

Bedroom

uPVC double glazed window to the side elevation, radiator.



Floor Plan

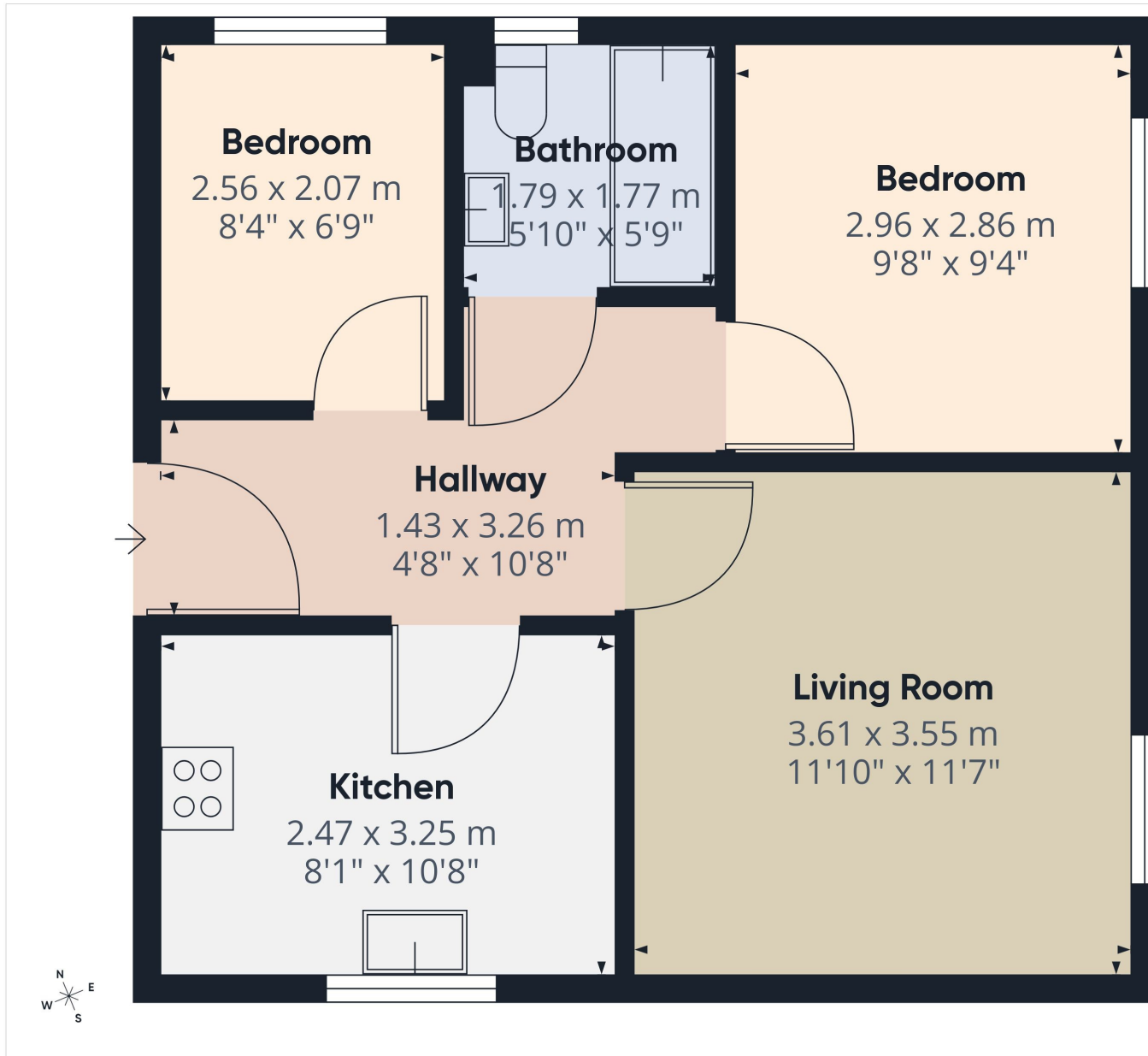

Approximate total area⁽¹⁾
 44.3 m²
 476 ft²

(1) Excluding balconies and terraces

Calculations reference the RICS IPMS 3C standard. Measurements are approximate and not to scale. This floor plan is intended for illustration only.

GIRAFFE360

Outside

The property enjoys communal gardens, providing a pleasant outdoor space for residents

There is also the added benefit of one allocated parking space for added convenience.



Services

Mains electricity, water & drainage.

 EE Rating - C

 Council Tax Band - A

 Directions

What3Words - [cuter.brownish.give](https://www.what3words.com/cuter.brownish.give)

 Virtual Tour

<https://tour.giraffe360.com/5f5365609a874844bbc35cea5505b7ff>

Scan for Material Information



Viewings strictly by appointment only

Please ring **01579 345543** to view this property and check availability before incurring travel time/costs. Full details of all our properties are available on our website www.kivells.com.

Disclaimer

Kivells, their clients, and any joint agents give notice that they are not authorised to make or give any representations or warranties in relation to the property either here or elsewhere, either on their own behalf or on behalf of their client or otherwise. They assume no responsibility for any statement that may be made in these particulars. These particulars do not form part of any offer or contract and must not be relied upon as statements or representations of fact. Any areas, boundaries, measurements, or distances are approximate. The text, photographs, CGI's, and plans are for guidance only and are not necessarily comprehensive. It should not be assumed that the property has all necessary planning, building regulation, or other consents, and Kivells have not tested any services, equipment, or facilities. The property is sold subject to all matters in the Property and Charges Register, including rights of way, wayleaves, and easements. Purchasers are deemed to know all boundaries; neither the vendor nor agents will define them. Boundary disputes will be decided by the vendor's agent. Nothing in these particulars constitutes financial advice. Seek your own financial advice. Using Mortgage Genies SW Ltd. services will result in a referral fee of £250 + VAT to Kivells. Kivells retains copyright to all sales particulars, photographs, floor plans, sketches, and advertisements.



KIVELLS

Kivells Estate Agents, 7-8 Bay Tree Hill, Liskeard, Cornwall, PL14 4BE

📞 01579 345 543

✉ liskeard@kivells.com

🌐 kivells.com

Find us on [f](#) [x](#) [@](#) [v](#) [in](#)