



Potter Hill Lane, High Green, Sheffield, S35 4JE

Guide Price £240,000

🛏️ 3 🚿 1 🚗 1



Guide Price of £240,000 - £250,000

Offered to the market with no onward chain is this beautifully renovated three bedroom property, finished to a high standard throughout and ready for immediate occupation.

The current owners have carried out a comprehensive renovation from top to bottom, creating a stylish and modern home that is sure to impress buyers looking for something move-in ready. The ground floor features a bright and comfortable living room to the front aspect, while to the rear is an impressive kitchen/dining room providing a fantastic entertaining and family space, complemented by a downstairs WC.

To the first floor are three bedrooms alongside a modern family bathroom, with the overall finish throughout the property being both tasteful and contemporary.

Externally, the property benefits from generous gardens to both the front and rear, offering excellent outdoor space. There is also off road parking for multiple vehicles along with a detached garage, adding further practicality.

Situated in this popular residential area of High Green with excellent access to local amenities, schools and transport links, this is a fantastic opportunity to acquire a fully renovated home with no work required.

Summery

Morfittsmith Momentum Property

Full Description

MOMENTUM - A SMARTER WAY TO BUY AND SELL

This property is being marketed with Momentum, our enhanced sales process designed to get transactions moving faster, with fewer surprises and greater confidence for everyone involved



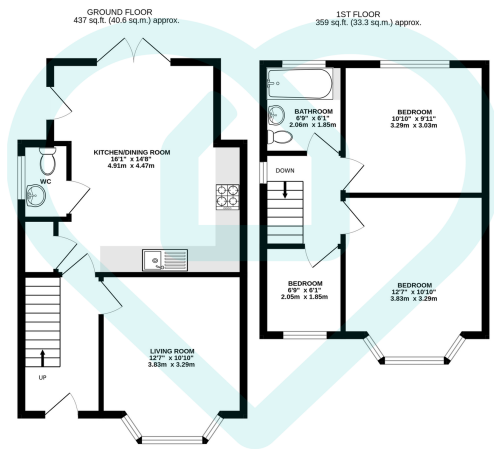

TOTAL FLOOR AREA : 796 sq.ft. (73.9 sq.m.) approx.

This floor plan is for illustrative purposes only. All measurements and layouts are approximations and do not necessarily capture the precise specifications of the property. No responsibility is taken for any error, omission, or misstatement. We always recommend viewing in person to confirm the exact floor plan of a property. Made with Metropix.



- Fully renovated throughout to a high standard
- Offered to the market with no onward chain
- Spacious kitchen/dining room ideal for entertaining
- Modern family bathroom
- Off road parking for multiple vehicles
- Three bedroom property in a popular High Green location
- Stylish and modern finish throughout
- Downstairs WC for added convenience
- Large front and rear gardens
- Detached garage providing additional storage

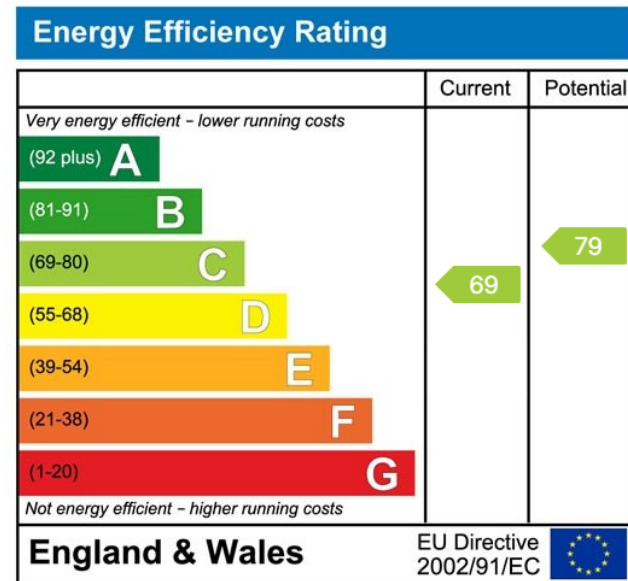
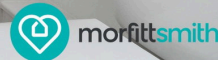
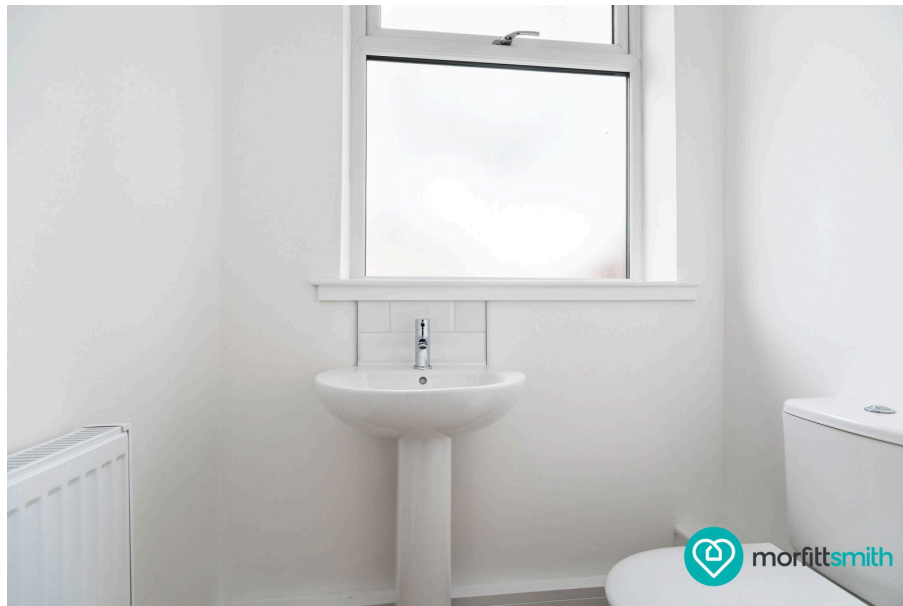

Sales | Lettings | New Homes

VAT Reg Number: 191 3588 84
 Company Reg Number: 08610489
 Company Reg Address: 67 Middlewood Road, Hillsborough, Sheffield, S6 4GX.

The MorfittSmith Building
 67 Middlewood Road
 Hillsborough
 Sheffield
 S6 4GX

Get in touch - arrange an appointment



0114 232 1764



sales@morfittsmith.co.uk
 lettings@morfittsmith.co.uk
 newhomes@morfittsmith.co.uk



www.morfittsmith.co.uk



@MorfittSmith



@MorfittSmith



MorfittSmith
 Estate & Letting Agent