



**1 Bed  
House - Mid Terrace  
located in**



# Room 2, 7 Forest Road Fishponds BS16 3XH



## £750 Per month

Large En suite Room ! £750 All Bills Included

We are pleased to present this premium six-bedroom home designed for professionals only. Designed with comfort and ease in mind. The room comes fully furnished with Bed, Wardrobe, Chest of Drawers and Desk, along with plenty of storage space!

Located just 0.4 miles from the main bus routes, with the city centre and all other major routes within easy reach, this house is perfectly placed. Fishponds High Street, with its mix of shops, supermarkets, bars, and eateries, is only a short walk away.

All rooms in the house have their own bathrooms so there is no morning rush to get ready for work! The house also benefits from a large garden with furniture, perfect for a sunny afternoon !

Key Features  
Six bedrooms  
All with ensuite bathrooms  
Premium finish  
Excellent Fishponds location  
Major Bus Routes 0.2 miles away  
Close to shops, cafes, and eateries



GROUND FLOOR  
535 sq.ft. (49.7 sq.m.) approx.

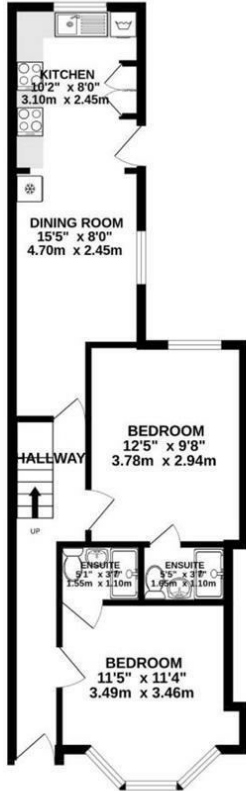

1ST FLOOR  
452 sq.ft. (42.0 sq.m.) approx.



2ND FLOOR  
291 sq.ft. (27.1 sq.m.) approx.

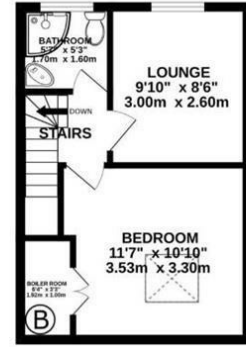

TOTAL FLOOR AREA: 1279 sq.ft. (118.8 sq.m.) approx.

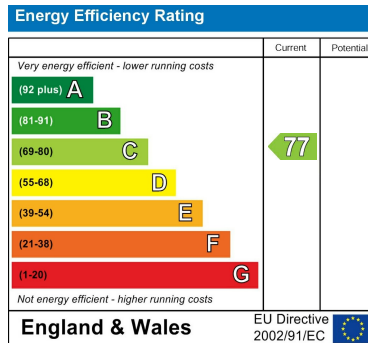

DIRECTIONS

CONTACT

Shore House Westbury Hill  
Westbury-on Trym, Bristol  
BS9 3AA

E: [elliott.sherwood@frontdoorlettings.co.uk](mailto:elliott.sherwood@frontdoorlettings.co.uk)

T: 0117 457 8577

[frontdoorlettings.co.uk](http://frontdoorlettings.co.uk)

