

Uckfield 01825 703000  
Crowborough 01892 489000  
Heathfield 01435 511800

Peter Oliver



## Longbury, Uckfield, TN22 5DF

- Fully Refurbished and Upgraded Kitchen
- Five Spacious Bedrooms, Including En-Suites
- Quiet Cul-De-Sac Location
- Large, Versatile Living Areas
- Driveway & Double Garage
- Close to Shops, Station & Schools



### EPC RATING

Current:

64 | D

Potential:

75 | C

**£975,000**



## Longbury, Uckfield, TN22 5DF

This beautiful five-bedroom detached property has excellent space throughout and offers all the features any new buyers could want for in a family home. Set in a cul-de-sac down a private road in a central location, within walking distance of Uckfield College, a school that has an Ofsted rating of 'Outstanding'. The property offers the benefits of a convenient location without passing traffic so a peaceful existence is guaranteed. The ground floor accommodation is plentiful and comprises a porch, entrance hall, living room, family room, study, conservatory, kitchen/breakfast room and utility room. The bespoke hand-built kitchen is a particular highlight. This excellent family space also benefits from wooden flooring with underfloor heating, plenty of storage and worktop space and double doors to the pretty rear garden. There's lots of space here for a separate table and chairs and all this space is complemented further with the inclusion of a large conservatory. Upstairs space is just as impressive with five large bedrooms, a sizeable family bathroom and two en-suites. All rooms feel bright, spacious and are well-presented. To the front is a large driveway and double garage and the property is walking distance from the high street shops and railway station as well as several well regarded local Primary Schools. A wonderful family home; viewing is highly recommended.

Uckfield 01825 703000  
Crowborough 01892 489000  
Heathfield 01435 511800

Peter Oliver





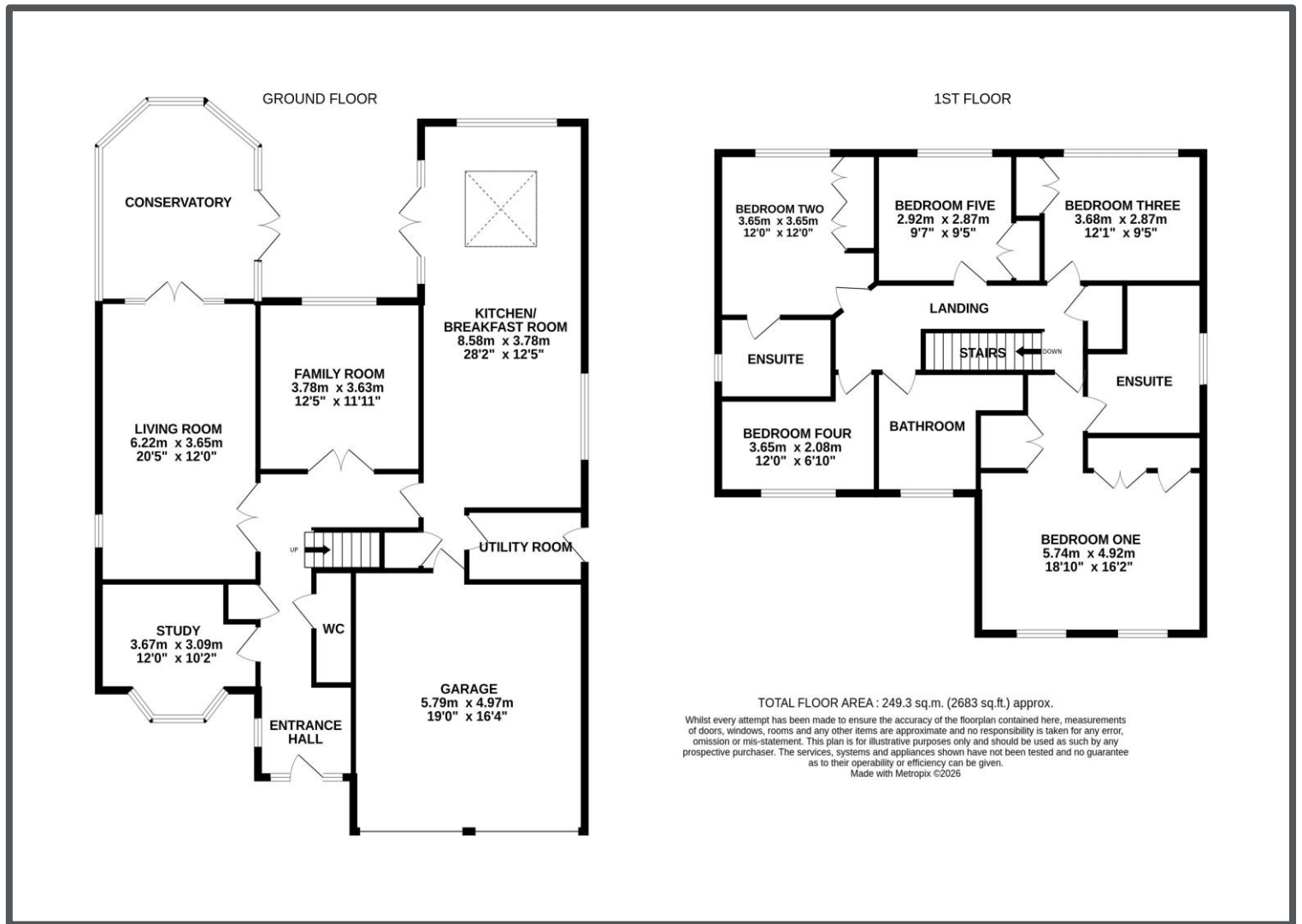

TENURE: FREEHOLD

COUNCIL TAX BAND: G

MAINTENANCE/SERVICE CHARGE: N/A

Uckfield 01825 703000  
 Crowborough 01892 489000  
 Heathfield 01435 511800  
[info@peteroliverhomes.co.uk](mailto:info@peteroliverhomes.co.uk)

Peter Oliver

The information provided about this property does not constitute or form part of an offer or contract, nor may it be regarded as representations. All interested parties must verify accuracy and your solicitor must verify tenure/lease information, fixtures & fittings and, where the property has been extended/converted, planning/building regulation consents. All dimensions are approximate and quoted for guidance only as are floor plans which are not to scale and their accuracy cannot be confirmed. Reference to appliances and/or services does not imply that they are necessarily in working order or fit for the purpose.