



Sigrist Square, KT2

£365,000

A two bedroom, top floor apartment in a sought after, low rise gated development, offering a spacious living room with wood flooring and a modern kitchen with granite work surfaces. The property further benefits from a share of freehold and includes residents' and guest parking, making it a practical home in a highly convenient and popular location.

Sigrist Square is an attractive, low rise gated development, conveniently located less than 200 yards from Kingston town centre and the mainline station. The development benefits from a share of freehold, a long underlying lease and affordable annual service charges.

Features

- Two Bedrooms
- Large Reception
- Gated Development
- 2nd (TOP) Floor
- Residents And Guest Parking
- Excellent Location

Sigrist Square, Kingston Upon Thames, KT2

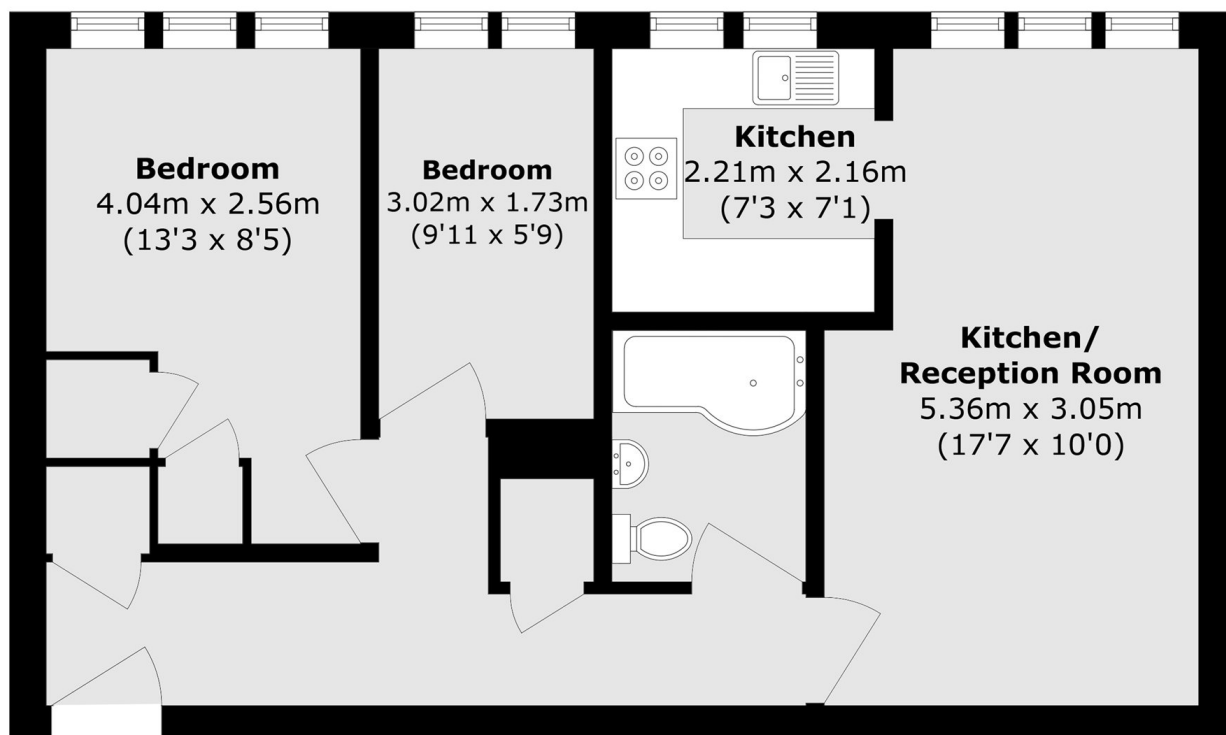

Total area (approx.): 50.3 sq. m (541.4 sq. ft)