



**£500,000**

**Station Parade, Boston Manor Road, Brentford, TW8**



- 1 Double Bedroom
- 736 Sq Ft New Build
- Share of Freehold
- Private Patio
- Communal Garden
- Excellent Transport Links

A stylish one-bedroom new-build apartment offering approximately 736 sq ft of contemporary living space, finished to a high standard throughout. The property boasts an impressive open-plan reception, dining and kitchen area with ample space for entertaining and direct access to a generous private patio, creating an excellent indoor-outdoor living experience. Set within an exclusive development of just nine apartments, this spacious double bedroom is well-proportioned and complemented by a sleek modern bathroom and a separate storage room, providing excellent practicality and convenience. Large windows throughout allow for plenty of natural light, enhancing the bright and airy feel of the apartment. Further benefits include Share of Freehold, lift access, secure bicycle storage, and access to a beautifully maintained communal garden. Ideally situated close to a range of local amenities, cafes and restaurants, the property also enjoys excellent transport links, including Brentford Station nearby. \*Furniture Images Are CGI



# Station Parade, TW8

Approximate Gross Internal Area  
68.37 sq m / 736 sq ft

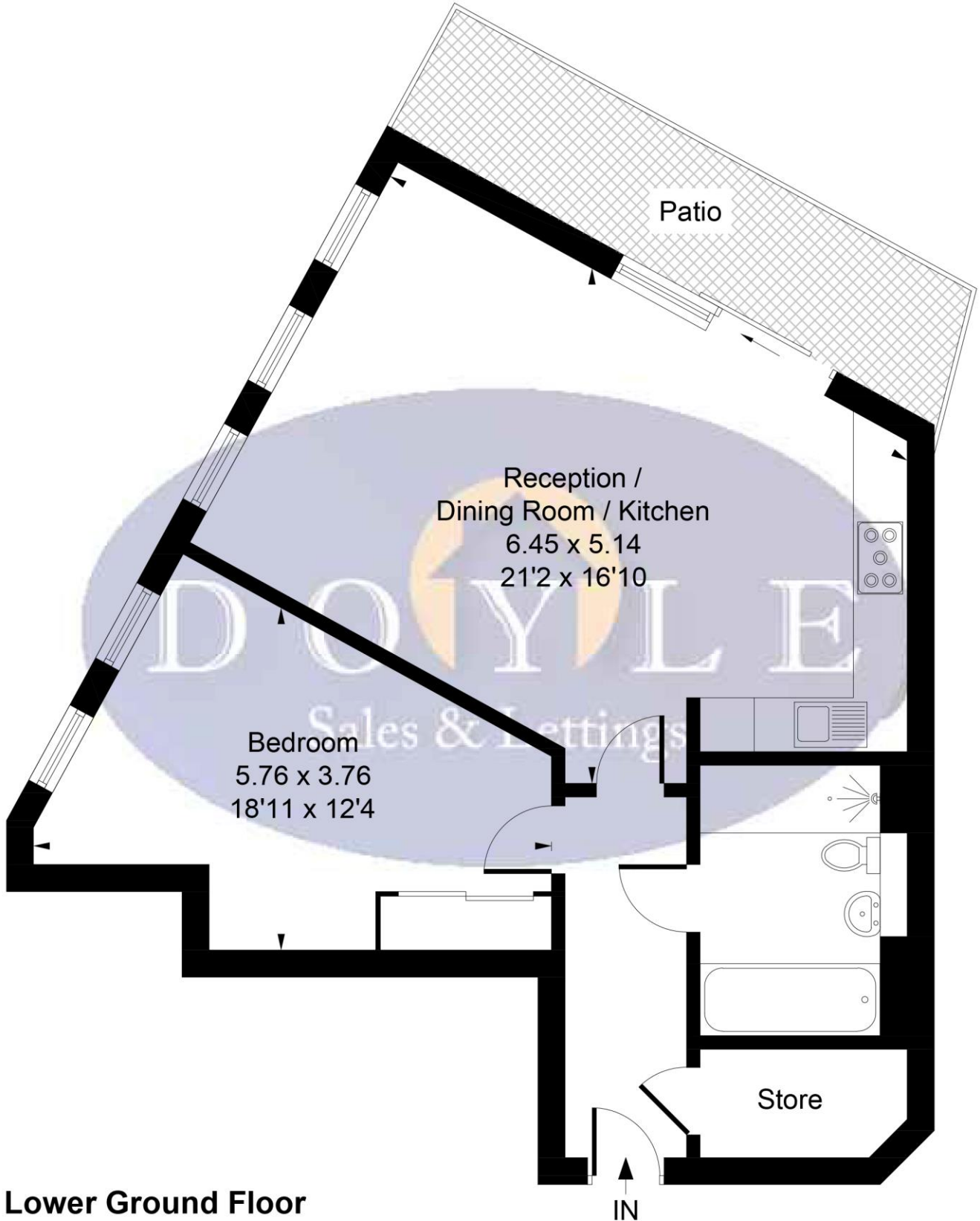

**Lower Ground Floor**  
**68.37 sq m / 736 sq ft**

Whilst every attempt has been made to ensure the accuracy of the floor plan contained here, measurements of doors, windows, rooms and any other items are approximate and no responsibility is taken for any error, omission, or mis-statement.

This plan is for illustrative purposes only and should be used as such by any prospective purchaser.

© Vizion Property Marketing Produced for Doyle Sales & Lettings

## Map



### VIEWING BY APPOINTMENT WITH AGENTS DOYLE SALES & LETTINGS

11 Broadway Buildings, Boston Rd, Hanwell, London, W7 3TT T: 020 8840 0171 E: [info@doylesalesandlettings.co.uk](mailto:info@doylesalesandlettings.co.uk) W: [www.doylesalesandlettings.co.uk](http://www.doylesalesandlettings.co.uk)

General: While we endeavour to make our sales particulars fair, accurate and reliable, they are only a general guide to the property and, accordingly, if there is any point which is of particular importance to you, please contact the office and we will be pleased to check the position for you, especially if you are contemplating travelling some distance to view the property.

Measurements: These approximate room sizes are only intended as general guidance. You must verify the dimensions carefully before ordering carpets or any built-in furniture.

Services: Please note we have not tested the services or any of the equipment or appliances in this property, accordingly we strongly advise prospective buyers to commission their own survey or service reports before finalizing their offer to purchase.

THESE PARTICULARS ARE ISSUED IN GOOD FAITH BUT DO NOT CONSTITUTE REPRESENTATIONS OF FACT OR FORM PART OF ANY OFFER OR CONTRACT. THE MATTERS REFERRED TO IN THESE PARTICULARS SHOULD BE INDEPENDENTLY VERIFIED BY PROSPECTIVE BUYERS OR TENANTS. NEITHER DOYLE SALES & LETTINGS NOR ANY OF ITS EMPLOYEES OR AGENTS HAS ANY AUTHORITY TO MAKE OR GIVE ANY REPRESENTATION OR WARRANTY WHATEVER IN RELATION TO THIS PROPERTY.

YOUR HOME IS AT RISK IF YOU DO NOT KEEP UP REPAYMENTS ON A MORTGAGE OR OTHER LOAN SECURED ON IT.

Written quotations available on request. All loans secured on property. Life assurance is usually required.

## EPC Rating A

