



WHERE STANDARDS MATTER

Spencer Munson
128 High Road
Loughton IG10 4BE

Tel: 020 8502 2222

loughton@spencermunson.co.uk
Website: spencermunson.co.uk



Landmark House, The Broadway, Loughton, IG10

Spencer Munson are pleased to offer you this two double bedroom apartment is situated on the 6th floor of The Landmark. The property comprises of a Large open plan lounge/kitchen with access to private balcony, two double bedrooms, one with built in wardrobe and a luxury fitted bathroom. The property also benefits a Lift, a Hive active heating system and allocated parking for one. Ideally located with The Broadway shops, Sainsbury's and the new Epping Forest Shopping Park as well as Debden Central Line Station. EPC Rating B. Council Tax C. Available 14th July 2026

Rent: £1,795 - Monthly



Landmark House, The Broadway, Loughton, IG10

Lounge

3.92m (12'10) x 4.96m (16'3)



Kitchen



Bedroom One

3.24m (10'8) x 3.18m (10'5)



Bedroom Two

2.7m (8'10) x 3.18m (10'5)



Bathroom

2.04m (6'8) x 1.69m (5'7)



Exterior



Balcony



EPC Rating B

Energy Efficiency Rating		
	Current	Potential
Very energy efficient - lower running costs		
92-100 A		
81-91 B	83	83
69-80 C		
55-68 D		
39-54 E		
21-38 F		
1-20 G		
Not energy efficient - higher running costs		
July 2026 England & Wales	EU Directive 2002/91/EC	

Spencer Munson are pleased to offer you this two double bedroom apartment is situated on the 6th floor of The Landmark. The property comprises of a Large open plan lounge/kitchen with access to private balcony, two double bedrooms, one with built in wardrobe and a luxury fitted bathroom. The property also benefits a Lift, a Hive active heating system and allocated parking for one. Ideally located with The Broadway shops, Sainsbury's and the new Epping Forest Shopping Park as well as Debden Central Line Station. EPC Rating B. Council Tax C. Available 14th

Landmark House, The Broadway, Loughton, IG10

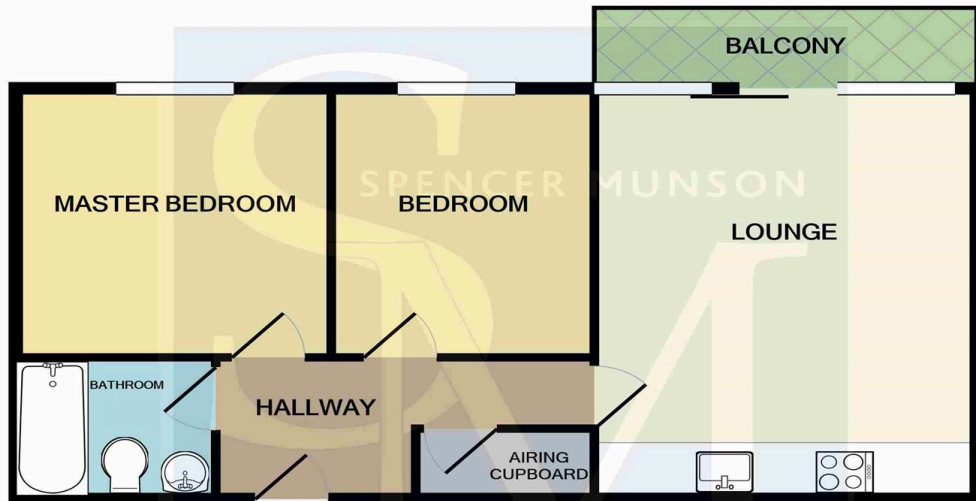

Whilst every attempt has been made to ensure the accuracy of the floor plan contained here, measurements of doors, windows, rooms and any other items are approximate and no responsibility is taken for any error, omission, or mis-statement. This plan is for illustrative purposes only and should be used as such by any prospective purchaser. The services, systems and appliances shown have not been tested and no guarantee as to their operability or efficiency can be given
Made with Metropix ©2021

Disclaimer

These particulars are intended to give a fair and substantially correct overall description for the guidance of intending tenants/purchasers and do not constitute an offer or part of a contract. Prospective tenants/purchasers and/or lessees should seek their own professional advice. All descriptions, dimensions, reference to condition, fixtures, fittings and necessary permissions for use and occupation and other details are given in good faith and are believed to be correct. However, intending tenants/purchasers should not rely on them as statements or representations of fact, but must satisfy themselves by inspection or otherwise as to the correctness of each of them. Fixtures and fittings shown in pictures and on viewings may well not be included in any tenancy/sale and any prospective tenant/purchaser must clarify this for themselves. All measurements and floorplans are approximate and produced as a guide in good faith. Please note that some of the furniture and decor items shown in these images have been digitally added using AI technology for illustrative purposes. The actual property may differ in appearance. Prospective buyers or renters are encouraged to visit the property in person to get an accurate representation.