



Nash Close, North Mymms

£250,000

FIRST FLOOR MAISONETTE • ONE BEDROOM • RECENTLY FITTED KITCHEN • NEW HEATING • RECENTLY INSTALLED BATHROOM • PRIVATE REAR GARDEN • DRIVEWAY • RECENTLY REFURBISHED THROUGHOUT • 953 YEARS LEFT ON LEASE • EPC RATING - TBC

KINGS
SALES LETTINGS MANAGEMENT



Ground Floor

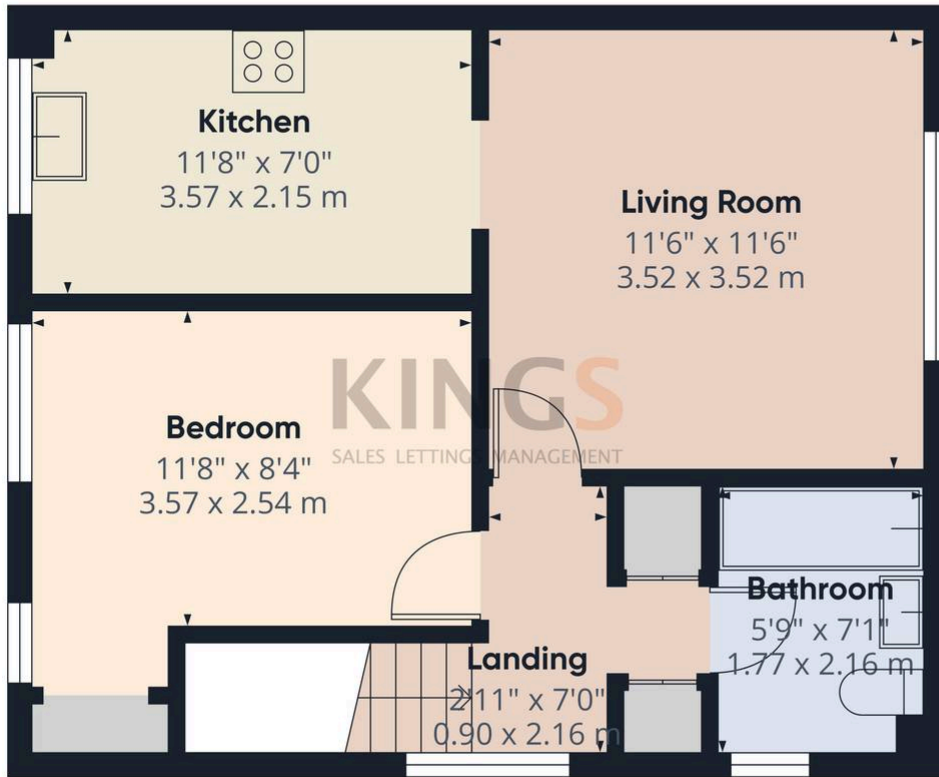

First Floor

Approximate total area⁽¹⁾
 444 ft²
 41.3 m²

(1) Excluding balconies and terraces

Calculations reference the RICS IPMS 3C standard. Measurements are approximate and not to scale. This floor plan is intended for illustration only.

