

HS HAIR & SON



Cranleigh Drive , Leigh-on-Sea SS9 1SY

- TOP FLOOR APARTMENT
- SECURE GATED CAR PARK (FIRST COME FIRST SERVE BASIS)
- LARGE ENTRANCE HALL WITH VIDEO ENTRY PHONE INTERCOM SYSTEM
- PRIME LEIGH-ON-SEA LOCATION
- TWO BEDROOMS
- COMMUNAL FACILITIES INCLUDING ROOFTOP GARDENS, COMMUNAL LOUNGES AND GUEST SUITES
- ON SITE MANAGER
- BEAUTIFULLY PRESENTED RETIREMENT FLAT

Guide Price £300,000 Leasehold

Local Authority **Southend on Sea Borough Council**
Council Tax Band **E**
EPC Rating **B**

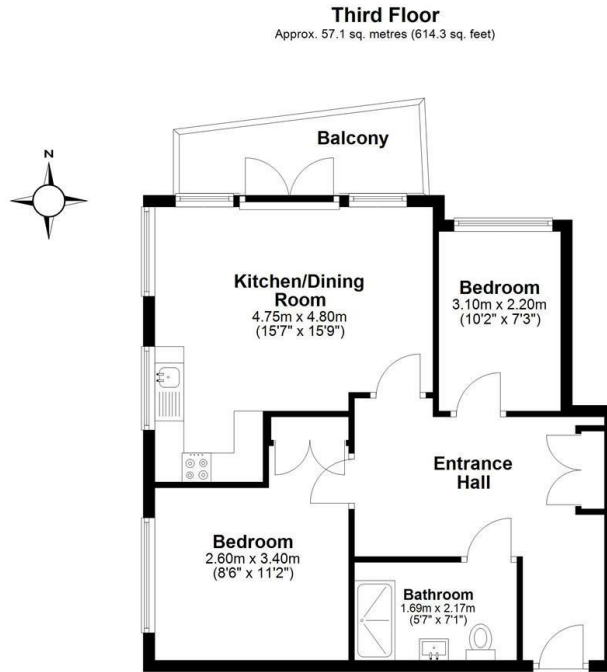

Total area: approx. 57.1 sq. metres (614.3 sq. feet)

This floor plan has been created by a third party and should be used as a general outline for guidance only. Any areas, measurements or distances quoted are approximate and any intending purchaser or lessee should satisfy themselves by inspection, searches, enquiries and/or full survey as to the correctness of each statement. We accept no responsibility or liability for any loss whatsoever that may arise as a result of this plan and the information contained within.

© @modephoto.uk | www.modephoto.co.uk
Plan produced using PlanUp.

Elm Tree Lodge

Sales Office
190 London Road, Southend-On-Sea,
Essex, SS1 1PJ

Contact
01702 34 11 77
<https://hairandson.co.uk/>

Agents Note: Whilst every care has been taken to prepare these particulars, they are for guidance purposes only. All measurements are approximate and for general guidance purposes only and whilst every care has been taken to ensure accuracy, they should not be relied upon and potential buyers/tenants are advised to recheck the measurements.

