



## BEATRICE HOUSE, E1

OIEO £300,000 SOF/H

- Share of Freehold
- Chain Free
- Ideal Starter Home
- Gated Parking
- Quiet Residential Setting
- Stepney Green Conservation Area

wj.  
meade

# Beatrice House

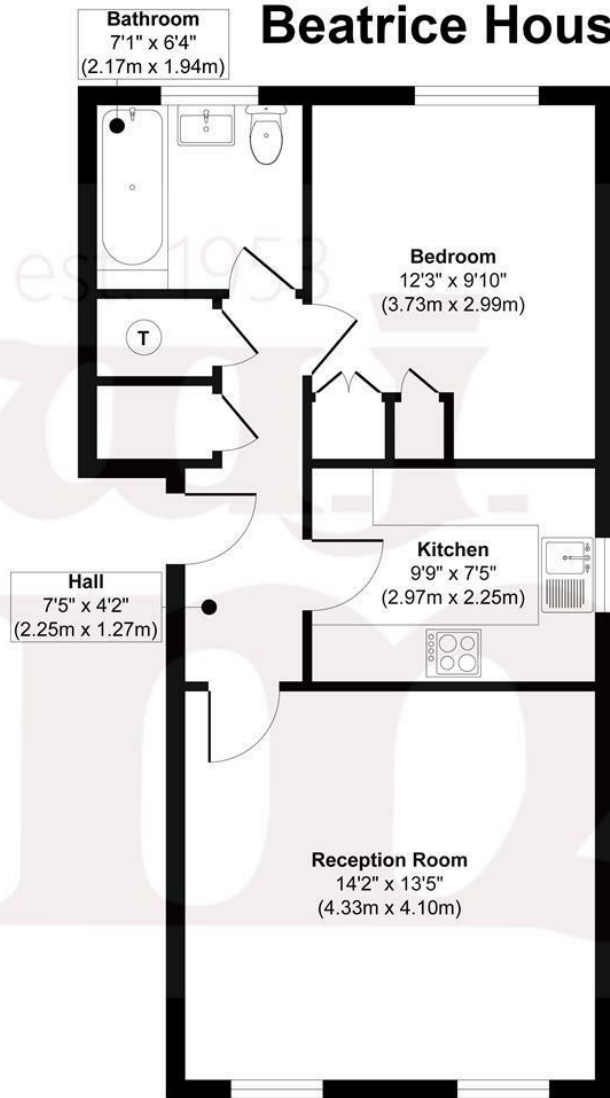

**Floor Plan**

**Approx. Gross Internal Floor Area 516 sq. ft / 47.98 sq. m**

Illustration for identification purposes only, measurements are approximate, not to scale.

Produced by Elements Property



WJ Meade are pleased to present this spacious one bedroom flat overlooking Stepney Green Gardens. Arranged over 516 sq ft with a West facing reception room, separate fitted kitchen and three piece bathroom suite. Well situated for various public transport links including Stepney Green tube and Whitechapel station (Elizabeth, District & Windrush Lines).

Service charge £5,042.20 pa

Ground rent £0

961 years lease

Council tax band B

Current EPC Rating 79

Tenure: Leasehold - Share of Freehold



All sizes are approximate. The Agent has not tested any apparatus, equipment, fixtures and fittings, or services and so cannot verify that they are in working order or fit for the purpose. A buyer is advised to obtain verification from their Solicitors or Surveyor. Photographs are for illustration purposes only and may depict items, which are not for sale or included in the sale price. References to tenure of a property are based upon information supplied by the vendor. The agent has not had sight of the title documents, a buyer is advised to obtain verification from their solicitor. Money Laundering Regulations 2003: Intending purchasers will be asked to produce identification, documentation at a later stage and we would ask for your co-operation in order that there will be no delay in agreeing the sale.

These particulars are intended to give a fair description of the property only and are in no way guaranteed, nor do of any contract. They are issued on the express condition that all negotiations are conducted through W.J. Meade Estate Agents. All subject to contract and to being unsold.