

6 Turnberry Drive, Abergele, LL22 7UD

£229,950

2 1 1



"Bryn Mair" - an attractive detached bungalow on Turnberry Drive, Abergele. Situated close to town including Tesco supermarket, the beach, park and regular bus services. This lovely property is available with no forward chain and offers hall, lounge/diner, kitchen, conservatory, two double bedrooms and a shower room. The garden to the rear is particularly private and there is driveway parking and a detached single garage with power.

Key Features

- Detached bungalow
- Conservatory
- Garage
- No forward chain
- Freehold
- Double glazing & uPVC guttering
- Two double bedrooms
- Easy to maintain gardens
- Council tax band - D
- EPC rating - C

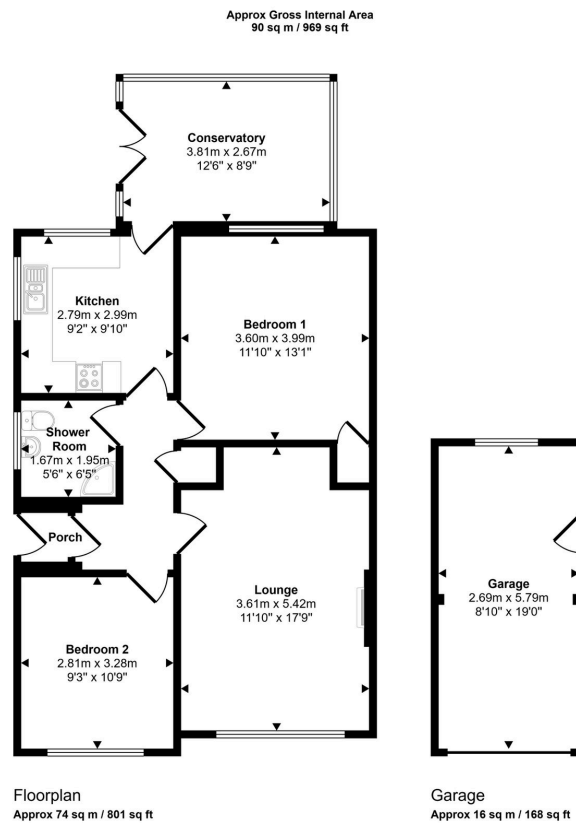

This floorplan is only for illustrative purposes and is not to scale. Measurements of rooms, doors, windows, and any items are approximate and no responsibility is taken for any error, omission or mis-statement. Icons of items such as bathroom suites are representations only and may not look like the real items. Made with Made Snappy 360.