



Ladywell | 1 Tower Road | Poole | BH13 6HY

£1,895 Per Month



**QSALES &
LETTINGS**

**Ladywell | 1 Tower Road
Poole | BH13 6HY
£1,895 Per Month**

Located close to Canford Cliffs, this two double bedroom first floor apartment offers generous family living.

TWO double bedrooms with master bedroom featuring en-suite shower room and built in storage. Family bathroom with bath & shower facilities.

Spacious lounge with balcony overlooking the communal gardens.

The kitchen is spacious & benefits from being fully fitted with build in oven, hob and hood. Breakfast sitting area.



GROUND FLOOR

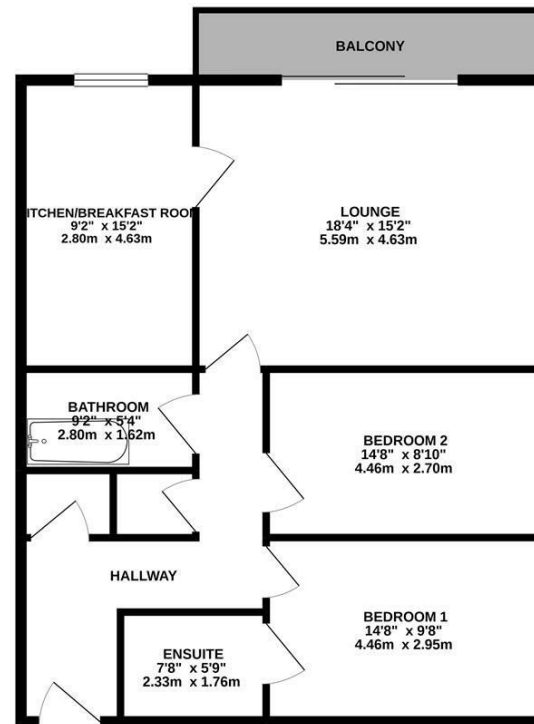

Energy Efficiency Rating		Current	Potential
<i>Very energy efficient - lower running costs</i>			
(92 plus) A			
(81-91) B		81	82
(69-80) C			
(55-68) D			
(39-54) E			
(21-38) F			
(1-20) G			
<i>Not energy efficient - higher running costs</i>			
England & Wales		EU Directive 2002/91/EC	

01202 283654
Jamie@qsaleslettings.co.uk
<https://www.qsaleslettings.co.uk/>

Whilst every attempt has been made to ensure the accuracy of the floorplan contained here, measurements of doors, windows, rooms and any other items are approximate and no responsibility is taken for any error, omission or mis-statement. This plan is for illustrative purposes only and should be used as such by any prospective purchaser. The services, systems and appliances shown have not been tested and no guarantee as to their operability or efficiency can be given.
Made with Meeplex ©2020