



## 46 Park Road

, Mexborough, S64 9PH

£135,000



**SOLD WITH NO ONWARD CHAIN & IMMEDIATE VACANT POSSESSION!!**

A lovely two-bedroom semi-detached home offering well-presented accommodation throughout, ideally suited to those looking to downsize, first-time buyers, or a young couple.

The property benefits from a driveway providing off-street parking, a garage, and a good-sized rear garden, offering excellent outdoor space.

Situated in the popular location of Mexborough, the home is conveniently placed close to a range of shops, amenities, schools, and transport links, making it ideal for commuters and everyday living.

This is a fantastic opportunity to acquire a well-located home with great potential in a sought-after area.



## GROUND FLOOR

### ENTRANCE

Welcoming entrance lobby with the staircase raising to the first floor.

### BREAKFAST KITCHEN

A lovely front-aspect kitchen fitted with a range of wall and base units, a one-bowl stainless steel sink with mixer tap, a stainless steel electric oven, four-ring gas hob, and extractor fan. The space also features a breakfast bar, room for a fridge freezer, and plumbing for a washing machine, with access through to the cloakroom and lounge.

### Downstairs WC

The WC is fitted with a low-flush WC, wall-mounted wash hand basin, and an extractor fan.

### LOUNGE

Relax in this spacious lounge, featuring a pleasant rear aspect and French doors that open directly onto the garden. The room also benefits from access to an under-stairs storage cupboard, providing useful additional space.

## FIRST FLOOR

### BEDROOM ONE

A front-aspect double master bedroom featuring a built-in storage cupboard, with additional space for freestanding storage solutions if required, and access to the en-suite.

### EN-SUITE

A modern suite comprising a low-flush WC, a tiled shower cubicle with a thermostatic shower, and a wall-mounted wash hand basin.

### BEDROOM TWO

A second double bedroom with a rear aspect, offering ample space for either freestanding or fitted furniture.

### BATHROOM

A modern bathroom comprising a bath, low-flush WC, and wall-mounted wash hand basin, with a rear aspect providing natural light and ventilation.

### OUTSIDE

To the side of the property is a driveway providing off-road parking, leading to the garage. To the rear, there is a good-sized enclosed garden, mainly laid to lawn, with a patio area ideal for outdoor entertaining.

## Area Map



## Floor Plans

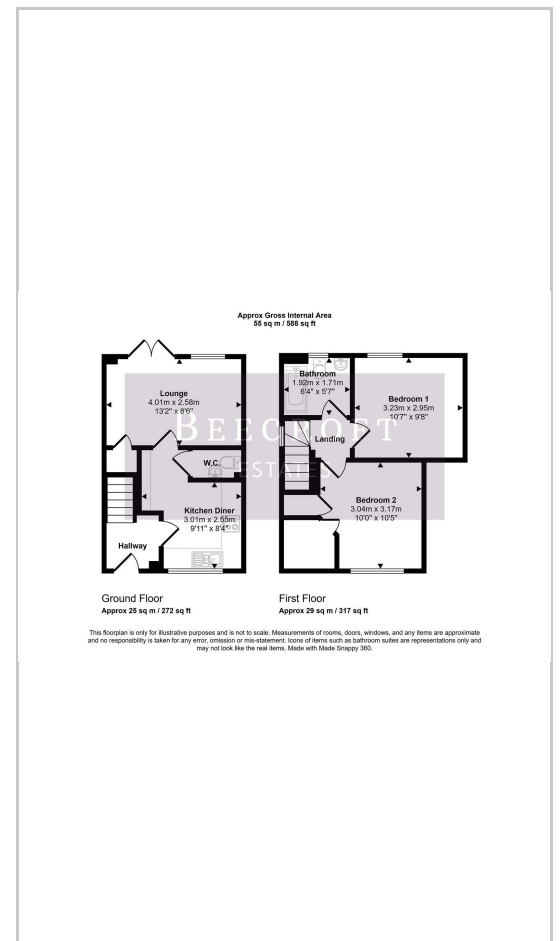

## Energy Efficiency Graph

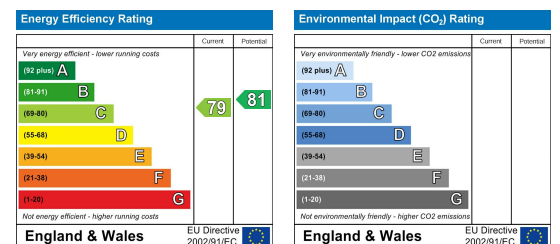

These particulars, whilst believed to be accurate are set out as a general outline only for guidance and do not constitute any part of an offer or contract. Intending purchasers should not rely on them as statements of representation of fact, but must satisfy themselves by inspection or otherwise as to their accuracy. No person in this firm's employment has the authority to make or give any representation or warranty in respect of the property.

Mexborough 40 Main Street, South Yorkshire, S64 9DU

Tel: 01709794677 Email: [mexborough@beecroftestates.co.uk](mailto:mexborough@beecroftestates.co.uk) [www.beecroftestates.co.uk](http://www.beecroftestates.co.uk)