



GLENFIELD ROAD, SW12

£3,000 PCM

- Two double bedrooms
- Reception room
- Modern kitchen
- Fitted bathroom
- Private garden
- Energy rating: D





## ABOUT THE HOME

A beautifully presented two bedroom maisonette on Glenfield Road, this property comes with a large kitchen/dinning room, two double bedrooms and sole use of the garden. Perfect for professional sharers.

Glenfield Road is a popular residential road close to Tooting Bec Common and a short distance from Balham. The property is well located for easy access to Balham mainline and underground stations as well as all of the shops, bars and restaurants local to the area.





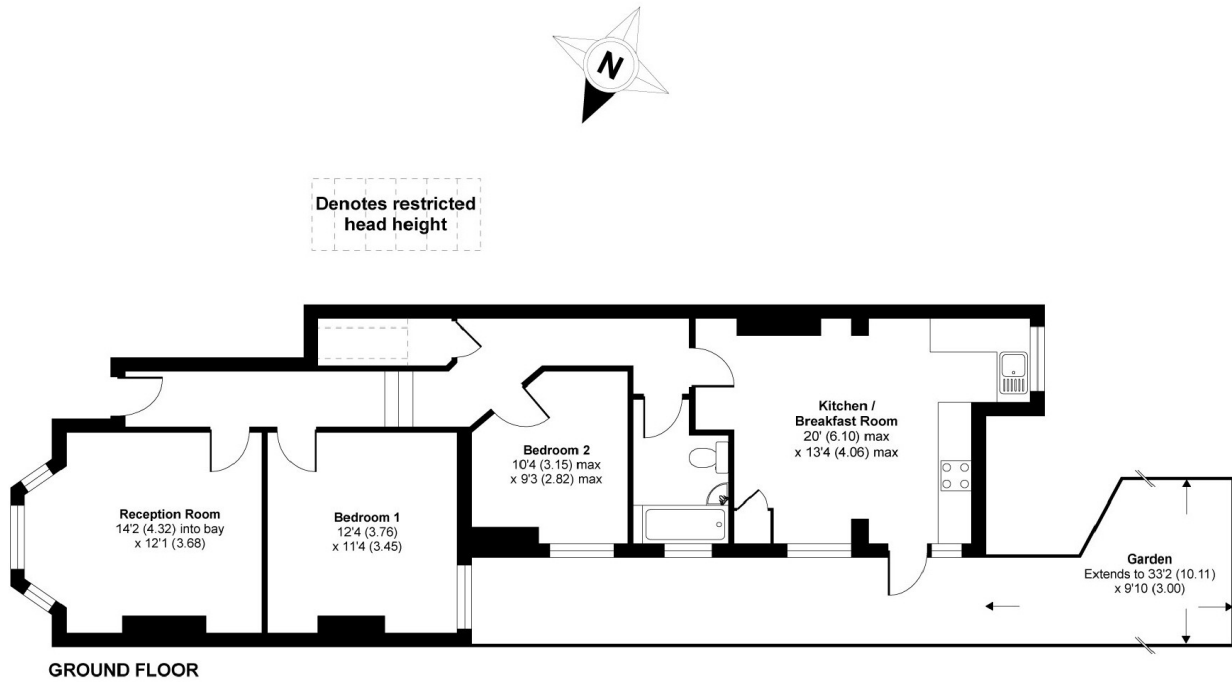

APPROX. GROSS INTERNAL FLOOR AREA 827 SQ FT 76.8 SQ METRES (INCLUDES RESTRICTED HEAD HEIGHT)

Glenfield Road, London, SW12

Copyright nichecom.co.uk 2012 Produced for Jacksons the Independent Estate Agents REF : 251080

### JACKSONS BALHAM

8-11 Balham Station Road,  
London, SW12 9SG  
Sales: 020 8675 6555  
Lettings: 020 8675 6565

Energy Rating: D We aim to make our particulars both accurate and reliable. However they are not guaranteed; nor do they form part of an offer or contract. If you require clarification on any points then please contact us, especially if you're traveling some distance to view. Please note that appliances and heating systems have not been tested and therefore no warranties can be given as to their good working order.