



## Scott Ellis Gardens, NW8

£438 Per week

A newly decorated one double bedroom apartment in a purpose block in St Johns Wood. Spacious reception room, separate kitchen, good size double bedroom with storage and bathroom with shower over bath. Ideal for a single professional or couple.

Scott Ellis Gardens is located a short distance to Lords Cricket Ground and less than a mile from Regents Park and St Johns Wood underground station giving resident good access to the City and Canary Wharf on the Jubilee Line.

### Features

- Newly Decorated
- One Double Bedroom
- Separate Kitchen
- Third Floor Apartment
- Lift
- Purpose Built Block

# Scott Ellis Gardens, London, NW8

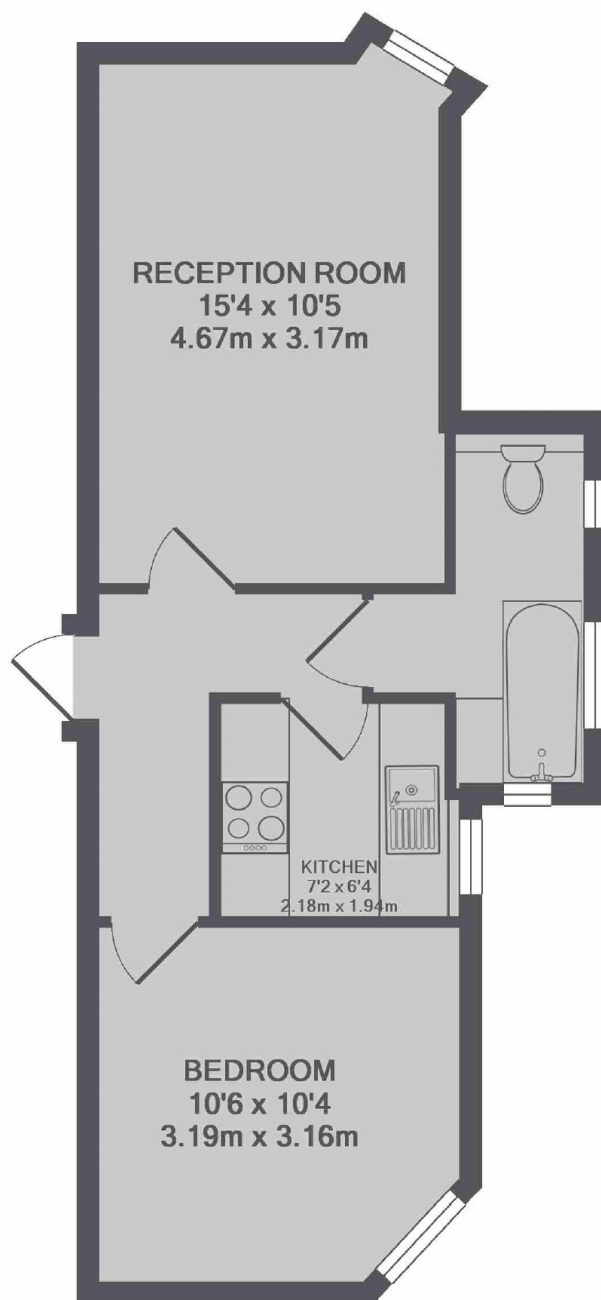

TOTAL APPROX. FLOOR AREA 421 SQ.FT. (39.1 SQ.M.)