



## Godman Road, SE15

£495,000

A two bedroom warehouse conversion flat located in the sought-after Alexander House on Godman Road. This unique space combines industrial charm with modern comfort.

A short walk takes you to Peckham Rye Station where you have easy access into London Bridge, London Victoria, Clapham Junction, Highbury & Islington and London Blackfriars. The popular Rye Lane is moments away and features an eclectic array of bars, restaurants, shops and cafes.

### Features

- Two Double Bedrooms
- Warehouse Conversion
- No Onward Chain
- Excellent Transport Links
- Open Plan Kitchen/Reception
- 578 Square Foot



## Godman Road, SE15

Boasting high ceilings, exposed brickwork, and large factory-style windows, the property is filled with natural light and character. The open-plan living area features a sleek fitted kitchen with integrated appliances, a spacious lounge, and dining area ideal for entertaining or relaxing after a long day. There are two double bedrooms which are serviced by a family sized bathroom. The property has 578 square feet of living space and is being sold with no onward chain



# Godman Road, London, SE15

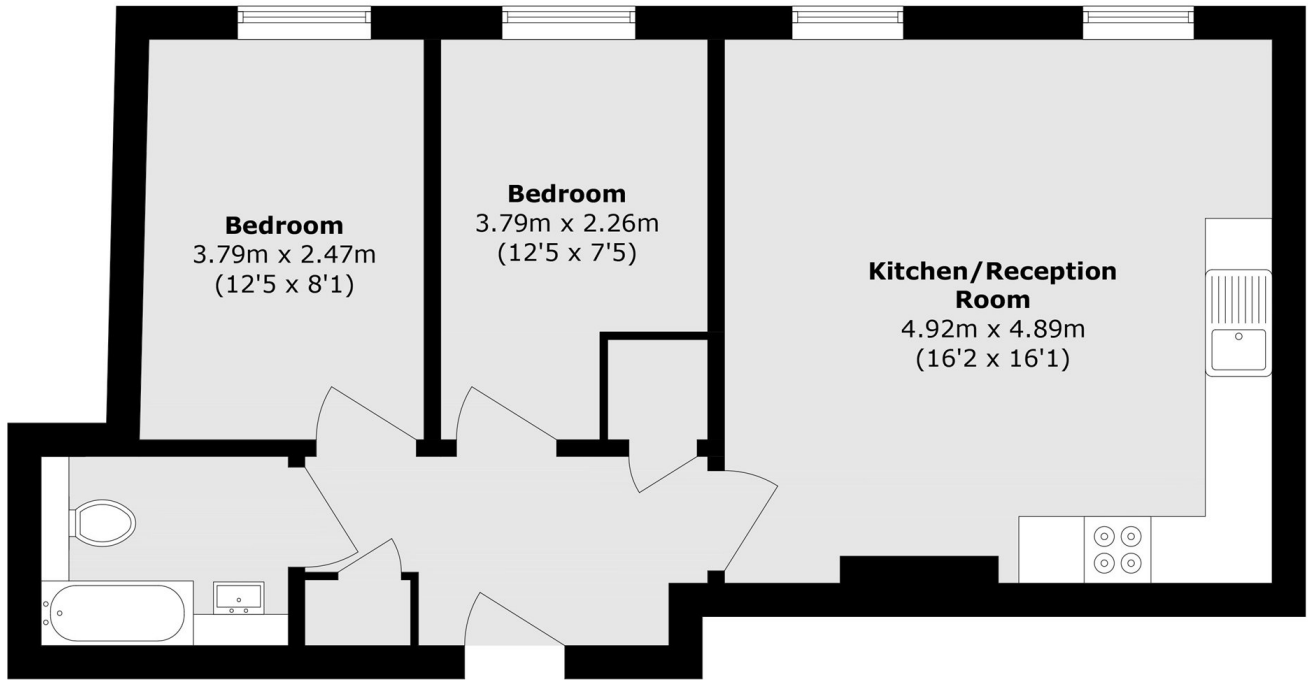

Total area (approx.): 53.7 sq. m (578.0 sq. ft)