



## Ladbroke Road, W11

£2,750 Per calendar month

An immaculate, newly refurbished two double bedroom apartment set on the raised ground floor of a well-maintained block, offering bright and spacious accommodation with wooden flooring throughout, a large reception room and a separate kitchen.

Ideally located in the heart of Notting Hill moments from Westbourne Grove and Portobello Road. Holland Park station is within 500ft, while the shops, bars and restaurants of both Notting Hill Gate and Westbourne Grove are just a short walk away.

### Features

- Two Double Bedrooms
- Separate Kitchen
- Raised Ground Level
- Newly Refurbished
- Wooden Flooring
- Plenty Of Storage
- Professionally Managed

Ladbroke Road,  
London, W11

### Ground Floor

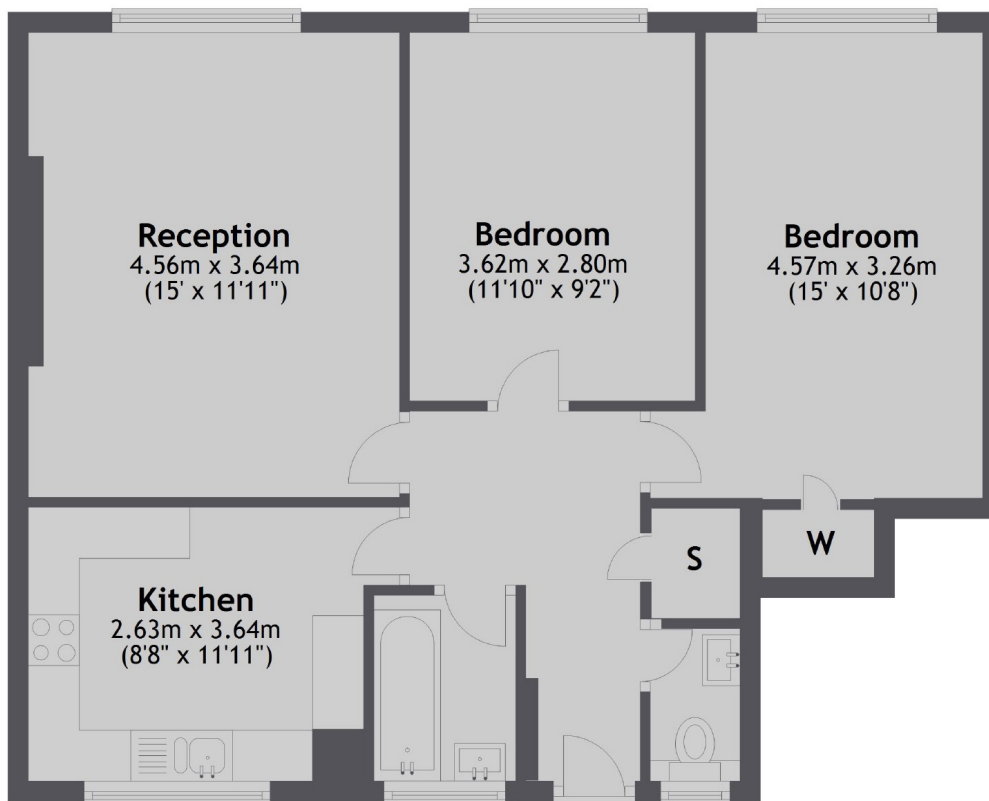

Total area: approx. 63.1 sq. metres (678.9 sq. feet)