



## Finchley Road, NW3

£525,000

This two bedroom flat is located on the top floor (with lift) and is set within this popular mansions block. The property benefits from having direct access to a private balcony and it has a share of freehold.

Mandeville Court is conveniently located to Finchley Road & Frognal Overground and Finchley Road tube station (Jubilee and Metropolitan lines) and excellent local amenities

### Features

- Two Bedrooms
- Private Balcony
- Mansion Block
- Share Of Freehold
- Lift Service
- No Onward Chain

# Finchley Road, London, NW3

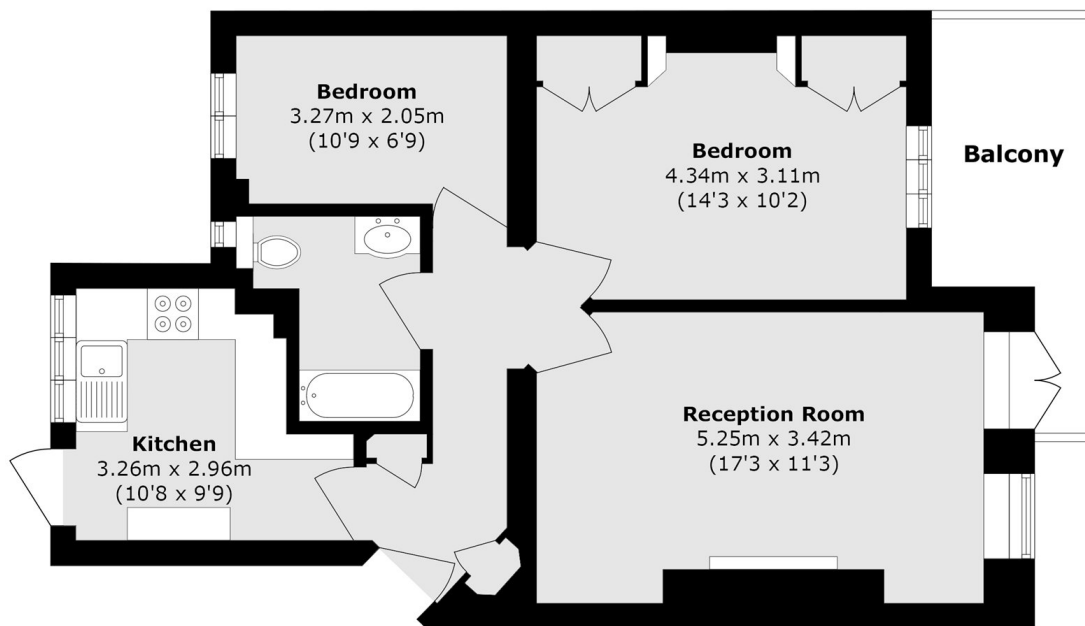

Total area (approx.): 60.7 sq. m (653.3 sq. ft)  
Balcony area (approx.): 7.2 sq. m (77.5 sq. ft)