

Fords.

SALES | LETTINGS | NEW HOMES



35 Longland Way, High Wycombe, HP12 3UQ

Ford & Partners are proud to bring to market a collection of 24 newly renovated one-bedroom maisonettes. The accommodation consists of one double bedroom, a bright and airy reception room with scenic views, a stylish kitchen with appliances and modern family bathroom.

Show Home Available to View Now - call now to avoid early disappointment.

- One of 24 Newly Renovated Apartments
- Stylish Kitchen with Appliances
- Modern Family Bathroom
- Electric Heating Systems
- Induction Hob
- Scenic Views
- Residents Parking
- Brand New UPVC Windows
- Show Home Available to View
- Available Immediately

£1,100 Per month

Longland Way

Approx. Gross Internal Area 468 Sq Ft - 43.48 Sq M

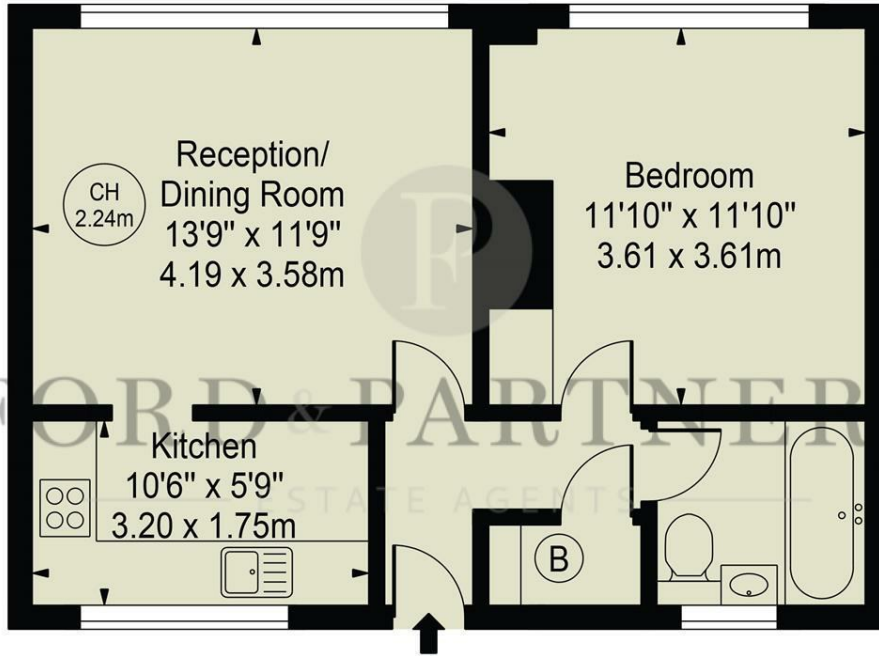
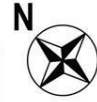

First Floor

For Illustration Purposes Only - Not To Scale

This floor plan should be used as a general outline for guidance only and does not constitute in whole or in part an offer or contract. Any intending purchaser or lessee should satisfy themselves by inspection, searches, enquiries and full survey as to the correctness of each statement. Any areas, measurements or distances quoted are approximate and should not be used to value a property or be the basis of any sale or let. Copyright Morriarti Photography & Design LTD

Energy Efficiency Rating		Current	Potential
Very energy efficient - lower running costs			
(92 plus) A			
(81-91) B			
(69-80) C			
(55-68) D			
(39-54) E			
(21-38) F			
(1-20) G			
Not energy efficient - higher running costs			
England & Wales	EU Directive 2002/91/EC	73	77

Environmental Impact (CO ₂) Rating		Current	Potential
Very environmentally friendly - lower CO ₂ emissions			
(92 plus) A			
(81-91) B			
(69-80) C			
(55-68) D			
(39-54) E			
(21-38) F			
(1-20) G			
Not environmentally friendly - higher CO ₂ emissions			
England & Wales	EU Directive 2002/91/EC		

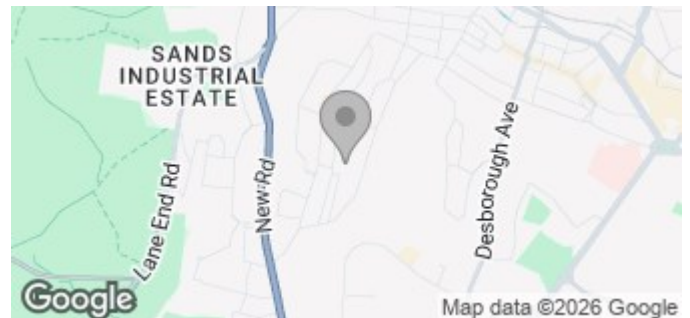

18 Crendon Street, High Wycombe, HP13 6LS

Tel: 01494 840 600 Email: sales@fordandpartners.com www.fordandpartners.com