

# THE HOME AGENCY

*'Passion for property.'*



102 The Grove, Sholing, Southampton, SO19 9LU

Asking Price £299,999

- Semi Detached
- No Forward Chain
- Open Plan Lounge/Diner
- Sought After Location
- Decked Garden
- Utility Room
- Gas Central Heating
- Modern Kitchen
- Two Double Bedrooms
- Garage

11 London Road, Southampton, Hampshire, SO15 2AE  
02380 632632

enquiries@thehomeagency.net  
<https://thehomeagency.net>

# 102 The Grove

Approximate Gross Internal Area  
872 sq ft - 81 sq m

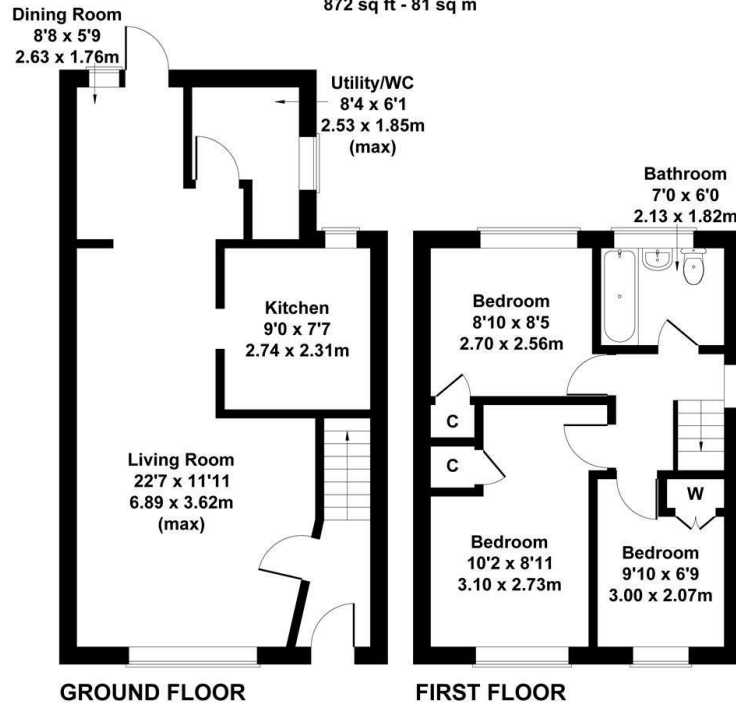

Not to Scale. Produced by The Plan Portal 2026  
For Illustrative Purposes Only.

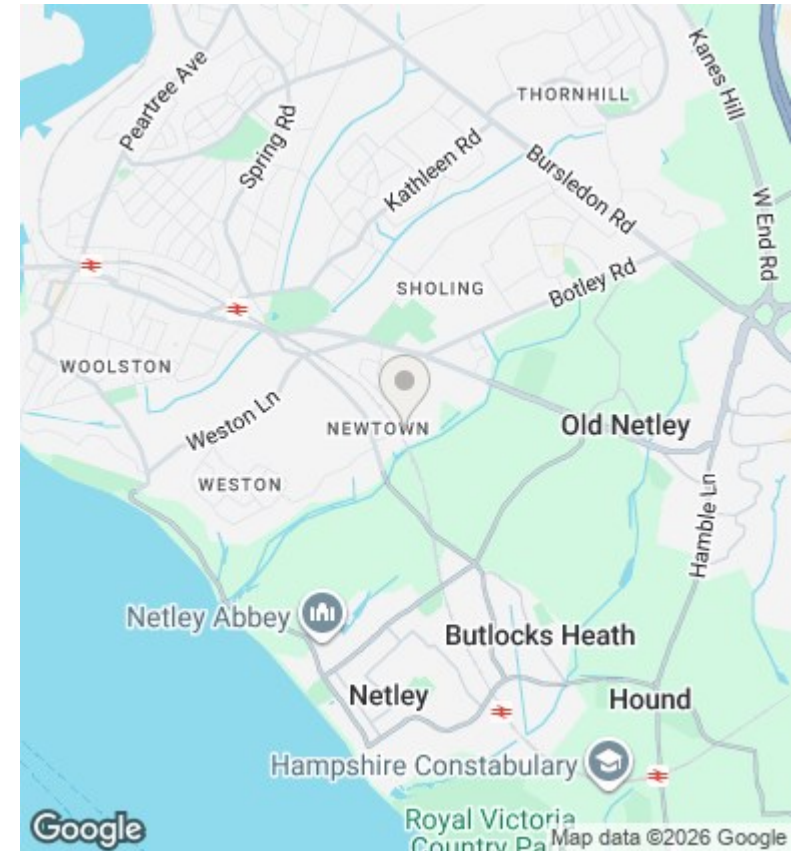

## Directions

## Viewings

Viewings by arrangement only. Call 02380 632632 to make an appointment.

## Council Tax Band

B

## EPC Rating:

D

Energy Efficiency Rating		Current	Potential
Very energy efficient - lower running costs			
(92 plus) A			
(81-91) B			85
(69-80) C			
(55-68) D		68	
(39-54) E			
(21-38) F			
(1-20) G			
Not energy efficient - higher running costs			
<b>England &amp; Wales</b>		EU Directive 2002/91/EC	