

THE WISTERIA

4 Bedroom Home



Artist's Impression

A beautiful four bedroom detached home.

Plots: 97, 112, 120

THE WISTERIA

4 Bedroom Home

Ground Floor



First Floor

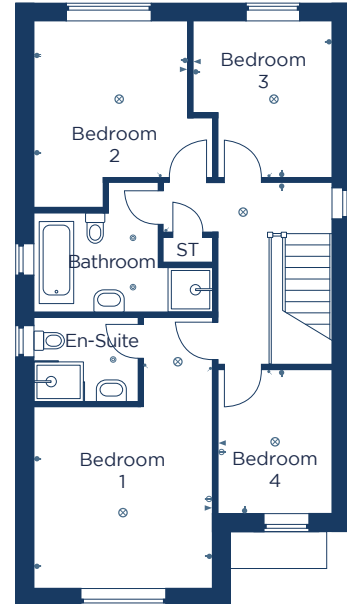

Kitchen / Dining
6000 x 4500 19'8" x 14'9"

Lounge
3600 x 4900 11'10" x 16'1"

W.C
1200 x 1800 3'11" x 5'11"

Utility
2300 x 1800 7'7" x 5'11"

Bedroom 1
3600 x 5450 11'10" x 17'11"

En-Suite
2100 x 1700 6'11" x 5'7"

Bedroom 2
3600 x 3750 11'10" x 12'3"

Bedroom 3
2800 x 3150 9'2" x 10'4"

Bedroom 4
2300 x 2900 7'7" x 9'6"

Bathroom
3600 x 2600 11'10" x 8'6"

● Low level socket

⊖ High level socket

⊗ Pendant light

⊕ External light

— Fluorescent light

⊙ Spotlight

⦿ Light switch

▶ TV point

▷ BT point

CONSUMER CODE FOR HOME BUILDERS

www.consumercode.co.uk

danumhomes.co.uk

All information contained in this leaflet is taken from design intent material and may be subject to further design development. Images are for illustration only and do not form part of any contract of sale. The dimensions and layouts given are estimated and for guidance only and are subject to chosen plot. T2 6663 Revision Date: 13.03.26 Revision: 02

The Wolds