

abbotFox



Skipper House, NR1  
*Offers In Excess Of £225,000*

“

We are a team of genuine individuals who hold a deep passion for both property and marketing. Collectively, we bring over 70 years of experience in the property market of Norfolk and Suffolk. Our affection for both counties runs deep, and we are enthusiastic about sharing our passion with you.

Colin McKenzie | **Branch Partner**







## THE DETAIL \_\_\_\_\_

abbotFox presents this exceptional two-bedroom apartment, perfectly positioned within one of Norwich's most sought-after City Centre developments. Offering impressive views towards the Cathedral, this home combines contemporary design with city convenience.

The generous open-plan living space provides the ideal setting for modern living, complemented by a sleek fitted kitchen and access to stunning outlooks across the city skyline. Both bedrooms are well-proportioned doubles, with the principal featuring an en-suite shower room, ensuring comfort and privacy.

Further benefits include secure allocated parking and lift access, making this the perfect opportunity for professionals or those seeking an effortlessly stylish city home. Offered to the market with no onward chain, an internal viewing comes highly recommended.







## THE HIGHLIGHTS \_\_\_\_\_

- CHAIN FREE
- Two double bedrooms
- En-suite shower room
- Secure allocated parking
- City and Cathedral views
- No onward chain
- Internal viewing advised
- Stylish apartment

Approx Gross Internal Area  
73 sq m / 783 sq ft

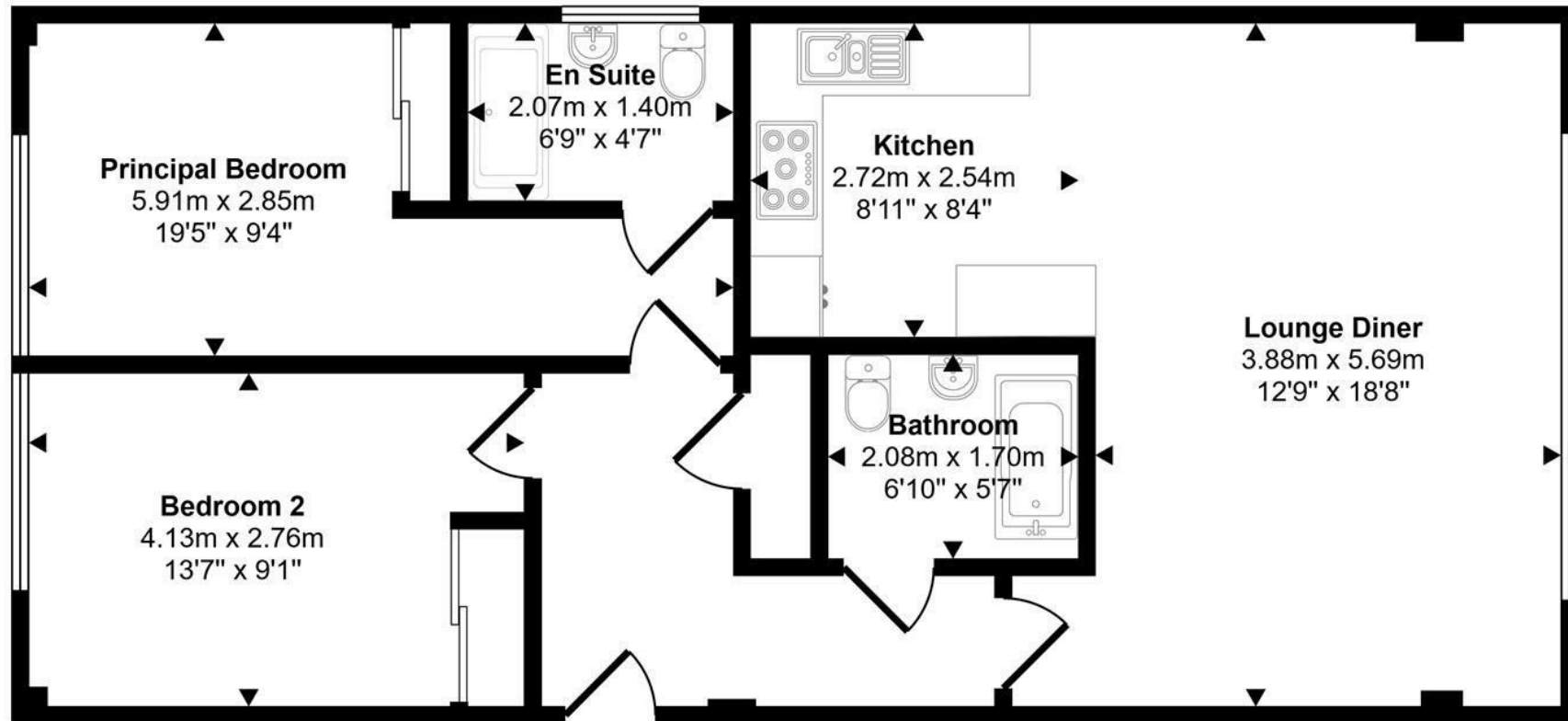

Floorplan

This floorplan is only for illustrative purposes and is not to scale. Measurements of rooms, doors, windows, and any items are approximate and no responsibility is taken for any error, omission or mis-statement. Icons of items such as bathroom suites are representations only and may not look like the real items. Made with Made Snappy 360.

*Let's talk*

01603 660000

sales@abbotfox.co.uk

@abbotfox

EPC RATING -

Disclaimer – In accordance with the Property Misdescriptions Act, the company abbotFox gives notice that all descriptions, references to condition, necessary permissions for use and other details are given in good faith and believed to be correct, but any purchaser should not rely on them as statements of fact, and must satisfy themselves by inspection or other means, as to their accuracy.