

14 Bridge Street, Thetford, Norfolk, IP24 3AA
Tel: 01842 754161
thetford@chilternsestateagents.co.uk
www.shiresresidential.com

chilterns

Estate & Letting Agents



St Johns Way, Thetford, IP24 3NU

Rent - £160,000 Deposit -

Are you searching for a property to add to your investment portfolio? This three bedroomed mid terraced home is being offered for sale with a tenant in situ generating an 8% yield per annum.

- IDEAL INVESTMENT PURCHASE
- THREE BEDROOMS
- APPROX. 8% YIELD PER ANNUM
- ENCLOSED REAR GARDEN
- OFFERED ON A CHAIN FREE BASIS!
- MID TERRACED HOUSE
- TENANT CURRENTLY IN SITU
- SITUATED TO THE SOUTH OF THETFORD
- CONVENIENT FOR A11 ACCESS
- VIEWING ADVISED!



Council Tax Band: A - EPC Rating: C 69

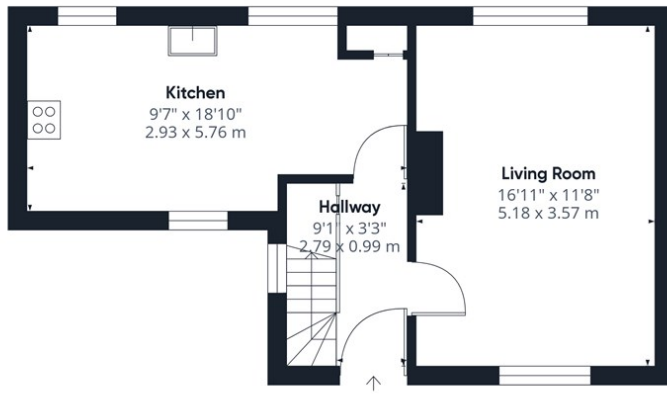

Ground Floor

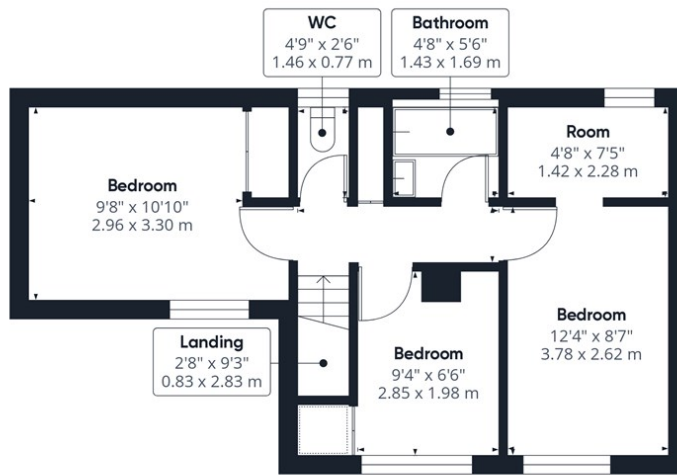

Floor 1

Approximate total area⁽¹⁾
814.08 ft²
75.63 m²

(1) Excluding balconies and terraces

While every attempt has been made to ensure accuracy, all measurements are approximate, not to scale. This floor plan is for illustrative purposes only.

Calculations are based on RICS IPMS 3C standard.

GIRAFFE 360

