

WE VALUE



YOUR HOME



The Murren, Wallingford
Offers Over £325,000



Originally a two-bedroomed property, the current living room has been opened up to create a larger and more versatile living space but could easily be converted back to provide a second bedroom if desired.

Offered with no chain, this modern double bedroomed ground floor maisonette provides high quality and convenient living in the popular area of Winterbrook, close to the centre of Wallingford and the Medical Centre.

This beautiful property features a central hallway with double storage cupboard, an open plan kitchen with breakfast bar leading to the spacious living, dining and snug/office area, all benefitting from the sunny south facing aspect. A modern shower room completes the internal accommodation.

The property also offers two off-road allocated parking spaces, visitor parking, and an extensive private gated communal garden with tennis court, alongside direct access to river walks and private river frontage.

What the owner says:

This used to be a two bedroom property so it has a very spacious, bright, airy feel. It's very quiet and private, yet boasts a central location being just a short walk into town centre and riverside walks. The beautiful private garden with tennis courts, meadow access to private river frontage and towpath with allocated parking are huge benefits.



Floor Plan

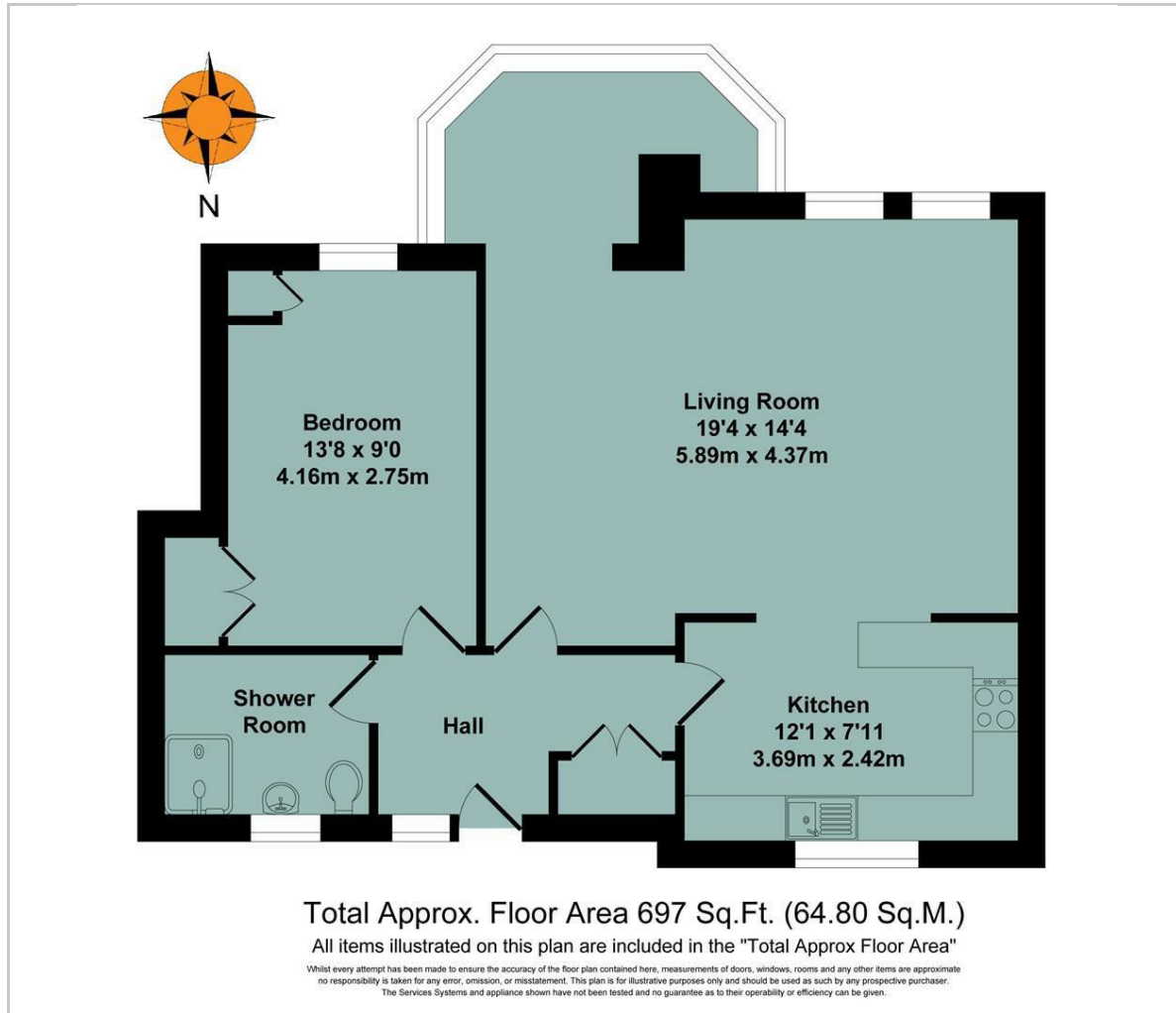

Area Map



Viewing

Please contact our In House Sales & Lettings Office on 01491 839999 opt.1 if you wish to arrange a viewing appointment for this property or require further information.

These particulars, whilst believed to be accurate are set out as a general outline only for guidance and do not constitute any part of an offer or contract. Intending purchasers should not rely on them as statements of representation of fact, but must satisfy themselves by inspection or otherwise as to their accuracy. No person in this firm's employment has the authority to make or give any representation or warranty in respect of the property.

28 St Martins Street, Wallingford, Oxfordshire, OX10 0AL
Tel: 01491 839999 opt.1 Email: sales@inhouseestateagents.co.uk www.inhouseestateagents.co.uk