

These floor plans are intended only as a guide to the general layout of the property. They do not constitute a contract, part of a contract or a warranty. You should obtain clarification on any matters or information that are important to you.

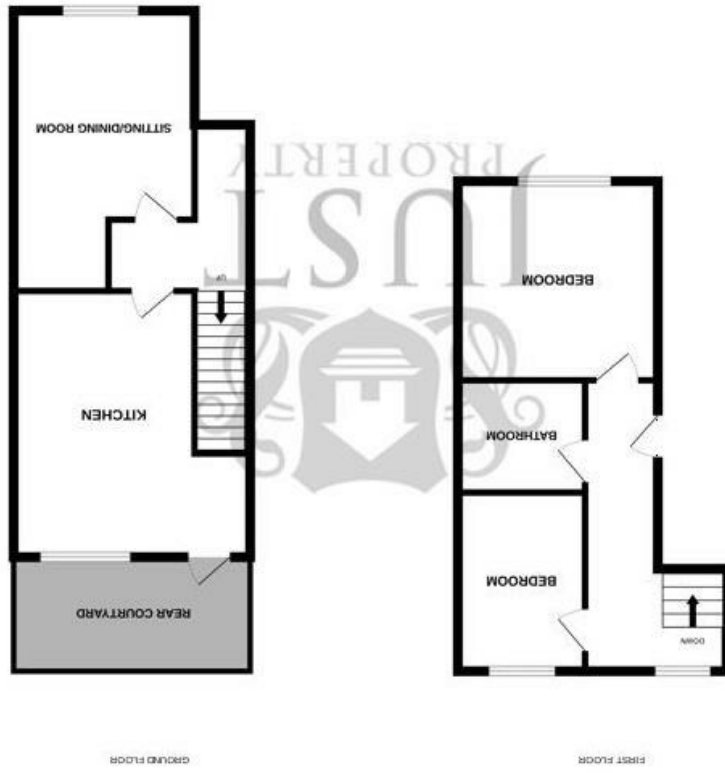

Flat 1 1, Burdett Place, Old Town, Hastings, TN34 3ED

FLOORPLANS

www.justproperty.net

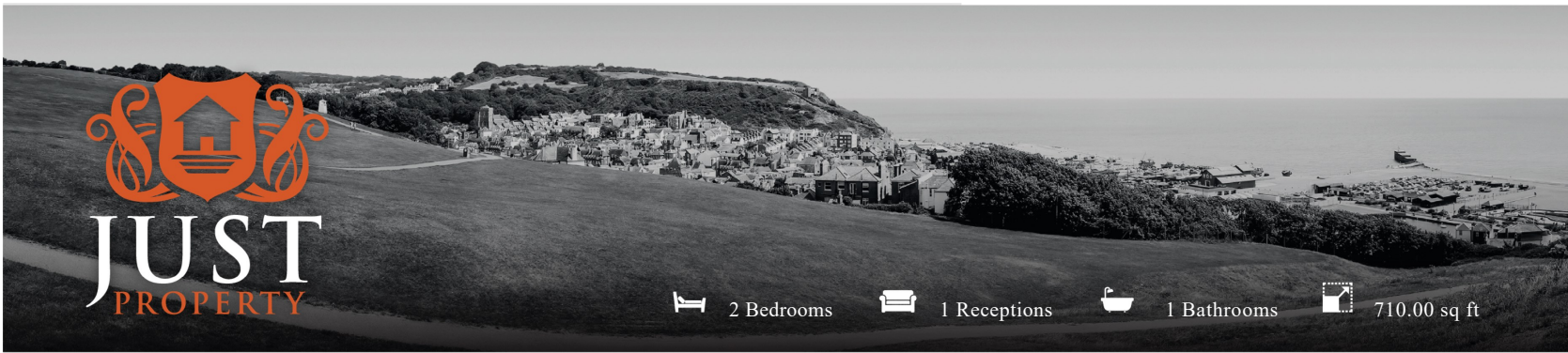

2 Bedrooms | 1 Receptions | 1 Bathrooms | 710.00 sq ft

Leasehold

£275,000

Flat 1 1, Burdett Place, Old Town,, Hastings, TN34 3ED





2 Bedrooms 1 Receptions 1 Bathrooms 710.00 sq ft

PROPERTY DETAILS

OFFERS IN EXCESS OF £275,000

Located within the heart of Hastings, this immaculately presented Grade II listed flat on Burdett Place offers a delightful blend of historic charm and modern living. With two well-proportioned bedrooms, this property is perfect for individuals, couples, or small families seeking a comfortable and stylish home in a central location.

The property boasts a welcoming and spacious reception room that serves as the heart of the flat, providing an inviting space for relaxation and entertaining. The natural light floods through the windows, enhancing the warm and welcoming atmosphere. The flat also has a well-appointed bathroom, ensuring convenience and comfort for its residents.

One of the standout features of this property is the rear courtyard, a lovely outdoor space that offers a peaceful retreat from the hustle and bustle of daily life. It is an ideal spot for enjoying a morning coffee or unwinding after a long day.

Situated in a central location, this flat provides easy access to local amenities, shops, and transport links, making it a perfect choice for those who appreciate the vibrancy of urban living while still enjoying the tranquillity of a residential setting.

This property is a rare find, combining historical significance with modern comforts, making it an excellent opportunity for anyone looking to invest in a charming home in Hastings. Don't miss the chance to make this delightful flat your own.

To arrange access for a viewing, contact the vendors choice of sole agents, Just Property to see all this charming flat has to offer.



ROOM DIMENSIONS

Communal Hallway up to 1st floor Entrance

Entrance Hallway

Bedroom
10'5" x 7'4" (3.18 x 2.26)

Bathroom
8'6" x 5'8" (2.6 x 1.75)

Bedroom
12'4" x 10'4" (3.76 x 3.15)

Lower Ground Floor

Kitchen
14'2" x 9'3" (4.32 x 2.82)

Living Room
18'0" x 10'2" (5.49 x 3.12)

Courtyard

FEATURES

- Ground Floor / First Floor Maisonette
- Central Old Town Location
- Grade II Listed
- Two Bedrooms
- Immaculately Presented Throughout
- Recently Decorated
- Rear Courtyard Garden
- 118 Year Long Lease
- Viewing Considered Essential
- Council Tax Band - B

