

Whilst every attempt has been made to ensure the accuracy of the floor plan and details contained here, measurements of doors, windows, rooms and any other items are approximate and no responsibility is taken for any error, omission, or mis-statement. This plan is for illustrative purposes only and should be used as such by any prospective purchaser. The services, systems and appliances shown have not been tested and have no guarantee as to their operability or efficiency can be given. Floor plan made with Metropix 2014. Fixtures and fittings may vary at point of sale.

Tel: 01536 524475
www.chrisgeorgeestategent.co.uk

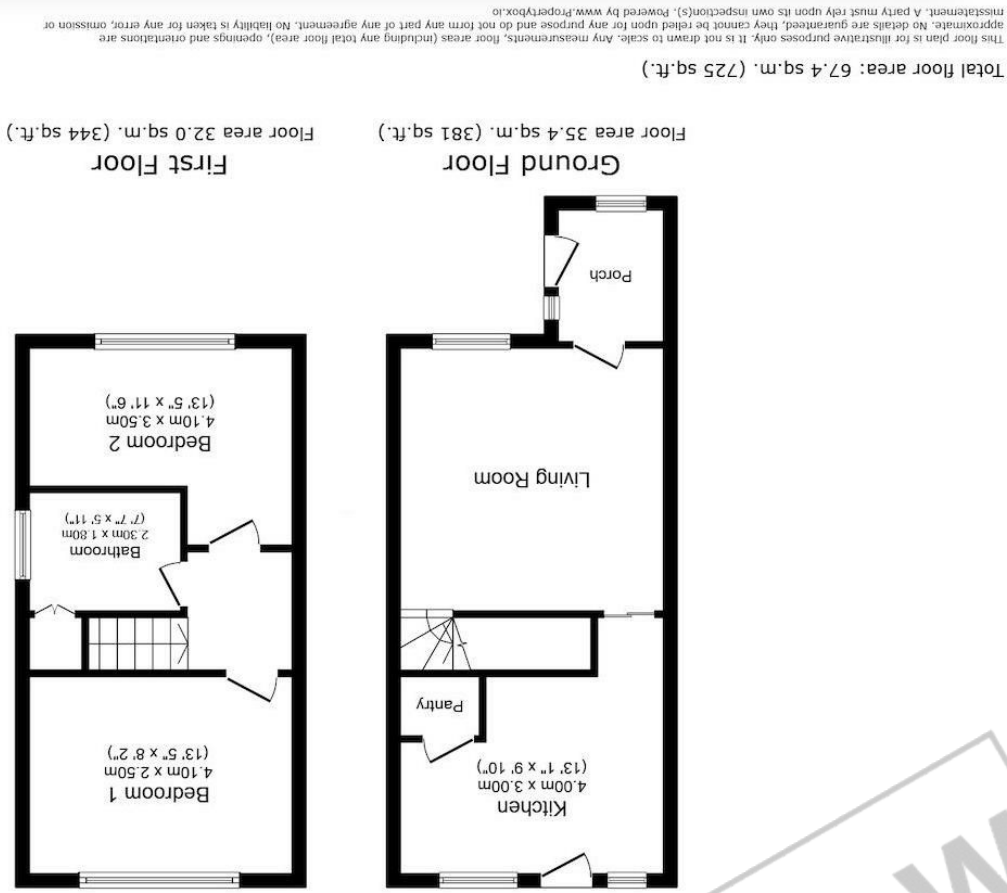

Corby
1A SPENCER COURT
CORBY
NORTHAMPTONSHIRE
NN17 1BH

Thrapston
22 HIGH STREET
THRAPSTON
NORTHAMPTONSHIRE
NN14 4JH

Rothwell
30 HIGH STREET
ROTHWELL
NORTHAMPTONSHIRE
NN14 6BQ

Kettering
12B HORSEMARKET
KETTERING
NORTHAMPTONSHIRE
NN16 0DQ



18 Washington Court, Kettering, NN14 4TF
Asking price £235,000



Nestled in the charming area of Washington Court, Thrapston, Kettering, this delightful house presents an excellent opportunity for those seeking a comfortable and inviting home, with potential to modernise to their taste and potential further development. With two well-proportioned reception rooms. The two bedrooms provide a peaceful retreat, perfect for unwinding after a long day.

The house features a well-appointed bathroom recently refitted, ensuring convenience for residents and visitors alike. Additionally, the property boasts parking for two vehicles, a valuable asset in today's busy world.

Thrapston is known for its friendly community and convenient amenities, making it an ideal location for families and professionals. With easy access to local shops, schools, and parks, this home is perfectly situated to enjoy all that the area has to offer.

This property is a wonderful blend of comfort and convenience, making it a must-see for anyone looking to settle in this lovely part of Thrapston. Don't miss the chance to make this charming house your new home.



PREVIEW



Porch
3'11" x 4'7" (1.2 x 1.4)

Living Room
13'1" x 9'10" (4.0 x 3.0)

Kitchen
13'1" x 9'10" (4.0 x 3.0)

Bedroom One
13'5" x 8'2" (4.10 x 2.50)

Bedroom Two
13'5" x 11'5" (4.10 x 3.50)

Bathroom
7'6" x 5'10" (2.30 x 1.80)

