



## Court Way, W3

LONG LET. This spacious and beautifully presented one bedroom flat with an additional study is situated in a leafy residential street offering a modern interior and private garden.

- SUITABLE FOR A COUPLE ONLY
- MODERN INTERIOR
- CLOSE TO LOCAL TRANSPORT
- LARGE STUDY
- SMART BATHROOM
- OPEN PLAN KITCHEN

£2,350 PCM

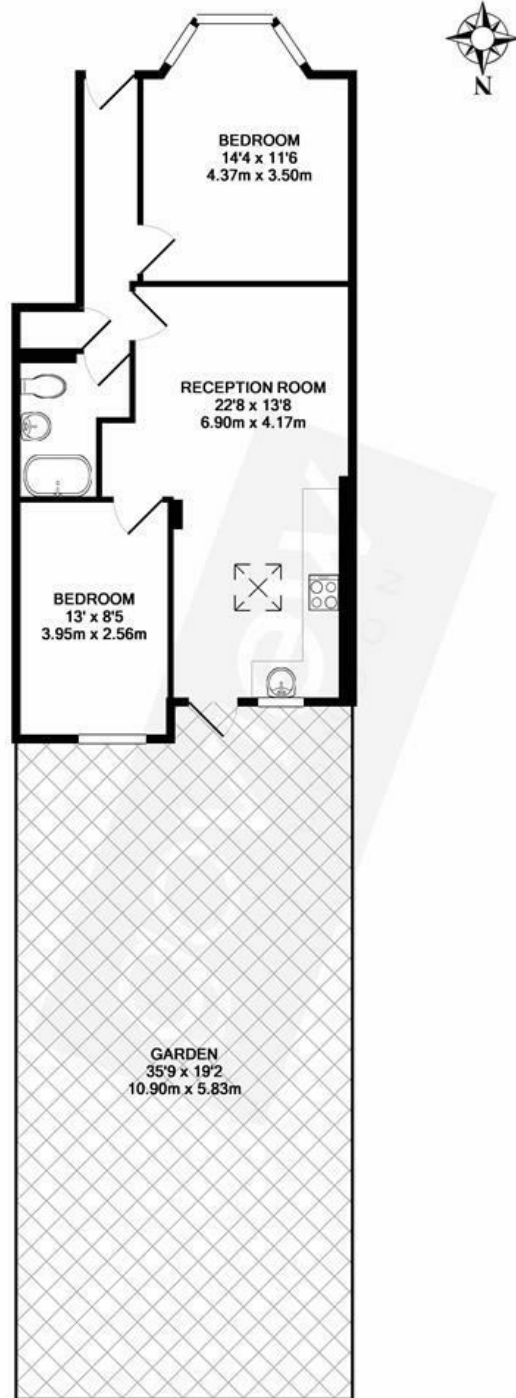

TOTAL APPROX. FLOOR AREA 598 SQ.FT. (55.5 SQ.M.)

Whilst every attempt has been made to ensure the accuracy of the floor plan contained here, measurements of doors, windows, rooms and any other items are approximate and no responsibility is taken for any error, omission, or mis-statement. This plan is for illustrative purposes only and should be used as such by any prospective purchaser. The services, systems and appliances shown have not been tested and no guarantee as to their operability or efficiency can be given.

Made with Metropix ©2019

Energy Efficiency Rating		
	Current	Potential
Very energy efficient - lower running costs		
(92 plus) <b>A</b>		
(81-91) <b>B</b>		
(69-80) <b>C</b>		
(55-68) <b>D</b>		
(39-54) <b>E</b>		
(21-38) <b>F</b>		
(1-20) <b>G</b>		
Not energy efficient - higher running costs		
<b>England &amp; Wales</b>	EU Directive 2002/91/EC	