



9 Beaumaris Gardens Hythe, SO45 6QA

- FIVE BEDROOM DETACHED HOME
- DRIVE FOR TWO CARS
- SOUGHT-AFTER AREA
- SPACIOUS ROOMS
- SHORT WALK TO SHOPS
- DOUBLE GARAGE
- GENEROUS REAR GARDEN WITH PATIO
- FOUR BATHROOMS
- UTILITY ROOM
- CLOSE TO NEW FOREST NATIONAL PARK

£675,000 Freehold





Entrance Hall

A spacious entrance hall that leads to dining room, kitchen, living room, and double garage. Also included within the space is a downstairs WC and stairs leading to the first floor.

Dining Room

11'1" x 10'5"

The sizable dining room looks over the front of the house through a generous window.

Kitchen

19'0" x 11'9"

The kitchen has glass doors leading to the rear garden, space for a dining area as well as an abundance of counter space conveniently looking over the garden.

Living Room

16'4" x 14'9"

A beautiful and spacious living room with a large window and glass doors to the rear garden. Also set with a charming fireplace, radiator, and plenty of space for furniture.

Utility Room

6'10" x 5'2"

The utility room comes off the kitchen and leads conveniently to the rear garden.

Master Bedroom

13'5" x 11'9"

The master bedroom looks over the front of house and includes a large window and en-suite.

Bedroom 2

11'5" x 10'5"

The second bedroom looks over the rear of the house. This bedroom also has an en-suite.

Bedroom 3

14'5" x 9'6"

The third bedroom has a substantial window looking over the front of the house. It is the closes bedroom to the family bathroom.



Bedroom 4

9'6" x 7'10"

The fourth bedroom also looks over the rear of the property.

Bedroom 5

11'9" x 8'10"

The fifth bedroom looks over the rear and shares an en-suite with bedroom 2.

Bathroom 1

The family bathroom is found on the first floor and thoughtfully placed near each bedroom.

Bedroom 2

The second bathroom is also found on the first floor between the second and fifth bedrooms, providing further privacy.

En-Suite

Double Garage

17'4" x 16'8"



Local Authority **NFDC**
Council Tax Band **F**
EPC Rating **D**

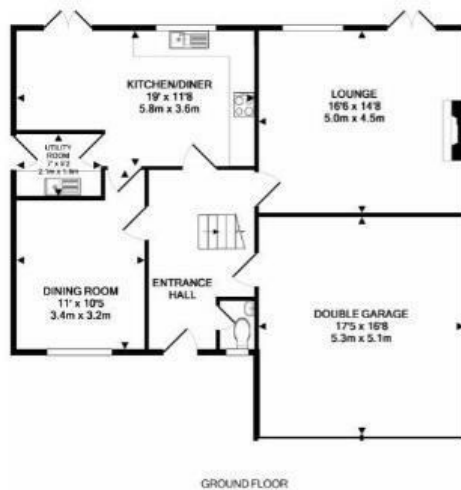

Whilst every attempt has been made to ensure the accuracy of the floor plan contained here, measurements of doors, windows, rooms and any other items are approximate and no responsibility is taken for any error, omission, or mis-statement. This plan is for illustrative purposes only and should be used as such by any prospective purchaser. The services, systems and appliances shown have not been tested and no guarantee as to their operability or efficiency can be given.
Made with Simplot 02/18

Citrine Estates Office

7 High Street, Hythe, Southampton,
SO45 6AG

Contact

023 81980 023
christina@citrine-estates.co.uk
www.citrine-estates.co.uk

Agents Note: Whilst every care has been taken to prepare these particulars, they are for guidance purposes only. All measurements are approximate and for general guidance purposes only and whilst every care has been taken to ensure accuracy, they should not be relied upon and potential buyers/tenants are advised to recheck the measurements.