

# Long Lane

Hillingdon • Middlesex • UB10 9PG  
Offers In Excess Of: £400,000



coopers  
est 1986

# Long Lane

Hillingdon • Middlesex • UB10 9PG

\*PRIVATE GARDEN\* A spacious and well-presented four-bedroom first-floor apartment, extending to approximately 1,180 sq ft, ideally located on Long Lane. The property offers excellent access to a range of local amenities, including nearby shops, highly regarded schools (within Viners High School catchment area), and Hillingdon Underground Station, served by the Metropolitan and Piccadilly lines. The A40/M40 is also within easy reach, providing convenient routes into London and the Home Counties, while Uxbridge Town Centre is just a short drive away. Internally, the property comprises 10ft kitchen, 16ft living room with dining area and 10ft first bedroom. To the second floor, there is the 14ft main bedroom with fitted wardrobes, 10ft third bedroom, family bathroom and a separate shower room. The third floor has the 15ft fourth bedroom with fitted wardrobes and ample eaves storage surrounding. Outside, there is a south-facing private rear garden that has been laid with artificial grass creating a low maintenance feel.

Four bedroom apartment

First floor

Ideal for first time buyers

Sought after location

Great transport links

16ft living room

10ft kitchen

14ft main bedroom with fitted wardrobes

Long lease

South-facing private rear garden

These particulars are intended as a guide and must not be relied upon as statements of fact. Your attention is drawn to the Important Notice on the last page.





1ST FLOOR  
487 sq.ft. (45.2 sq.m.) approx.



2ND FLOOR  
483 sq.ft. (44.9 sq.m.) approx.



3RD FLOOR  
211 sq.ft. (19.6 sq.m.) approx.

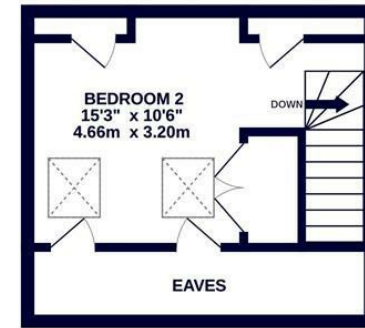

TOTAL FLOOR AREA : 1180 sq.ft. (109.6 sq.m.) approx.

Whilst every attempt has been made to ensure the accuracy of the floorplan contained here, measurements of doors, windows, rooms and any other items are approximate and no responsibility is taken for any error, omission or mis-statement. This plan is for illustrative purposes only and should be used as such by any prospective purchaser. The services, systems and appliances shown have not been tested and no guarantee as to their operability or efficiency can be given.  
Made with Metropix ©2026



109 Hillingdon Hill, Hillingdon Village,  
Middlesex, UB10 0JQ  
hillingdon@coopersresidential.co.uk

CoopersResidential.co.uk

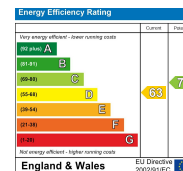

Important Notice: These particulars, whilst believed to be accurate are set out as a general outline only for guidance and do not constitute any part of an offer or contract. Intending purchasers should not rely on them as statements or representation of fact, but must satisfy themselves by inspection or otherwise has the authority to make or give any representation or warranty in respect of the property.