



4



2



2

SOUTHGATE
ESTATES

£750,000

2 Buckerell Avenue, Exeter, Devon, EX2 4RA





2 Buckerell Avenue

A substantial period detached property of approx. 2000 sq.ft, conveniently positioned in the highly-desirable St Leonard's location of Buckerell Avenue. This delightful four bedroom home comes with a generously sized and beautiful garden to the rear of the property, as well as a private driveway at the front of the house and garage to the rear.

Situated within in the parish of St. Leonards, the property is very close to the Riverside Valley Park and is within easy walking distance of County Hall and the RD&E Hospital. There is also good access to bus routes and to Exeter City Centre. Internally, the well-proportioned accommodation offers spacious room sizes throughout, including a two-storey extension to the rear (adding 32m² extra internal space to the property). The ground floor comprises an entrance porch leading into a hallway with doors to a bay fronted living room, separate dining room, downstairs cloakroom, and a significantly extended kitchen breakfast room by the current owners, with a utility area to the rear. Upstairs, there are four bedrooms, with an en suite to the master, and a family bathroom.

Built in 1932, the property enjoys many character features with large curved bay windows, wood panelling and leaded windows. Also offered with the benefit of no onward chain, internal viewing is highly recommended in order to fully appreciate all that this elegant property offers.

Ground Floor The front door opens to a large enclosed porch with windows to the front and side aspects, and a feature leaded door opening to the hallway. The hallway allows access to the spacious kitchen breakfast room, the living room, dining room and convenient downstairs cloakroom, and stairs rise to the first floor incorporating storage below. The inviting living room is complemented by a curved bay window to the front aspect allowing ample natural light to the room, and also includes picture rails and a solid wood fireplace surround. The separate dining room offers leaded windows and a door leading out to the garden, as well as further windows to the side aspect. The impressive kitchen breakfast room has been extended by the current owners to provide extra space. There are a number of wall and base units with quartz worktops, and a stainless steel double sink and drainer unit with a mixer tap over. Space is provided for a range cooker, a dishwasher and a fridge freezer, and windows face the side and rear aspects. To the rear of the kitchen is a utility area which provides further cupboard space, and a door to the garden.





First Floor Stairs rise to the large first floor landing which accommodates the four bedrooms and the family bathroom. The master bedroom benefits from an en suite bathroom with a wet room floor, plus a window overlooking the garden. The second and third bedrooms are further doubles, both featuring ample built-in storage. Finally, the fourth bedroom is divided into two sections, with windows to the front and side aspects. The family bathroom comprises a bath with a shower over, a wash basin with a mixer tap over and vanity unit below, plus a hidden cistern WC.

Garden The extensive rear garden is a prime feature of the property, with delightful wildflower beds, and various specimen trees. Partly-walled, a central path extends to the rear border where there is a greenhouse and impressive neighbouring poplar trees which provide a more secluded feel. The path is lined with sections of lawn, and there is also a summerhouse, plus a gate allowing side access.

Outside Store At the side of the property there is a useful outside store which can be accessed from both the front and rear of the house.

Garage & Driveway Garage Size: 15' 10" x 10' 0" (4.82m x 3.04m) To the left of the property, there is access to the shared driveway and the garage which has double doors to the front, a door to the garden and is serviced by power and lighting, with space to park in front. There is also a further area for parking at the front.

Property Information Tenure: Freehold. Council tax band: E.

- *Four Bedrooms*
- *Detached Family Home*
- *Extensive Rear Garden*
- *Recent two-story Extension to rear*
- *2 Driveways & Garage*
- *St Leonard's Location*



Energy Performance Rating

Score	Energy rating	Current	Potential
92+	A		
81-91	B		
69-80	C		77 C
55-68	D	66 D	
39-54	E		
21-38	F		
1-20	G		



www.tpos.co.uk

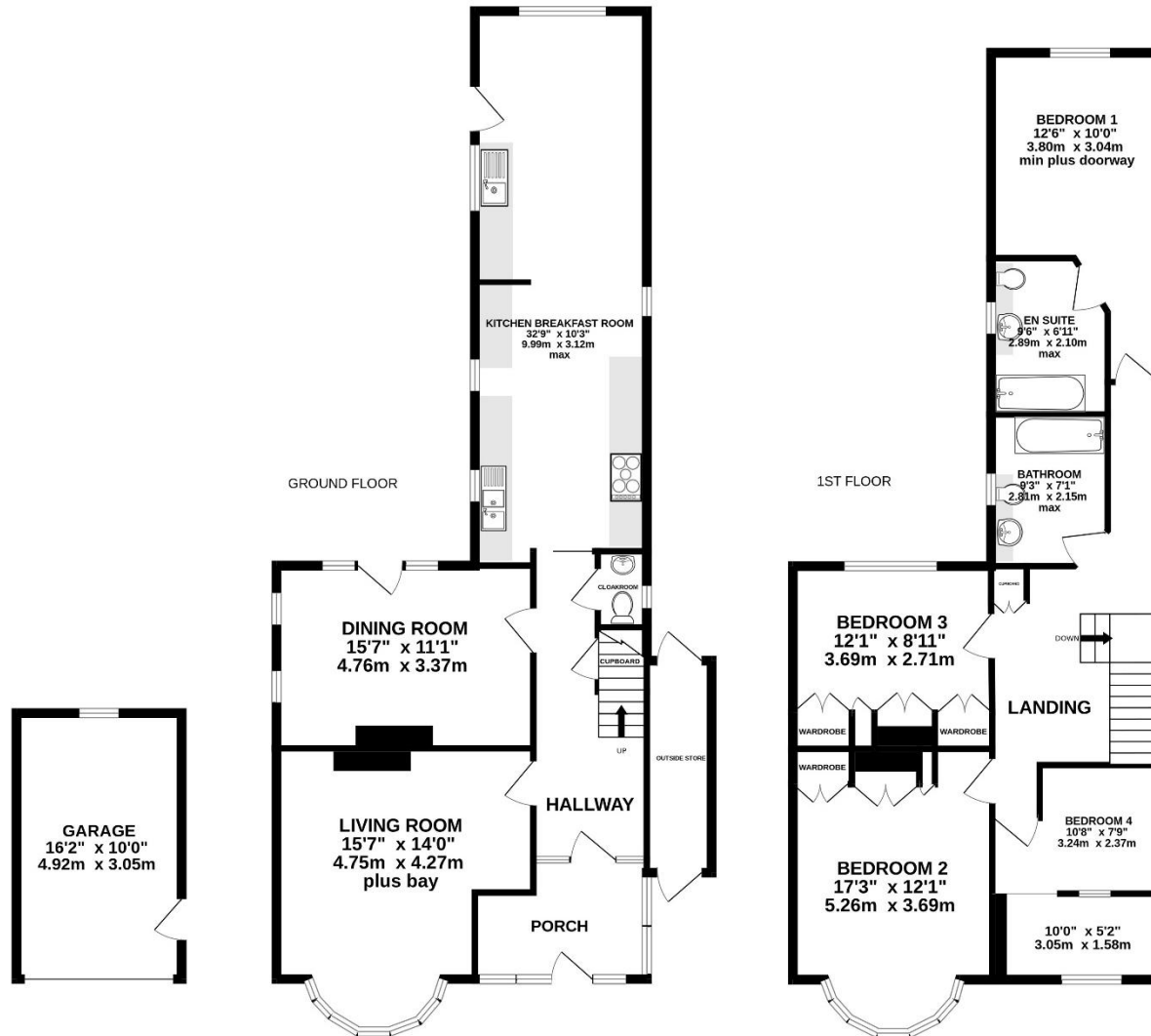

Whilst every attempt has been made to ensure the accuracy of the floorplan contained here, measurements of doors, windows, rooms and any other items are approximate and no responsibility is taken for any error, omission or mis-statement. This plan is for illustrative purposes only and should be used as such by any prospective purchaser. The services, systems and appliances shown have not been tested and no guarantee as to their operability or efficiency can be given.
Made with Metropix ©2026

Note: these particulars are not to be regarded as part of a contract. None of the statements made in these particulars are to be relied upon as statements or representation of fact. Any intending purchaser or tenant must satisfy themselves by inspection or otherwise as to the correctness of each of the statements contained in these particulars. The vendor/landlord does not make or give, and neither the agents nor any person in their employment has any authority to make or give any representation or warranty in relation to this property.



SOUTHGATE
ESTATES

50-51 South Street, EX1 1EE

01392 207444

info@southgatestates.co.uk