

2 Bron Llyn, Llanddulas, Abergele, LL22 8JL

£229,950

🛏 2 🚿 1 🛋 1



A Detached bungalow, available with no forwarding chain. Located in Llanddulas, a desirable, coastal village where the A55 expressway is easily accessed, providing an easy commute along the North Wales coast and beyond. The accommodation comprises of a bright lounge, kitchen, two bedrooms, a bathroom, conservatory, and a garage. With a rear garden that offers a peaceful environment and a driveway at the front of the property perfect for off street parking. The nearby larger towns of Abergele and Colwyn bay have train stations, amenities, schools for all ages and supermarkets.

Key Features

- No forward chain
- Two Bedrooms
- Single garage
- Conservatory
- EPC- tbc
- Detached bungalow
- Driveway parking
- A55 expressway easily accessed
- Council Tax - C
- Tenure - Freehold

Approx Gross Internal Area
76 sq m / 814 sq ft

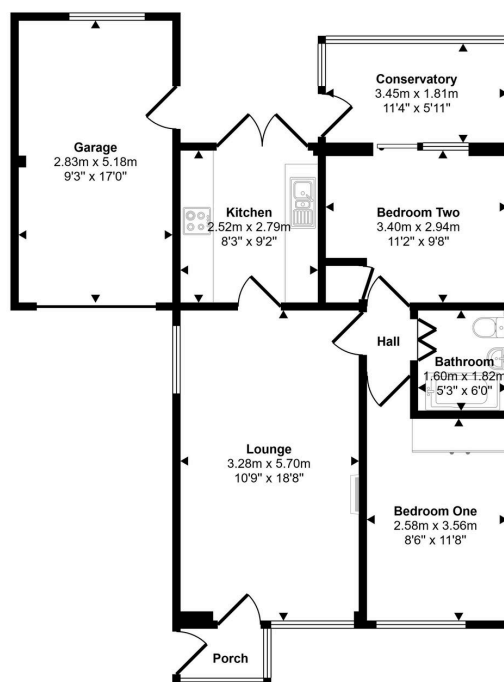

Floorplan

This floorplan is only for illustrative purposes and is not to scale. Measurements of rooms, doors, windows, and any items are approximate and no responsibility is taken for any error, omission or mis-statement. Icons of items such as bathroom suites are representations only and may not look like the real items. Made with Made Snappy 360.

CONSUMER PROTECTION REGULATIONS 2008 AND THE BUSINESS PROTECTION FROM MISLEADING MARKETING REGULATIONS 2008

These particulars, whilst believed to be accurate, are set out for guidance only and do not constitute any part of an offer or contract. Prospective purchasers or tenants should not rely on these particulars as statement or representation of fact, but must satisfy themselves by inspection or otherwise as to their accuracy. No person in the employment of PETER LARGE Estate Agents has the authority to make or give any representation or warranty in relation to the property. Room sizes are approximate and all comments are of the opinion of PETER LARGE Estate agents having carried out a walk through inspection. These sales particulars are prepared under the consumer regulations 2008 and are governed by the business from misleading marketing regulations 2008.