



**The Magpies, Epping Green**

**Asking Price £635,000**



**MILLERS**  
ESTATE AGENTS

\* EXTENDED HOME \* END OF TERRACED HOUSE \*  
 SUPERB MASTER SUITE WITH DRESSING & SHOWER  
 ROOM \* ATTRACTIVE REAR GARDENS \* TWO  
 VEHICLE CAR PORT \* OPEN PLAN KITCHEN  
 BREAKFAST DINER \*

Nestled in the charming village of Epping Green,  
 The Magpies presents a delightful opportunity to  
 own a stunning end terrace character cottage.  
 This property boasts 2 reception rooms, 4  
 bedrooms, and 2 bathrooms, providing ample  
 space for comfortable living.

As you step inside, you are greeted by a cosy  
 front lounge featuring a traditional log burner,  
 perfect for those chilly evenings. The open plan  
 kitchen and breakfast room flow seamlessly into  
 a dining area, illuminated by a roof lantern and  
 large windows that offer picturesque views of  
 the pretty rear garden.

The property's attractive entrance hallway leads  
 to modern amenities such as storage cupboards  
 and a sleek cloakroom/wc and stairs to the  
 upstairs. The first floor accommodates two  
 double bedrooms, a generous single bedroom or  
 office space, and a superb family bathroom.

Venture up to the second floor to discover a  
 remarkable loft conversion that houses a  
 luxurious double bedroom, complete with a  
 dressing area and contemporary En-suite  
 shower. The large windows in this room not only  
 flood the space with natural light but also  
 provide breath-taking views of the garden and  
 stunning countryside surroundings.

The front garden has a shingle area and picket  
 fence, side access to the rear garden. The  
 fabulous rear garden has two patio areas, well  
 established shrubs and flower beds, a delightful  
 summer house, plus a gate leading to open  
 fields.

With a car port offering parking space for 2  
 vehicles, this well-maintained property is in  
 excellent condition throughout, making it a  
 perfect blend of modern comfort and classic  
 charm. Don't miss the chance to make The  
 Magpies your new home in this idyllic village  
 setting.





## GROUND FLOOR

### Cloakroom WC

7' x 5'5" (2.13m x 1.65m)

### Living Room

17'6" x 10'6" (5.33m x 3.21m)

### Kitchen

11'6" x 7'11" (3.51m x 2.42m)

### Kitchen Breakfast Room

11'4" x 18'3" (3.46m x 5.56m)

### Dining Room

11'3" x 12'2" (3.44m x 3.72m)

## FIRST FLOOR

### Bedroom Two

15'0" x 10'10" (4.57m x 3.29m)

### Bedroom Three

12'5" x 10'10" (3.79m x 3.29m)

### Bedroom Four

8'11" x 7'9" (2.72m x 2.35m)

### Bathroom

7'9 x 6'3 (2.36m x 1.91m)

## SECOND FLOOR

### Bedroom One

11'7" x 15'1" (3.52m x 4.60m)

### Dressing Area

7'0" x 5'5" (2.13m x 1.66m)

### En-suite Shower Room

7'1 x 6'8 (2.16m x 2.03m)

## EXTERNAL AREA

### Rear Garden

40'8 x 23'9 (12.40m x 7.24m)

### Car Port with Allocated Parking



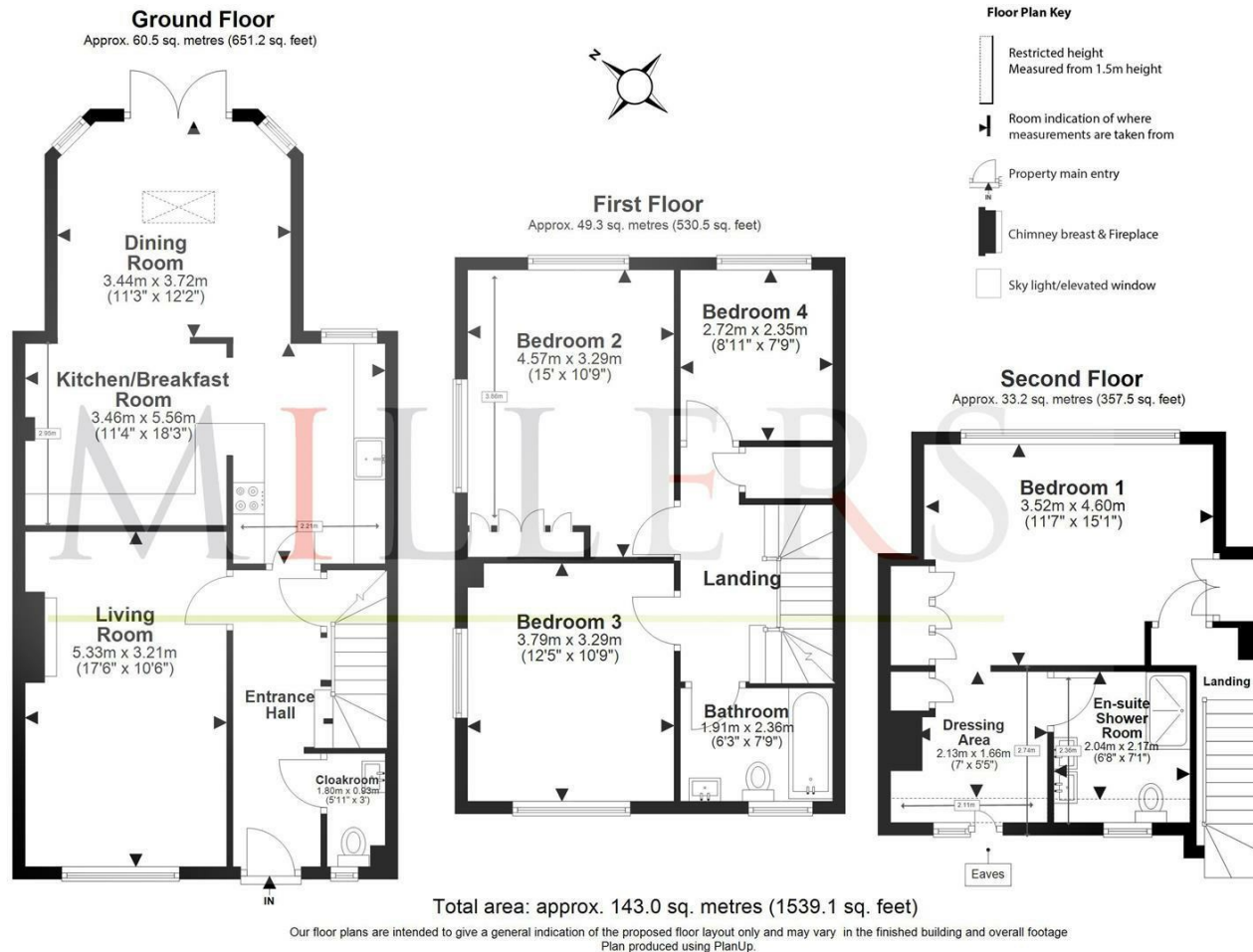

Energy Efficiency Rating			Environmental Impact (CO <sub>2</sub> ) Rating		
	Current	Potential		Current	Potential
Very energy efficient - lower running costs			Very environmentally friendly - lower CO <sub>2</sub> emissions		
(92 plus) A			(92 plus) A		
(81-91) B			(81-91) B		
(69-80) C			(69-80) C		
(55-68) D			(55-68) D		
(39-54) E			(39-54) E		
(21-38) F			(21-38) F		
(1-20) G			(1-20) G		
Not energy efficient - higher running costs			Not environmentally friendly - higher CO <sub>2</sub> emissions		
England & Wales	EU Directive 2002/91/EC		England & Wales	EU Directive 2002/91/EC	
		75		62	
	49			48	

## Viewing

Please contact our Millers Office on 01992 560555  
 if you wish to arrange a viewing appointment for this property or require further information.

These particulars, whilst believed to be accurate are set out as a general outline only for guidance and do not constitute any part of an offer or contract. Intending purchasers should not rely on them as statements of representation of fact, but must satisfy themselves by inspection or otherwise as to their accuracy. No person in this firms employment has the authority to make or give any representation or warranty in respect of the property.