



Seymour Road | | Northfleet | DA11 7BN

£280,000



Seymour Road |  
Northfleet | DA11 7BN  
£280,000

Seymour Road in Northfleet is a fantastic three bedroom family home, close to the popular Perry Street area of Northfleet. The property offers well-proportioned accommodation throughout, offering entrance hall, a bright and spacious living area, fitted kitchen, and three good-sized bedrooms. Externally, the home further benefits from a large garage to the rear, providing valuable parking or additional storage space and a garden.

Conveniently located for local amenities, the property is within easy reach of a number of well-regarded schools making it ideal for families.

For commuters, Gravesend Railway Station is close by and provides high-speed services into London St Pancras, whilst the nearby A2 and M25 offer excellent road links towards London, Bluewater, and the Kent coastline. Regular local bus routes are also nearby.

- CHAIN FREE
- LARGE GARAGE TO REAR WITH ACCESS
- GAS CENTRAL HEATING
- CLOSE TO POPULAR PERRY STREET LOCATION OF NORTHFLEET
- 3 BEDROOM FAMILY HOME
- WELL PRESENTED AND NEUTRAL THROUGHOUT
- EPC BAND D COUNCIL TAX BAND B



Situated within a popular residential development in Gravesend, this well-presented three-bedroom terraced home at 8 Lapis Close, DA12 4UF offers an excellent opportunity for first-time buyers, growing families, and buy-to-let investors alike.

The property provides well-proportioned accommodation throughout, with a bright and spacious living area, fitted kitchen, and three good-sized bedrooms, making it ideal for modern day living. Externally, the home further benefits from a garage to



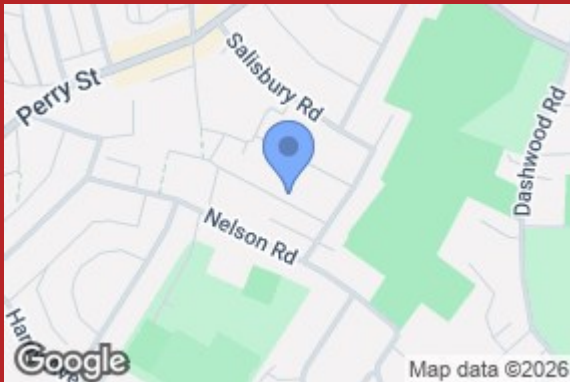
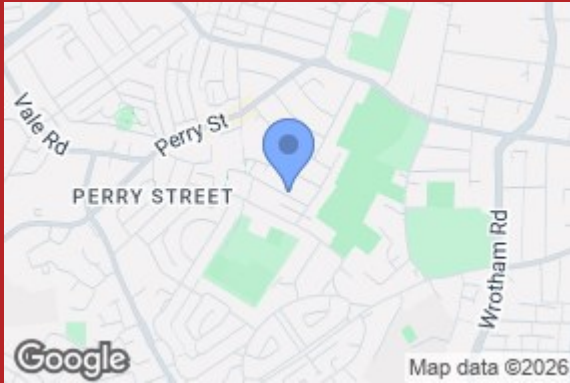

GROUND FLOOR  
407 sq.ft. (37.8 sq.m.) approx.

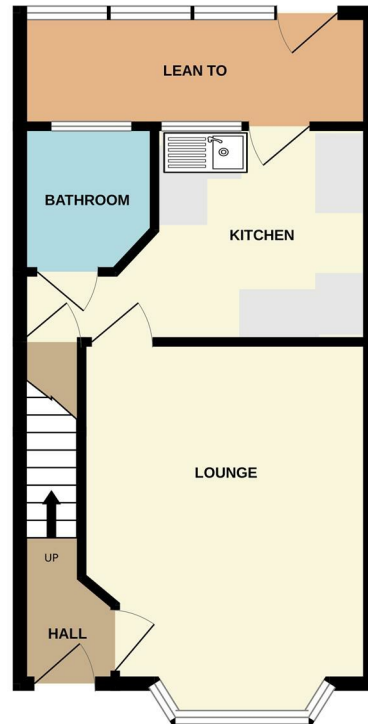

1ST FLOOR  
331 sq.ft. (30.7 sq.m.) approx.



TOTAL FLOOR AREA: 738 sq.ft. (68.5 sq.m.) approx.

Whilst every attempt has been made to ensure the accuracy of the floorplan contained here, measurements of doors, windows, rooms and any other items are approximate and no responsibility is taken for any error, omission or mis-statement. This plan is for illustrative purposes only and should be used as such by any prospective purchaser. The services, systems and appliances shown have not been tested and no guarantee as to their operability or efficiency can be given.  
Made with Metropix ©2026

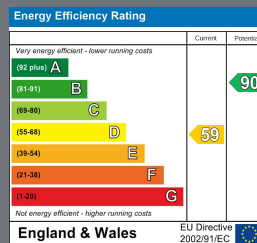

2B Crow Lane  
Rochester  
Kent  
ME1 1RF  
01634 829080

admin@machin-lane.co.uk  
<https://www.machin-lane.co.uk/>