



Egmont Road, KT6

£499,950

A well presented two bedroom ground floor apartment, ideally located within easy reach of Surbiton Station and town centre. The property offers a bright and spacious bay fronted reception room, two well proportioned bedrooms, a separate kitchen and a smart three piece bathroom. Further benefits include a private rear garden, allocated parking and a share of the freehold.

Egmont Road is under a mile from Surbiton town centre, with its array of shops, bars, restaurants and the convenient mainline train station, with efficient links to London Waterloo.

Features

- Ground Floor Apartment
- Two Double Bedrooms
- Private Rear Garden
- Allocated Parking
- Well Presented
- Close To Transport Links

Egmont Road, Surbiton, KT6

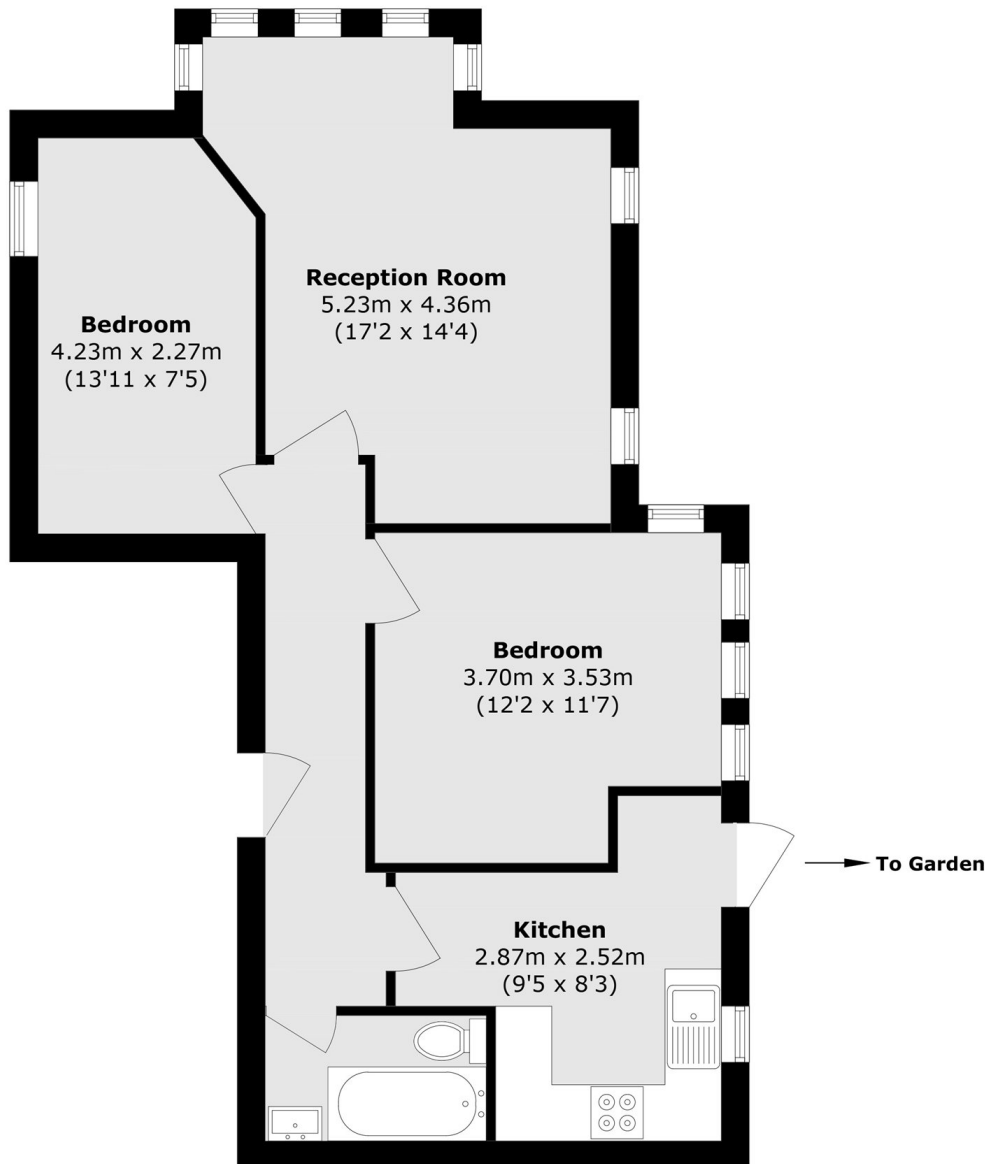

Total area (approx.): 60.5 sq. m (651.2 sq. ft)