



Royal Quarter, KT2

£399,950

Ideally located in the heart of Kingston town centre is this smart two bedroom, two bathroom apartment. Located on the second floor, there is a great south facing balcony off the living room and the development has beautifully maintained communal gardens, 24hr concierge service, entry phone system, secure parking and residents gymnasium.

Dartmouth House is in the sought after 'Royal Quarter' development by St. George Plc. Just 0.2 miles to Kingston town centre, the mainline station and comprehensive shopping facilities include a selection of large departmental stores and a daily market. The Royal Borough is well known for its educational facilities while nearby recreational pursuits include River Thames, Canbury Gardens, Richmond Park and a choice of riverside bars/restaurants.

Features

- Two Bedrooms
- Two Bathrooms
- Private Balcony
- Secure Gated Development
- Private Parking
- No Onward Chain

Royal Quarter, Kingston Upon Thames, KT2

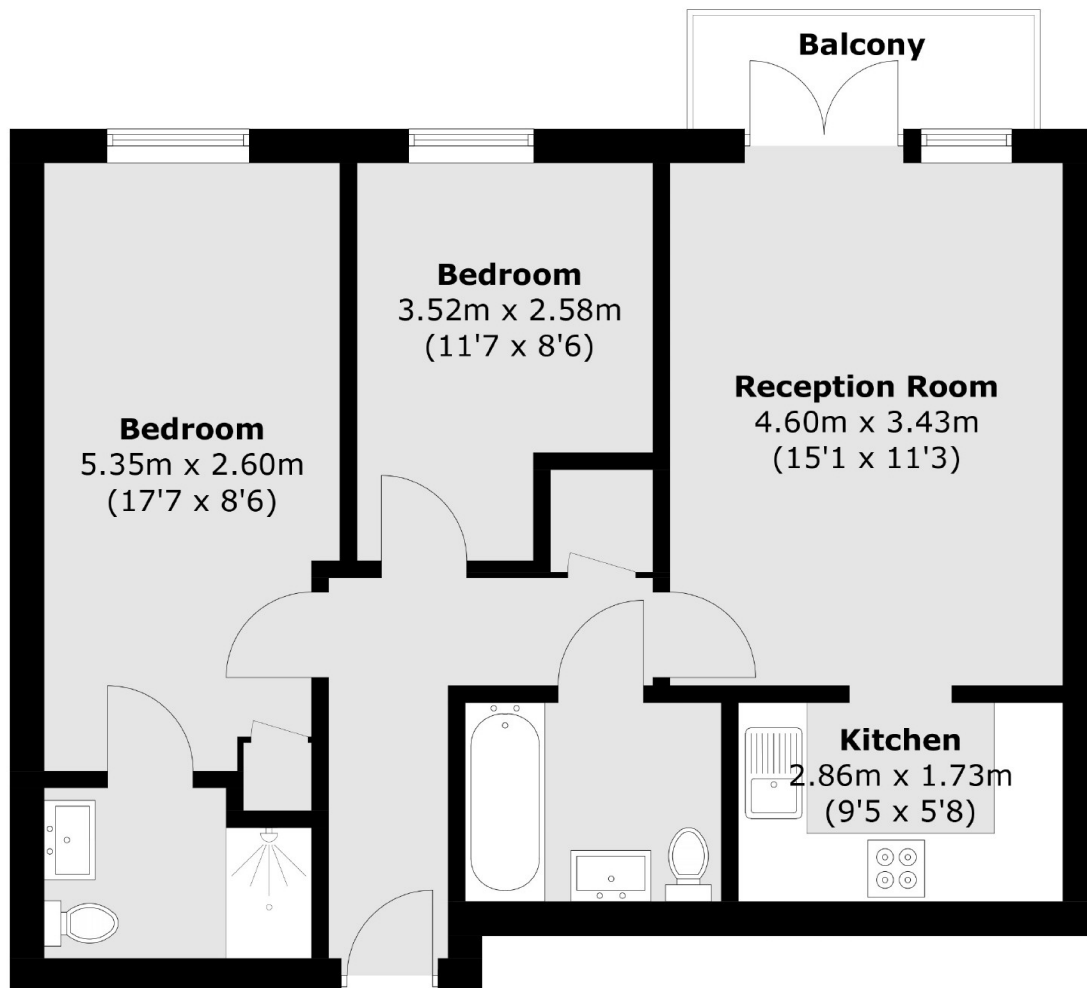

Floor area (approx.): 60.3 sq. m (649.1 sq. ft)
Balcony area (approx.): 3.0 sq. m (32.3 sq. ft)