

GROSS INTERNAL AREA
TOTAL: 68 m²/728 sq ft
FLOOR 1: 34 m²/364 sq ft
FLOOR 2: 34 m²/364 sq ft
SIZE AND DIMENSIONS ARE APPROXIMATE, ACTUAL MAY VARY

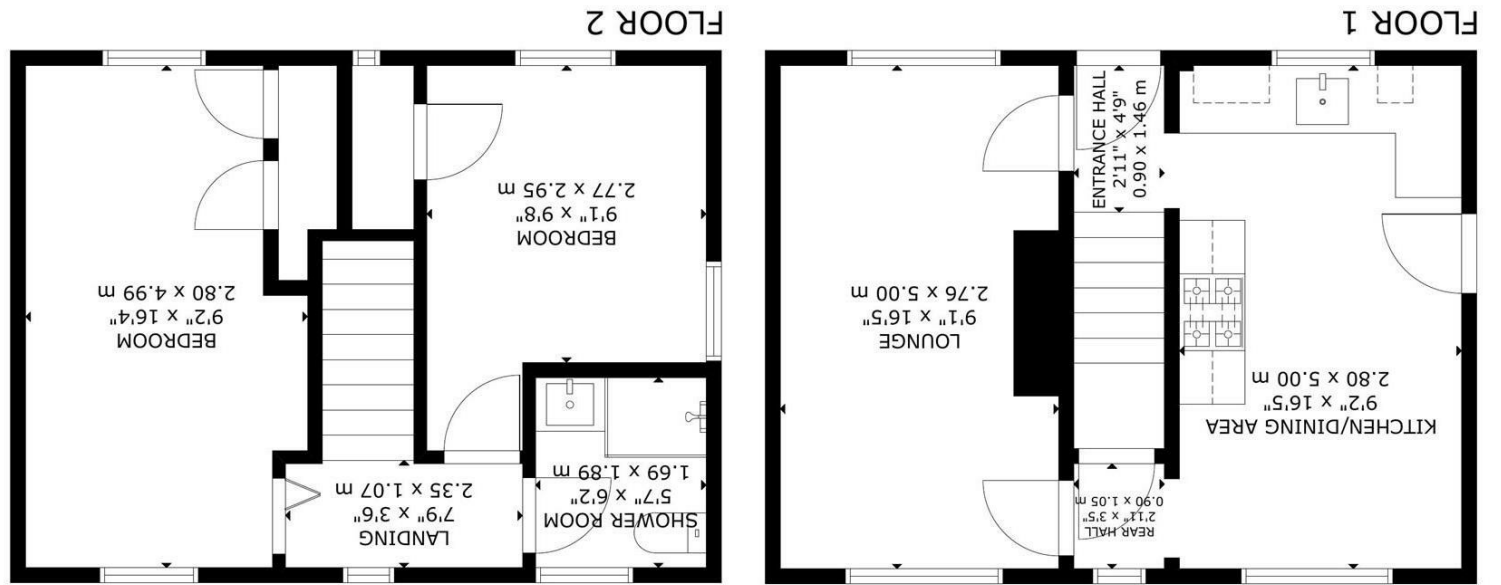

Energy Efficiency Rating	
England & Wales	
Not energy efficient - higher running costs	Very energy efficient - lower running costs
A (85-91)	F (23-34)
B (81-84)	G (1-20)
C (69-80)	
D (54-68)	
E (39-53)	
F (23-34)	
G (1-20)	
70	85
Current	Potential

Archery Walk, Hailsham

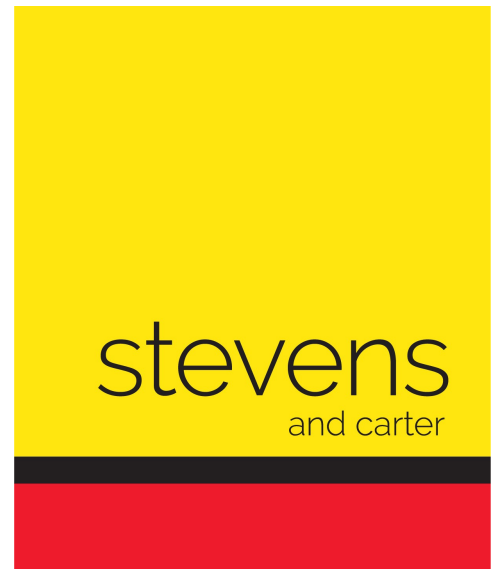

- 3D Virtual Tour
- Semi Detached House
- Close Proximity To Town Centre
- Lounge
- Kitchen/Dining Room
- Two Bedrooms
- Shower Room/WC
- Front and Rear Gardens
- No Onward Chain
- Viewing Advised



Freehold

£240,000

2 BEDROOM 1 RECEPTION 1 BATHROOM 0 GARAGE

Archery Walk, Hailsham

Archery Walk, Hailsham

DESCRIPTION

3D Virtual Tour | No Onward Chain | Semi Detached House | Lounge | Kitchen/Dining Room | Two Bedrooms | Shower Room/WC | Viewing Advised |

Stevens and Carter Estate Agents are pleased to bring to the market this semi detached house situated in this popular and convenient location. Positioned within walking distance to the Town Centre with its array of shops, cafes and bus routes to further afield it is one not to miss.

Upon entry, the hallway provides access to all principle rooms. The dual aspect lounge offers space for your soft furnishings and has the potential to have patio doors installed to the rear which would make a great feature to the room. The kitchen dining room lies adjacent and benefits from cupboards for storage, work surfaces and space for your appliances. There is also ample space for a good size dining table and chairs. Windows and doors overlook and afford access onto the rear garden. On the first floor you will find two double bedrooms, both of which offer ample space for your associated bedroom furniture and are serviced by a shower room which comprises of a large shower cubicle, wash basin and WC.

Externally there are front and rear gardens which are mainly laid to lawn with areas for planting alongside a brick built shed which is ideal for storage. This home is being sold with no onward chain too so moving could be quicker than you think!

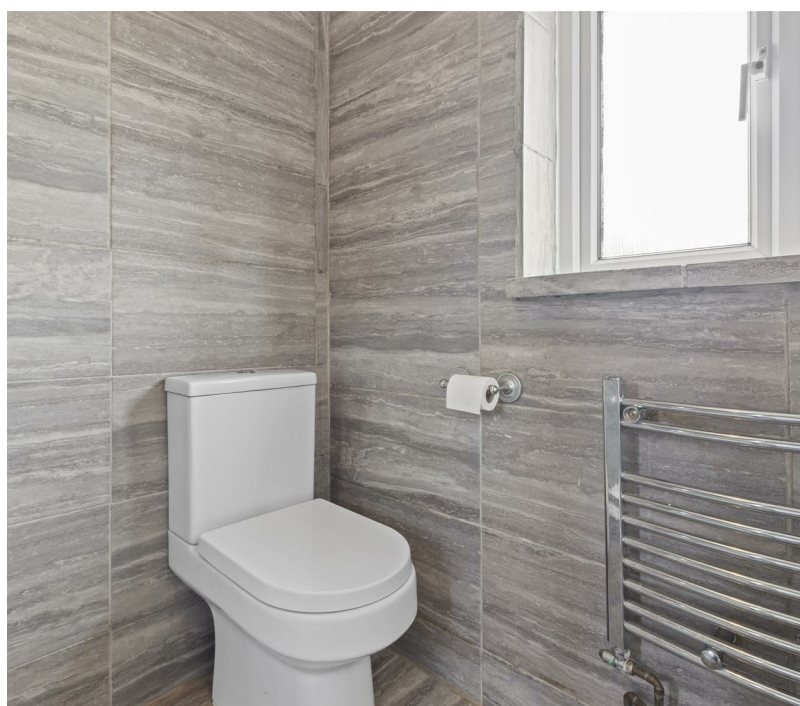

Archery Walk, Hailsham

Entrance Hall 1.45m x 0.89m (4'9 x 2'11)

Lounge 5.00m x 2.77m (16'5 x 9'1)

Kitchen/Dining Room 5.00m x 2.06m (16'5 x 6'9)

Rear Hall 1.04m x 0.89m (3'5 x 2'11)

First Floor Landing 2.36m x 1.07m (7'9 x 3'6)

Bedroom One 4.98m x 2.79m (16'4 x 9'2)

Bedroom Two 2.95m x 2.77m (9'8 x 9'1)

Shower Room/WC 1.88m x 1.70m (6'2 x 5'7)

Front & Rear Gardens

No Onward Chain