

Towers Wills

Town & Country

📞 01935 577 032 | 01460 298 530 | ✉ info@towerswills.co.uk



53, Kingfisher Drive, Yeovil, Somerset BA22 8GG

£220,000

Towers Wills are delighted to welcome to the market this exceptional two-bedroomed coach house, situated within the popular Agusta Park development set on the desirable western side of Yeovil. This contemporary home places you within easy reach of Leonardo Helicopters, Yeovil Town Centre, and nearby countryside walks—perfect for balancing work, leisure, and relaxation.

Accommodation:

The property offers well-proportioned and beautifully maintained accommodation throughout, making this an ideal purchase for first-time buyers, investors or those seeking a low-maintenance home in a desirable location.

The property comprises a generous open-plan living, kitchen and dining area, creating a bright and sociable space ideal for modern living with the kitchen offering modern appliances. There are two good-sized double bedrooms, both served by a contemporary family bathroom fitted with modern fixtures and fittings.

The home has been extremely well cared for by the current owner and further benefits from the remainder of an NHBC warranty, offering peace of mind to prospective purchasers.

Outside:

Externally, the property benefits from one allocated parking space to the front, along with a single garage providing additional storage or secure parking. The garage also offers rear access via a pedestrian offering convenience for modern living. The property is positioned within a tucked away corner of Kingfisher Drive, offering a good degree of privacy and seclusion.

Viewing is highly recommended to fully appreciate the quality and presentation of this lovely home within a sought-after development.

Key Features

- Well Presented Throughout
- Popular Agusta Park Development
- Coach House
- Two Bedrooms
- Garage & Parking

Contact Us

Towers Wills Estate Agents - Yeovil
114, Hendford Hill
Yeovil
Somerset
BA202RF
T: 01935 577032
E: info@towerswills.co.uk

Energy Efficiency

Score	Energy rating	Current	Potential
92+	A		
81-91	B	81 B	81 B
69-80	C		
55-68	D		
39-54	E		
21-38	F		
1-20	G		



Floor Plan

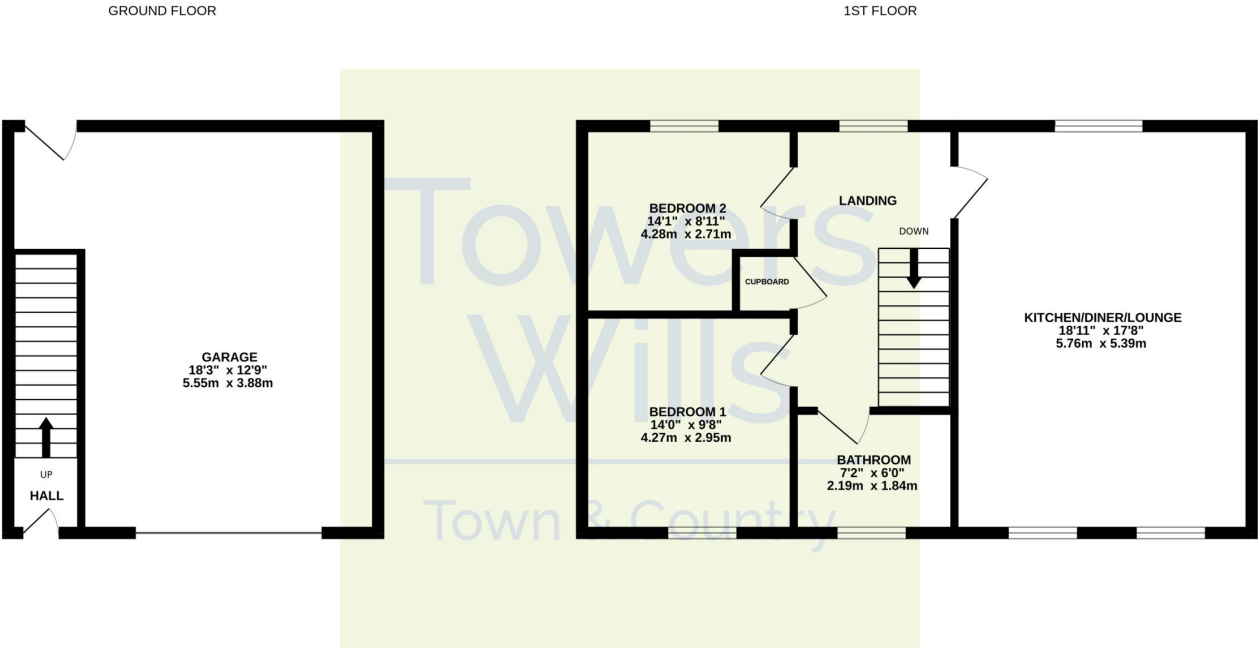

Whilst every attempt has been made to ensure the accuracy of the floorplan contained here, measurements of doors, windows, rooms and any other items are approximate and no responsibility is taken for any error, omission or mis-statement. This plan is for illustrative purposes only and should be used as such by any prospective purchaser. The services, systems and appliances shown have not been tested and no guarantee as to their operability or efficiency can be given.
Made with Metropix ©2026

Please Note No tests have been undertaken of any of the services and any intending purchasers should satisfy themselves in this regard. Towers Wills Ltd for themselves and for the vendor of this property whose agents they are, give notice that, (i) these particulars do not constitute any part of an offer or contract, (ii) all statements contained within these particulars are made without responsibility on the part of Towers Wills or the vendor , (iii) whilst made in good faith, none of the statements contained within these particulars are to be relied upon as a statement of representation or fact , (iv) any intending purchaser must satisfy him/herself by inspection or otherwise as to the correctness of each of the statements contained within these particulars, (v) the vendor does not make or give either Towers Wills or any person in their employment any authority to make or give representation or warranty whatsoever in relation to this property.

Photographs / Floor Plans Photographs are reproduced for general information and it must not be inferred that any item is included for sale with this property. Please note floor plans are not to scale and are for identification purposes only. The photographs used in these particulars may have been taken with the use of a wide angle lens. If you have any queries as to the size of the accommodation or plot, please address these with the agent prior to making an appointment to view

Towers Wills

The White House, 114 Hendford Hill, Yeovil BA20 2RF

Yeovil 01935 577032 / South Petherton 01460 298530

info@towerswills.co.uk | www.towerswills.co.uk