

SIMPLY GREEN

Highweek Road, Newton Abbot, TQ12 1TN

Newton Abbot

Beds: 3 Baths: 1 Recepts: 1

This charming period three-bedroom terraced home is ideally situated in the ever-popular Highweek Road area of Newton Abbot. Offering generous and well-proportioned accommodation throughout, the property comprises a welcoming lounge, a separate dining room, a fitted kitchen, a family bathroom, and three spacious bedrooms. To the rear, there is an enclosed courtyard garden, providing a low-maintenance outdoor space perfect for relaxing or entertaining. The property is conveniently located within easy walking distance of Newton Abbot town centre, where a wide range of amenities can be found, including shops, well-regarded schools, scenic walks, and various community facilities. This home presents an excellent opportunity for families, first-time buyers, or investors seeking a well-located and characterful property.

Location

Highweek Road in Newton Abbot is a well-established residential location, ideally positioned for convenient access to the town centre. The property is within walking distance from the heart of Newton Abbot, placing a wide range of shops, cafés, restaurants and amenities within easy walking distance. The area is well-served by everyday conveniences, with supermarkets, local shops and green spaces all close by, making it particularly practical for day-to-day living.

Highweek is especially attractive for families, with a strong selection of nearby schools including Highweek Community Primary and Nursery School and Newton Abbot College, many of which are within walking distance.

Overall, the location offers a great balance of a quiet residential setting with excellent accessibility, making it ideal for families, commuters and first-time buyers alike.





Ground Floor Accommodation

The ground floor offers well-proportioned and versatile living accommodation, beginning with a spacious lounge featuring attractive period details, including a cast iron fireplace with decorative mantel, creating a warm and inviting focal point.

This leads seamlessly into a generous dining room, ideal for both everyday living and entertaining. Both rooms benefit from excellent natural light, with windows to the front and rear. The dining area also provides ample built-in storage, with cupboards set into the alcoves as well as additional under-stairs storage.

The kitchen is arranged in a practical U-shaped layout, offering a range of maple-fronted units and ample worktop space, making it both functional and well-suited to modern living. A door from the kitchen provides direct access to the enclosed rear courtyard garden.

Completing the ground floor is a conveniently located family bathroom, accessible from all areas of the home. Currently configured as a wet room, it is fitted with a walk-in shower, bath, WC, and wash hand basin.

First Floor Accommodation

Upstairs, the property offers three well-proportioned bedrooms. The principal bedroom is particularly spacious, featuring a large window that fills the room with natural light, along with an attractive cast iron fireplace and mantel serving as a charming focal point. The room is tastefully presented in a modern blue décor and provides ample space for a double bed along with additional furnishings.

Bedrooms two and three are also generously sized double rooms, making them ideal for family living, guest accommodation, or flexible use such as a home office.

External Features

To the front of the property, there is ample on-street parking, along with an attractive brick façade that reflects the home's period origins, dating back to circa 1890. The property stands as a fine example of its era, full of character and charm.

To the rear, a low-maintenance courtyard garden provides a practical outdoor space, complemented by an external shed offering useful storage. A rear access gate leads to a service lane, adding further convenience.

Services

Mains Electricity
Mains Gas
Mains Water
Mains Drainage

Local Authority

Teignbridge District Council

Viewings

To view this property, please call us and we will arrange a time that suits you.





GROUND FLOOR

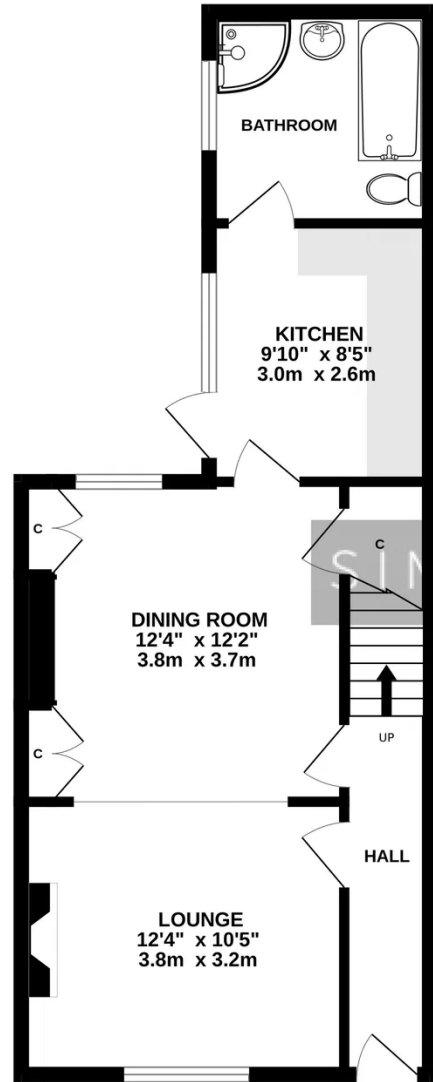

1ST FLOOR

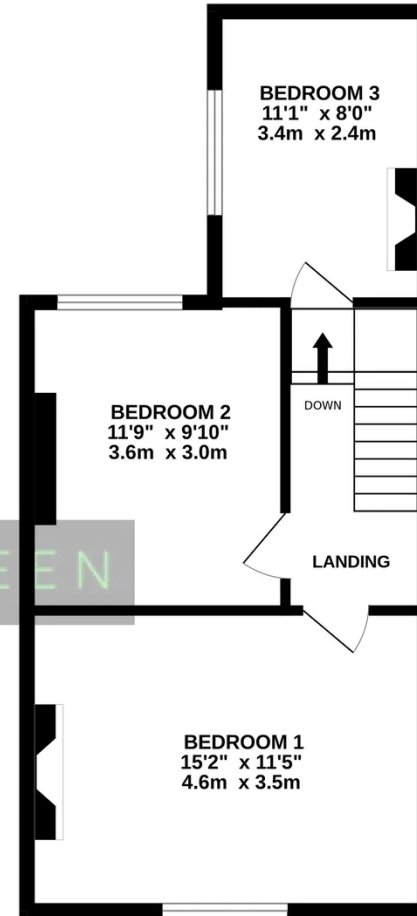

SIMPLY GREEN

Whilst every attempt has been made to ensure the accuracy of the floorplan contained here, measurements of doors, windows, rooms and any other items are approximate and no responsibility is taken for any error, omission or mis-statement. This plan is for illustrative purposes only and should be used as such by any prospective purchaser. The services, systems and appliances shown have not been tested and no guarantee as to their operability or efficiency can be given.
Made with Metropix ©2026