

DISTINCTIVE  
HOMES  
by



# The Tower House

Newcastle Drive, NG7 1AA

# The Tower House

Newcastle Drive, NG7 1AA

Nestled within the highly sought-after and prestigious Park Estate, this striking contemporary residence enjoys an elevated and commanding position, while benefiting from easy access to Nottingham's vibrant city centre, renowned for its eclectic mix of shops, bars, restaurants, mainline train station and historic castle. The location perfectly blends exclusivity and convenience.

[www.fhpliving.co.uk](http://www.fhpliving.co.uk)





This distinctive property offers stylish accommodation arranged over several floors, thoughtfully designed to maximise light, space and modern living. The specification is of a good standard throughout with contemporary finishes.

The accommodation briefly comprises: an impressive entrance hall with engineered wood flooring and personal door providing access to the integral garage. An inner hallway with attractive engineered wood flooring leads to a boot room, separate WC and well-appointed utility room fitted with storage units and an integrated washing machine. The property benefits from an integral garage with light and power, in addition to a further garage with electronic operated roller door and lighting, providing parking for up to three vehicles and a generous storage area.

To the first floor there is a superb, spacious lounge with engineered wood flooring and ceiling downlights, creating a sleek and elegant living environment. Bi-folding doors open onto the terrace and landscaped garden, providing excellent indoor-outdoor flow. The lounge is open plan to the contemporary kitchen, fitted with a range of modern units, glass worktops and splashbacks, and a range of integrated appliances including fridge/freezer, oven, microwave and dishwasher. A central island with quartz worksurface and large hob offers an ideal space for both cooking and entertaining.





The second floor offers a landing area with walk-in storage room. Bedroom two enjoys double-aspect windows and a modern en-suite shower room. Bedroom three also features its own stylish en-suite shower room, making this level ideal for guests or family members.

The third floor is dedicated to an impressive master bedroom suite, boasting a vaulted ceiling, double-aspect windows and an abundance of natural light. This exceptional space includes a luxurious walk-in wardrobe with fitted dressing table and drawers. The opulent en-suite bathroom is fitted with bath and a separate shower, accessed via opaque glass door and side panels, creating a spa-like retreat.

Outside, the property is complemented by landscaped gardens featuring a terrace ideal for alfresco dining, areas of lawn and established, mature planted beds, providing an attractive outlook.

This is a rare opportunity to acquire a high-quality home within one of Nottingham's most desirable residential locations, offering generous accommodation, stylish presentation and excellent access to the city centre.





Approx. 122.6 sq. metres (1319.7 sq. feet)



### First Floor

Approx. 51.0 sq. metres (548.8 sq. feet)

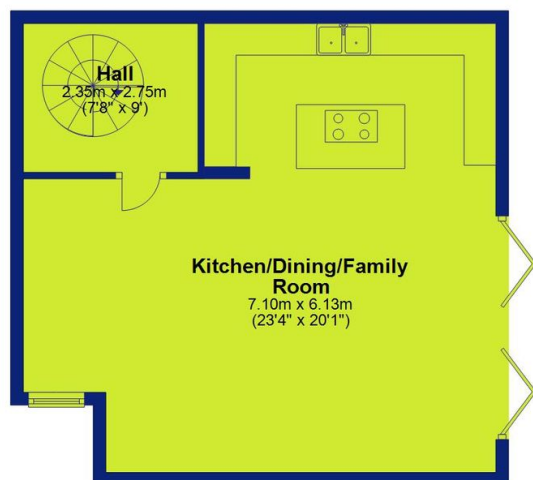

### Second Floor

Approx. 51.8 sq. metres (557.6 sq. feet)



### Third Floor

Approx. 48.7 sq. metres (523.9 sq. feet)





DISTINCTIVE  
HOMES  
by



## Distinctive Homes by FHP Living

A collection of some of the best properties available in the most sought-after areas of Nottingham, and its surrounding suburbs and villages.

[www.fhpliving.co.uk](http://www.fhpliving.co.uk)

Score	Energy rating	Current	Potential
92+	A		
81-91	B		
69-80	C		
55-68	D		
39-54	E		
21-38	F		
1-20	G		
		76 C	83 B

FHP, their clients and joint agents give notice that:

1. They are not authorised to make or give any representations or warranties in relation to the property either here or elsewhere, either on their own behalf of their client or otherwise. They assume no responsibility for any statement that may be made in these particulars. These particulars do not form part of any offer or contact and must not be relied upon as statements or representations of fact.
2. Any areas, measurements or distances are approximate. The text, photographs and plans are for guidance only and are not necessarily comprehensive. It should not be assumed that the property has all necessary planning, building regulation or other consents and FHP have not tested any service, equipment or facilities. Purchasers must satisfy themselves by inspection or otherwise. Figures quoted in these particulars may be subject to VAT in addition. 09/11



## Interested in this home?

Call the FHP Living Distinctive Homes Team



**Jason Cook**  
Mobile: 07876 396 010  
[jason@fhpliving.co.uk](mailto:jason@fhpliving.co.uk)

**T: 0115 841 1155**

23 Bridgford Road  
West Bridgford  
Nottingham NG2 6AU

1 Weekday Cross  
The Lace Market  
Nottingham NG1 2GB