



Dovecote House

Water Gardens Square, SE16

£400 per week
(£1,733.33 pcm)

Well-proportioned 2 bedroom, two bathrooms apartment located on a first floor. The property comprises open plan reception/kitchen area, comes furnished and with secure car parking space.



Dovecote House

Water Gardens Square, SE16

- Two Double Bedrooms
- Two Bathrooms
- Close to Canada Water Station
- Great Communal Garden
- Secure Car Park
- 24hours Concierge



Well-proportioned 2 bedroom, two bathrooms apartment located on a first floor. The property comprises open plan reception/kitchen area, comes furnished and with secure car parking space.

Canada Water & Rotherhithe are charming areas situated south of the river Thames. The area is well connected via Canada Water, Surrey Quays and Rotherhithe stations as-well as the river taxi making The City and Canary Wharf easily accessible. Although residents can enjoy walks along the banks of the river to Shad Thames which is home to array of bars and restaurants, the area also boasts many of its own amenities including Surrey Quays shopping centre and cinema.

Tenure: To be advised

Furnished

Additional tenant charges apply (fees apply to non-AST tenancies only)
 Tenancy Agreement Fee: £300
 References per Tenant/Guarantor: £60
 Inventory check (approx. £100 – £250 inc. VAT)
[chestertons.com/property-to-rent/applicable-fees](https://www.chestertons.com/property-to-rent/applicable-fees)

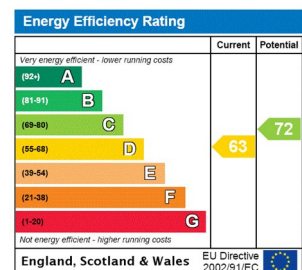

Chestertons Tower Bridge Lettings

220 Tower Bridge Road
 Tower Bridge
 London
 SE1 2UP
lettings.towerbridge@chestertons.com
 02073576911
[chestertons.com](https://www.chestertons.com)

Dovecote House, SE16

Approx. Gross Internal Area 861 Sq Ft - 79.99 Sq M

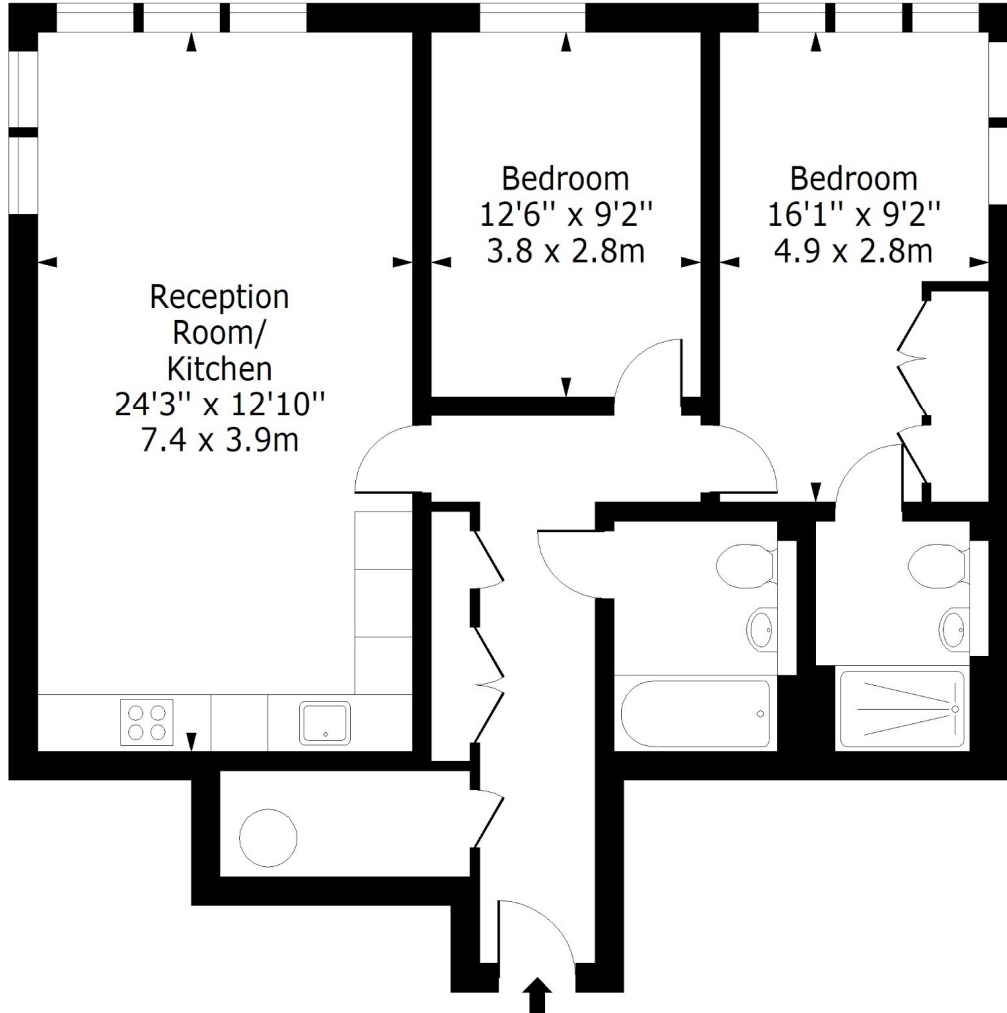

First Floor

Floor Area 861 Sq Ft - 79.99 Sq M

For Illustration Purposes Only - Not To Scale

www.lpaplus.com