



CHERRY TREE COTTAGE

120 Duke Street, Micheldever



CHERRY TREE COTTAGE

120 Duke Street,
Micheldever, SO21 3DF

A delightful, well presented 3-bedroom semi-detached thatched cottage located in Micheldever, close to Winchester

Winchester 7.4 miles
Basingstoke 14 miles
Micheldever Station 2.6 miles
London Waterloo from Micheldever Station - 1 hour
(Mileages and times approximate)



CHERRY TREE COTTAGE

Nestled in the picturesque village of Micheldever, this delightful semi-detached cottage on Duke Street offers an exceptional blend of character, comfort, and modern living. Extending to approximately 1,526 sq ft, the home provides generous and versatile accommodation throughout.

At the heart of the property is a stunning open-plan kitchen, dining, and living area—a bright and spacious environment perfect for everyday family life and entertaining. The sitting area is beautifully enhanced by a cosy wood-burning stove, while the well-appointed kitchen offers both style and practicality. In addition, there is a further reception room/dining room and downstairs WC.

The property features three well-proportioned bedrooms. The impressive principal bedroom is a standout, boasting a luxurious en suite bathroom with both bath and shower facilities. Two further bedrooms are served by a contemporary family bathroom, making this home ideally suited for families or those requiring guest accommodation.

Externally, the property continues to impress. There is ample off-road parking, and the attractive wraparound garden, primarily laid to lawn with a terrace area by the house. This offers a wonderful outdoor space for enjoying the surroundings, entertaining, or family activities.

SITUATION

Micheldever is a highly sought-after Hampshire village, prized for its picturesque rural surroundings, strong sense of community, and excellent connectivity. The village itself offers a selection of amenities including a well-regarded public house, a primary school rated 'Good' by Ofsted, a historic church, village hall and playing fields.

The area is particularly well positioned for access to the nearby cathedral city of Winchester and the commercial centre of Basingstoke, both of which provide an extensive range of shopping, leisure, and cultural facilities.

There is an excellent choice of schooling in the vicinity. In addition to the village primary school, state options include The Henry Beaufort School in Winchester and the highly regarded Peter Symonds' Sixth Form College. The area is also served by a number of prestigious independent schools, including Princes Mead, Twyford School, St Swithun's School, and Winchester College.

Communications are superb, with the A34, A303, and M3 all within easy reach, providing convenient road links across the region. For commuters, Winchester and Basingstoke both offer mainline railway services to London, while nearby Micheldever Station provides direct access to London Waterloo, making it an ideal location for those balancing rural living with city access.

GENERAL REMARKS

Method of Sale

The property is offered for sale by private treaty.

Services

Mains water, electricity and private drainage. Oil fired central heating. The property has an EV Charger.

Broadband availability

Fibre to cabinet available (Openreach).

Mobile Phone Coverage

Good phone coverage available (Ofcom).

EPC

D63

Tenure

Freehold with vacant possession.

Local Authority

Winchester City Council. Band D.

Parking

Private parking.

Construction

Thatched roof. Re thatching is booked in for summer 2026.

IMPORTANT NOTICE

BCM Wilson Hill for themselves and the Vendors or lessors of this property whose agents they are, give notice that:

- These particulars have been prepared in good faith to give a fair overall view of the property, do not form any part of an offer or contract, and must not be relied upon as statements or representations of fact.
- Purchasers must rely on their own enquiries by inspections or otherwise on all matters including planning or other consents.
- The information in these particulars is given without responsibility on the part of BCM Wilson Hill or their clients. Neither BCM Wilson Hill nor their employees have any authority to make or give any representations or warranties whatever in relation to this property.
- Any areas, measurements or distances referred to are given as a guide only and are not precise. Photographs are not necessarily comprehensive nor current; no assumption should be made that any contents shown are included in the sale nor with regards to parts of the property which have not been photographed.
- Nothing in these particulars should be deemed to be a statement that the property is in good structural condition or that any services or equipment are in good working order - nor have BCM Wilson Hill tested them.

Restrictions

Conservation Area.

Directions

From Winchester take the A33 heading north towards Basingstoke. After the first dual carriageway, take the first turning on the right signposted to Micheldever. At the end of the road, turn right. Proceed along the lane, passing the playing fields on the left. Cherry Tree Cottage is the next property on the left, after the playing fields.

/// what3words

///able.pancakes.snoozing

Viewings

By appointment with BCM LLP only.

Selling Agent

Tom Woods

The Old Dairy, Sutton Scotney, Winchester SO21 3NZ

t: 01962 763905

e: twoods@bcmwilsonhill.co.uk

NB: These particulars are as at June 2026.

Cherry Tree Cottage, Duke Street, Micheldever, Winchester

Approximate Gross Internal Area
1,526 sq ft / 142 sq m

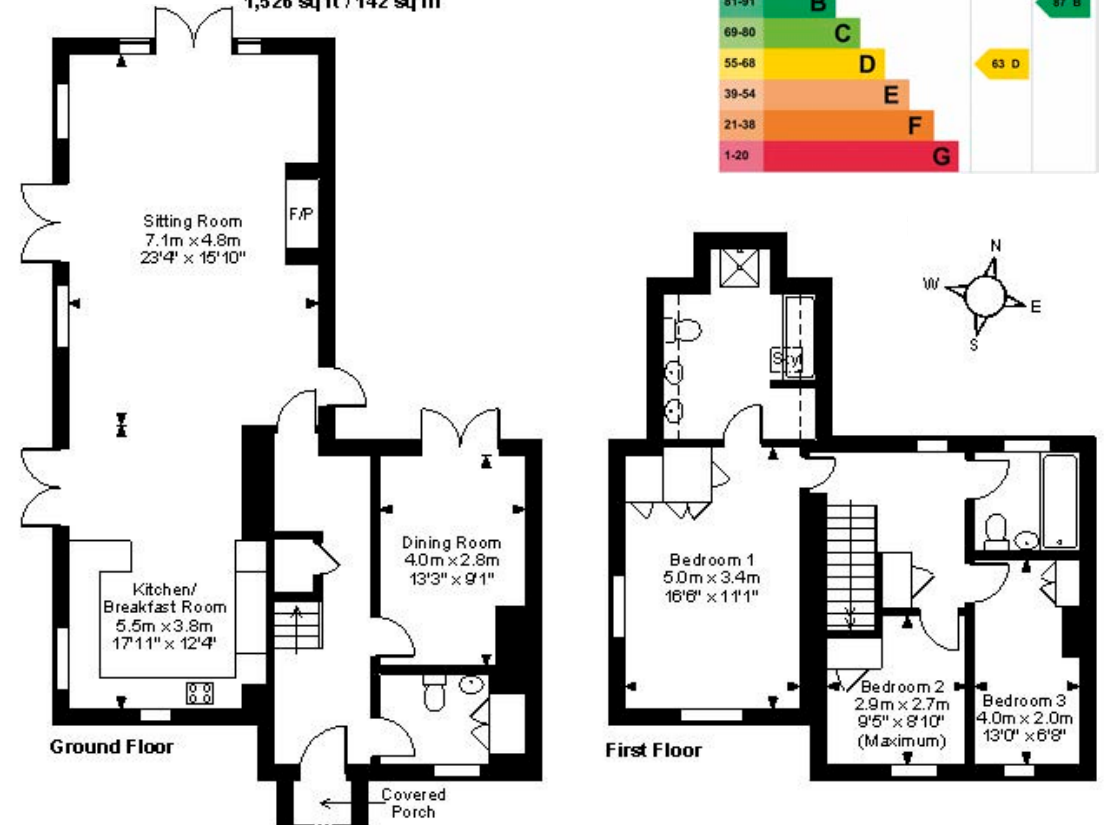

Winchester

01962 763 900

winchester@bcmwilsonhill.co.uk

Further offices at: Petersfield | Isle of Wight | Oxford

bcmwilsonhill.co.uk

