

## Tamworth Lane, CR4

£2,400 Per calendar month

This attractive four double-bedroom house has been neutrally decorated throughout and offers well-proportioned accommodation ideal for family living. The property comprises a bright and spacious reception room, a separate modern kitchen, four bedrooms, two bathrooms and a private garden.

Tamworth Lane is conveniently situated within close proximity to excellent local transport links, including numerous bus routes and rail services from Mitcham Eastfields Station, providing easy access to Central London and surrounding areas.

### Features

- Four Bedrooms
- Private Garden
- Modern Kitchen
- Modern Bathroom
- Two Bathrooms
- Great Transport Links

# Tamworth Lane, Mitcham, CR4

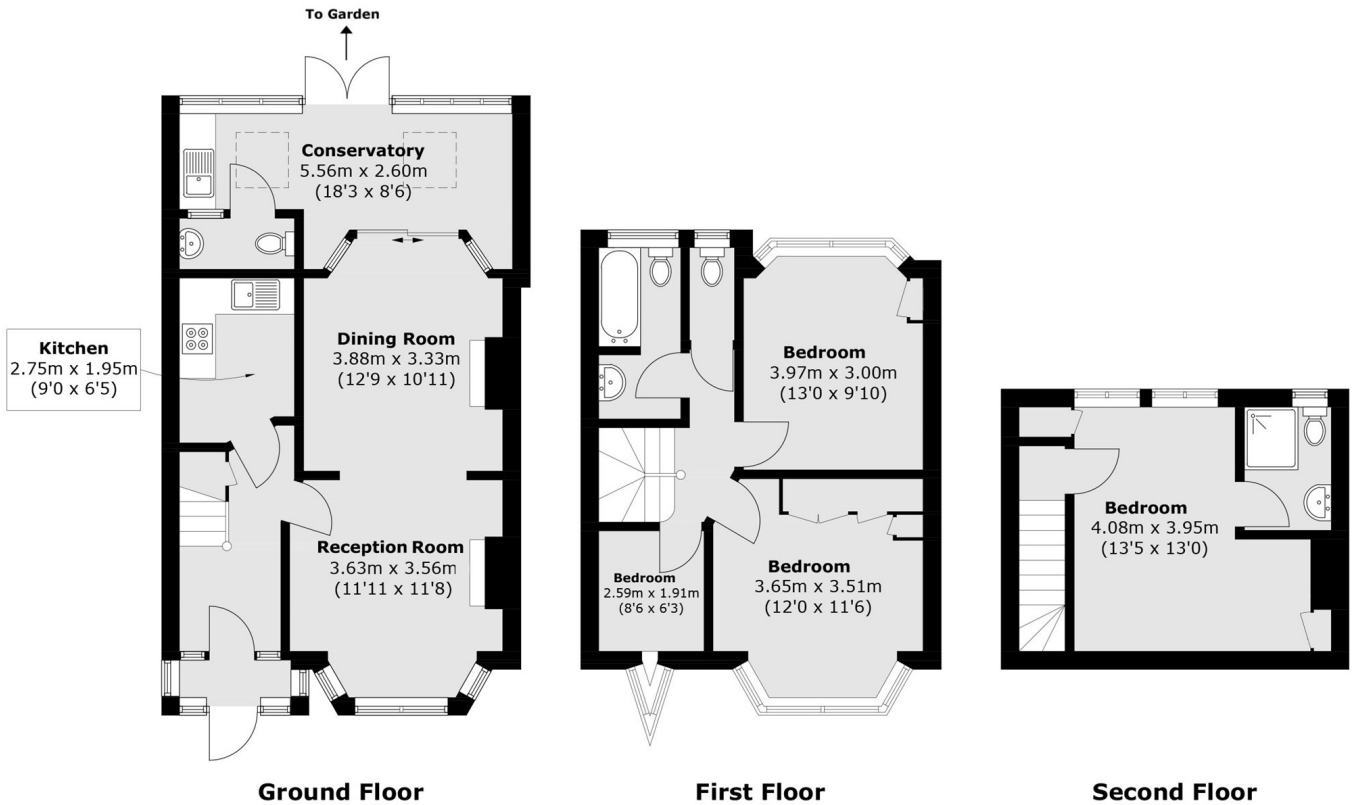

Total area (approx.): 111 sq. m (1,194.8 sq. ft)