



# Logan House

1 Logan Place, W8

£2,275 per month  
(£525 per week)

Introducing a sleek newly constructed contemporary studio flat, this modern space boasts immaculate finishes and convenient amenities. Situated within a newly constructed residential block on a quiet residential street, this ground floor unit offers

**CHESTERTONS**



# Logan House

1 Logan Place, W8

-



**Minimum Term:** 6 months  
**Deposit Required:** £2,625.00  
**Local Authority:** Royal Borough of Kensington & Chelsea  
**Council Tax Band:** G  
**EPC Rating:** B  
**Furnished, Part Furnished, Unfurnished**

Energy Efficiency Rating		Current	Potential
Very energy efficient - lower running costs			
(92-100)	A		
(81-91)	B	81	81
(69-80)	C		
(55-68)	D		
(39-54)	E		
(21-38)	F		
(1-20)	G		
Not energy efficient - higher running costs			
England, Scotland & Wales		EU Directive 2002/91/EC	

### Chestertons Kensington Lettings

116 Kensington High Street  
 Kensington  
 London  
 W8 7RW  
 kensington@chestertons.co.uk  
 02079377260  
 chestertons.co.uk

Additional tenant charges apply (fees apply to non-AST tenancies only)  
 Tenancy Agreement Fee: £300  
 References per Tenant/Guarantor: £60  
 Inventory check (approx. £100 – £250 inc. VAT)  
[chestertons.co.uk/property-to-rent/applicable-fees](http://chestertons.co.uk/property-to-rent/applicable-fees)

# Logan House, Logan Place, W8

Approximate gross internal area

41.99 sq m / 452 sq ft

Key :  
CH - Ceiling Height

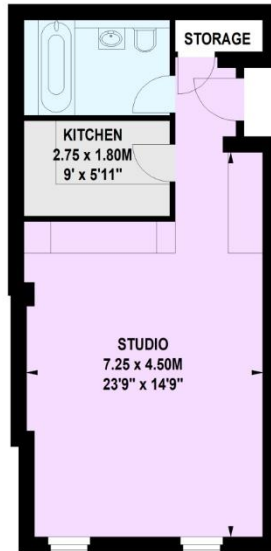

**Ground Floor**

Not to scale, for guidance only and must not be relied upon as a statement of fact.  
All measurements and areas are approximate only

