

Floorplan

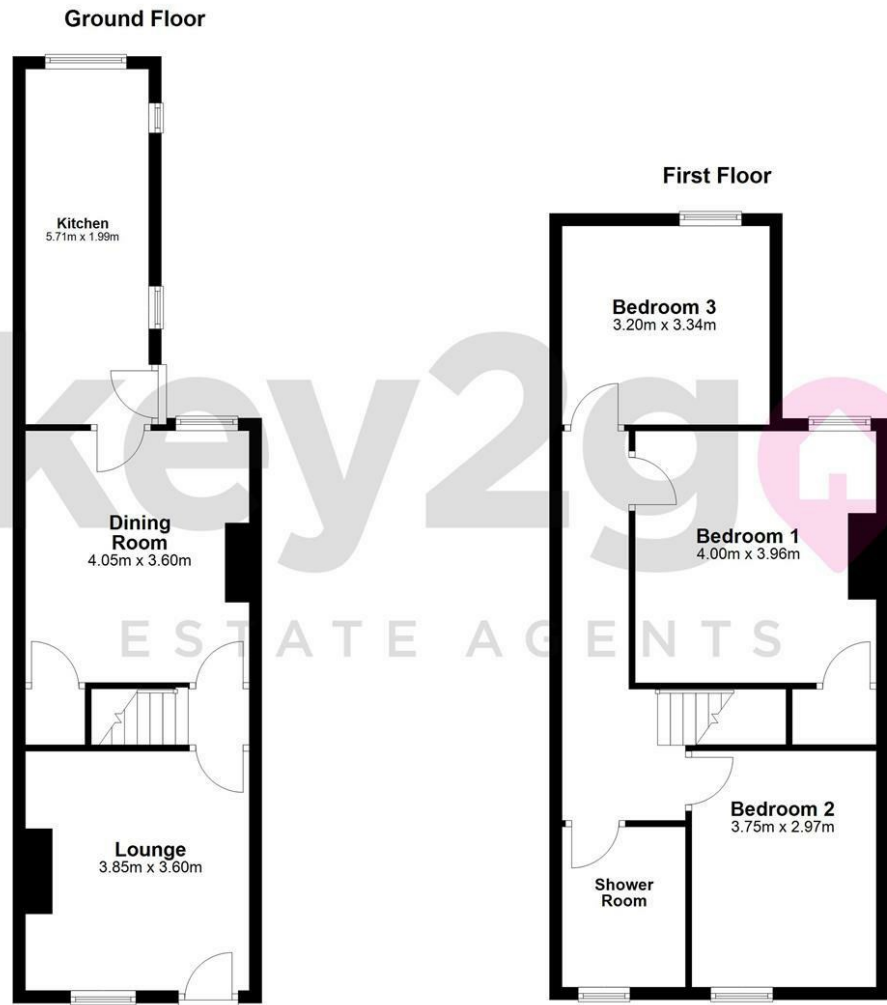

Area Map



Energy Efficiency Graph

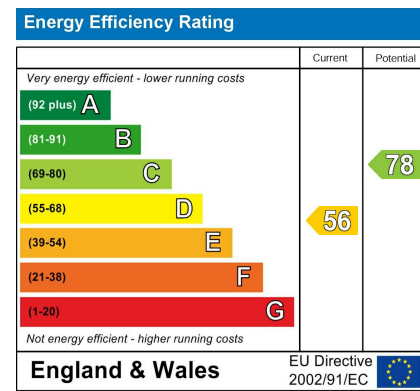

Viewing

Please contact our Lettings Team Office on 0114 2478819 if you wish to arrange a viewing appointment for this property or require further information.

These particulars, whilst believed to be accurate are set out as a general outline only for guidance and do not constitute any part of an offer or contract. Intending purchasers should not rely on them as statements of representation of fact, but must satisfy themselves by inspection or otherwise as to their accuracy. No person in this firm's employment has the authority to make or give any representation or warranty in respect of the property.



36 Limpsfield Road  
 Sheffield, S9 1BL

£900 PCM



# 36 Limpsfield Road

Sheffield, S9 1BL

£900 PCM



IDEAL FOR A SMALL FAMILY OR COUPLE! Arrange your viewing today for this modern, three bedroomed terrace house located in a popular residential area. Deceptively spacious, benefiting from two reception rooms and having a modern bathroom and kitchen. Within close proximity to Meadowhall and Sheffield Hospitals!

## SUMMARY

IDEAL FOR A SMALL FAMILY OR COUPLE! Arrange your viewing today for this modern, three bedroomed terrace house located in a popular residential area. Deceptively spacious, benefiting from two reception rooms and having a modern bathroom and kitchen. Within close proximity to Meadowhall and Sheffield Hospitals!

